

SERVO-DRIVE

12-Watt Blum plug-in transformer

www.blum.com



Memo



Technical details

The new 12-Watt Blum plug-in transformer replaces the existing 16-Watt Blum plug-in transformer (Z10NA20x).

All existing and new SERVO-DRIVE drive units and components are compatible with the new Blum plug-in transformer.



Certification

The Blum plug-in transformer meets Energy Star Level VI/EU directive CoC Level V Tier 2 standby consumption and efficiency requirements and is internationally certified.



Consumption

The 12-Watt Blum plug-in transformer reduces stand-by consumption by 50% compared to current levels.



The new generation

The new Blum plug-in transformer stands out thanks to its energy-saving technology with integrated overvoltage protection, which, together with optimal protection against dripping water in the sink area, ensures even higher levels of safety during use.

With each 12-Watt Blum plug-in transformer, an individual SERVO-DRIVE application can be implemented. In this way, it is easy to retrofit SERVO-DRIVE uno in the base cabinet, for AVENTOS or SERVO-DRIVE flex for refrigerators and dishwashers.

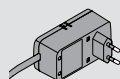

12-Watt Blum plug-in transformer

Nominal voltage	100-240 V
Operating power	24 V
Rated output	12 W

Z10NA30x