

TANDEMBOX sink pull-out

Optimal use of storage space under the sink

www.blum.com



Memo



A U-shaped pull-out enables the best possible use of space to the left and right of the sink, meaning frequently used items such as sponges, washing-up liquid and tabs are close at hand but don't have to be stored on the work surface. Combined with the SERVO-DRIVE or TIP-ON BLUMOTION opening support system, the pull-out opens with just a light touch on the front. This is especially practical if both of your hands are full or wet. Thanks to BLUMOTION, it always closes silently and effortlessly.

The sink pull-out is available now for all TANDEMBOX programme lines with standard components in combination with the new chipboard back fixing.

Component overview

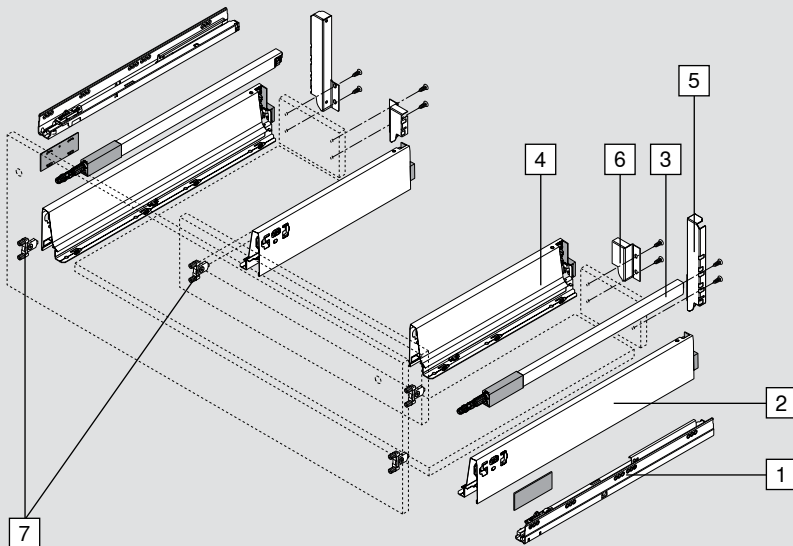

- 1 Cabinet profile
- 2 External drawer sides*
- 3 Longside gallery rail, left/right
- 4 Internal drawer sides*
- 5 External back fixing
- 6 Internal back fixing
- 7 Front fixing bracket

* NL external drawer side - NL internal drawer side = min. 150 (recommendation)

5 External back fixing

The Blum sink pull-out is compatible with the standard drawer sides, meaning that a special sink drawer side is no longer required.

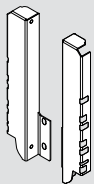

	SW	RAL9006	TS
	Silk white	Grey (white aluminium)	Terra black
	Steel		
Height C	Z30C000S.22		
Height D	Z30D000S.22		

Centre piece drilling distances

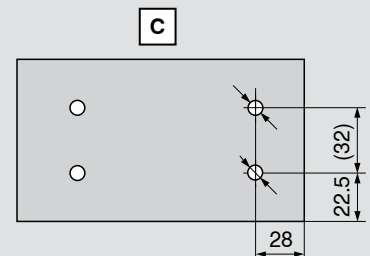

Cutting dimensions for 16 mm chipboard

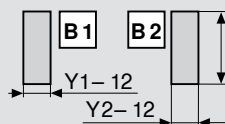

Back
84 mm

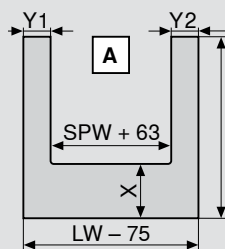

Drawer base
Chipboard back
NL - 24 mm

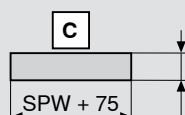

Centre piece
71 mm

X = NL of external drawer side - NL of internal drawer side - 10

Y min. = 48 mm

Y min. = 75 mm with TIP-ON BLUMOTION

Y max. = 225 mm

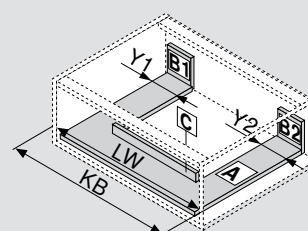

- KB** Cabinet width
- LW** Internal cabinet width
- NL** Nominal length
- SPW** Internal width between sink drawer sides