



TANDEMBOX antaro

Clear-cut and rectangular

Mutual trust develops and grows

A reliable product, bespoke services, stringent quality standards, award-winning design and consistent development – these are the foundations of a successful partnership.

Proven a million times over, TANDEMBOX antaro fits the bill in every way, and has done so for decades. Our double walled box system is not only an unrivalled technological success; it is also a milestone in our corporate history. The trust you place in our product confirms that we are on the right track. We have further developed TANDEMBOX antaro and streamlined the range. This means you need less warehouse space and can further improve inventory efficiency.

Inspire your customers with our box system and rest assured that we will not stand still. We are always looking to drive innovation and enhance established products.



Contents

04	Technology
06	Design
08	Colours
10	Range
12	Assembly and manufacturing
14	SERVICES
16	Applications
40	Ordering and planning information
70	moving ideas





Proven a million times over – TANDEMBOX cabinet profile

All TANDEMBOX antaro applications are based on the tried and tested TANDEMBOX cabinet profile. Its feather-light glide has impressed users for decades. Low-friction cylindrical nylon rollers are designed to withstand loads of 30 and 65 kg and deliver top quality motion for the lifetime of the furniture. This promise is guaranteed by rigorous quality controls that go beyond legal requirements and international standards.

Opening and closing ease

Motion technologies by Blum ensure top quality motion and ease of use day in, day out. Be it mechanical or electrical – drawers and pull-outs equipped with Blum motion support systems seem to open and close by themselves.



mechanical
soft close



electrical
opening &
soft close



mechanical
opening &
soft close





Timeless – Rectangular design

TANDEMBOX antaro is characterized by its clear-cut design and rectangular gallery. This means you can carry minimalist design through to pull-outs and drawer sides.

An orange line starts from a small circle on the right, extends horizontally to the left, and then turns 90 degrees downward to point at the bevelled top edge of the drawer side.

The bevelled top edge of the drawer side (A design) continues the linear look of the rectangular gallery.

Harmonious – Two colours, one style

The minimalist design of TANDEMBOX antaro is based on clean lines and a sleek colour scheme. All nylon components are colour coordinated with the drawer sides. The colour range includes two options in steel: silk white and white aluminium.







**Multifaceted –
One solution,
countless options**



TANDEMBOX antaro gives you an entire range of pull-outs and drawers to choose from. Be it in the kitchen, bathroom or living area – TANDEMBOX antaro offers the right solution for any application.

Drawer sides also come in different heights, making it easy to turn customers' wishes into reality.

Nominal lengths 270 – 650 mm

Cabinet widths 275 – 1200 mm

Drawer side heights N (68.5 mm)
M (83.6 mm)

Basic components

Drawer side height | Back height

N		
M	C	D

Fast and straightforward – Assembly devices

Our goal is to provide you with the best possible service. This includes support with the manufacture of our products.

Practical assembly devices tailored to your production requirements optimize the assembly of Blum box systems. This also applies to smaller production runs.



You will find our assembly devices here:
www.blum/jigs

With BOXFIX plus, TANDEMBOX antaro components are pneumatically clamped and then screwed together quickly and efficiently. Easy setup and pre-set stops save time and improve assembly quality.



Simple and tool free – Assembly



Thanks to tried and tested INSERTA technology, the gallery and front can be assembled without tools.



The gallery rail can be quickly clipped onto the back.



Simple tilt adjustment allows you to align gaps in no time.



Creating TANDEMBOX antaro couldn't be easier!



Watch assembly video:
www.blum.com/172HZO

Useful and available 24/7 – Our services

Good services are there when you need them. As a trusted partner, we not only offer practical assembly devices but also provide services tailored to your production needs. Let us help you transform your ideas into fine furniture.



Marketing

Marketing Media Library

Use our high-resolution images, videos and brochures for your promotion campaigns and gain inspiration – completely free of charge and around the clock.

Concept and planning, quotation

Product and Cabinet Configurator

Plan, configure and save your projects online with ease – with our free Product and Cabinet Configurator. Create up-to-date parts lists for your offers to customers.

Design

CAD/CAM Data Service

Our CAD/CAM Data Service provides comprehensive data for your software. You will find an overview of our interface partners on our homepage.

Ordering

Distributor interface

Transfer the parts list produced by our Product and Cabinet Configurator directly to the online shops of selected distributors and simply save your projects under “My projects”.



Manufacturing

MINIPRESS with EASYSTICK

Our configurators provide you with production drawings or the BXF format so that you can transfer your planning results to MINIPRESS with EASYSTICK. We also offer templates and assembly devices to support you with manufacturing.

Delivery and installation

EASY ASSEMBLY app

Use our EASY ASSEMBLY app to install and adjust our fittings quickly and efficiently. The app contains assembly instructions and videos for all our products.

After sales service

Personal consultation

We provide personal after-sale support. Your contact at Blum will be happy to answer any questions you might have about our products and services.



High fronted pull-out
height C with gallery



Drawer height N



High fronted pull-out height D with
gallery

Organization and visibility – Inner dividing system

ORGA-LINE

The high-quality inner dividing system works wonders on the interiors of drawers and high fronted pull-outs. Whether chopping boards, cutlery, bottles or pots and pans, all items are held securely and immediately to hand. Give yourself clear visibility and tailor your storage space to your needs.



Our range at a glance:
www.blum.com/orgaline1









SPACE TWIN

Top: Drawer height M

Bottom: High fronted pull-out height D with gallery



High fronted pull-out height C with gallery



High fronted pull-out height D with gallery



Sink pull-out height C with gallery



Drawer and inner drawer height M



High fronted pull-out height C with gallery

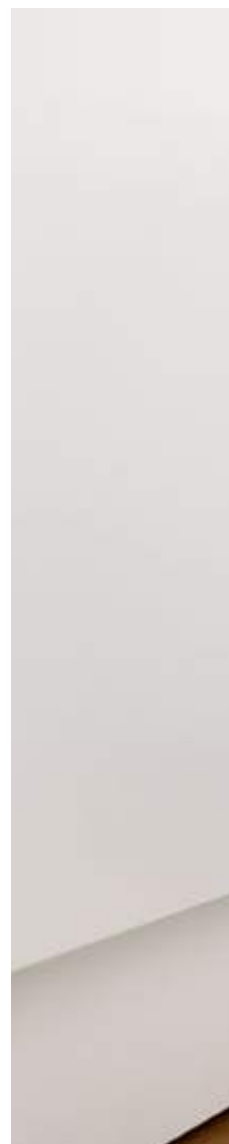



Extra storage – One system, multiple solutions

TANDEMBOX antaro allows you to implement clever cabinet solutions that provide practical storage space. SPACE STEP, for example, creates additional storage in the cabinet toe kick and makes it easier to reach items in wall cabinets. SPACE TWIN and the U-shaped sink pull-out make full use of every inch of space available. And the SPACE TOWER pantry unit provides ample space and easy accessibility to all storage items.





SPACE TOWER – Pantry unit

The ultimate solution for pantry units: ample storage space, inner pull-outs that can be tailored to your storage space needs and access to items from all three sides. This is the convenient and ergonomic way to store provisions. Thanks to full extension, you have easy access to all contents from the left, right and even from the front.



Inner pull-out height C



Inner pull-out height D



SPACE TOWER comes in all heights, widths and depths. In other words, it can be tailored to your personal storage space requirements.

SPACE STEP – Toe kick solution

Nice and high

You have to use every inch of space in compact homes. SPACE STEP allows you to use the space right up to the ceiling. The new toe kick solution gives users easy access to the top shelves of wall cabinets.





Find out more about SPACE STEP here:
www.blum.com/spacestep

Nice and practical

You need the right furniture for customers who want to store lots of things. SPACE STEP not only allows you to use higher cabinets, but also creates extra storage space in the toe kick of base units. Two solutions rolled into one.





Sink cabinet – Don't waste an inch of space

Organize your under-sink space

The U-shaped pull-out puts the space to the left and right of the sink to best possible use. It's ideal for clearing away sponges, washing-up liquid and tabs. This pull-out is recommended for cabinet widths of 900 mm or more.

Extra storage space

An additional inner pull-out provides plenty of space for cleaning utensils such as sponges, cleaning cloths and bin liners.

Nice and clean

The full extension makes it easy to throw away waste, empty and clean waste bins. Practical inner dividing systems such as ORGA-LINE ensure that cleaning products are held securely.

SPACE TWIN – Narrow cabinets

A practical solution for small storage spaces

Narrow cabinets turn tiny kitchen spaces into valuable storage. Blum's SPACE TWIN with diagonally offset runners creates additional storage space – without compromising stability or quality of motion. This is the ideal place to keep narrow items such as bottles, chopping boards, spices and baking trays.



Find out more about SPACE TWIN here:

www.blum.com/spacetwin

**TANDEMBOX also
looks good in the
bathroom**



High fronted pull-out height C with gallery





High fronted pull-out height C with gallery



Inner pull-out height C with gallery

Drawer



Height N
82.5 mm

42



Height M
98.5 mm

44

Inner drawer



Height M
106 mm

46

High fronted pull-out



Height C
192 mm

48



Height D
224 mm

52

Inner pull-out



Height C
192 mm

50



Height D
224 mm

54

Sink pull-out



Height C
192 mm

56



Height D
224 mm

58

TIP-ON BLUMOTION

60

Cabinet profile fixing

66

Flexible gallery fixing

68

Front/base stabiliser

69

Colour

SW

Silk white

R9006

RAL 9006 grey (white aluminium)

WGR

White grey

R7037

RAL 7037 dust grey

Product



Description

- Concealed, guided full extension
- Tool-free front assembly
- 2-dimensional front adjustment
- With integrated BLUMOTION, can be combined with SERVO-DRIVE or with TIP-ON BLUMOTION

Space requirement

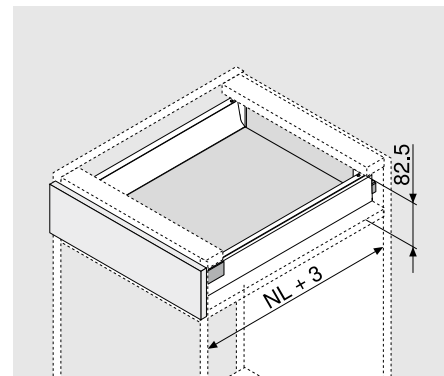

NL Nominal length

Ordering information

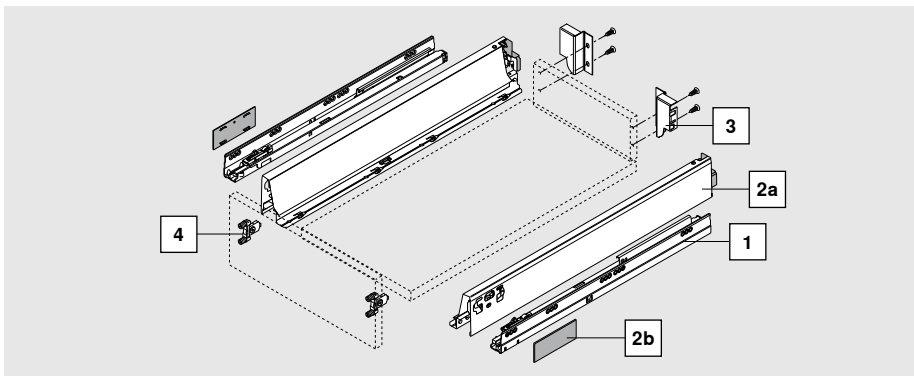

1	Cabinet profiles left/right	
	Dynamic carrying capacity (kg)	BLUMOTION*
	Nominal length (mm)	30 kg
	400	578.4001M
	450	578.4501M
	500	578.5001M
	550	578.5501M

*Suitable for SERVO-DRIVE and TIP-ON BLUMOTION

2	Drawer side set	
	Colour options	SW R9006
	NL (mm)	Steel
	400	378N4002SA
	450	378N4502SA
	500	378N5002SA
	550	378N5502SA

Consisting of:

2a	1 x drawer side left/right
2b	2 x cover cap, stamped with Blum logo, custom printed from 1000 pcs

Ordering information

3 	Back fixing left/right		
	Colour options	SW	R9006
		Steel	
		Z30N000S.04	

4 	Front fixing bracket		
	INSERTA version	2x	ZSF.39A2
	Screw-on version	2x	ZSF.35A2

Planning

Space requirements in the cabinet	Front installation dimensions	Drilling distances – front – INSERTA	Back installation dimensions
	<p>FA Front overlay</p>		

Cutting dimensions for 16 mm chipboard	
<p>Drawer back 69 mm</p> <p>LW - 87 mm</p> <p>Base Chipboard back NL - 24 mm Steel back NL - 22 mm</p> <p>LW - 75 mm</p>	<p>KB Cabinet width LW Internal cabinet width NL Nominal length</p>

Product



Description

- Concealed, guided full extension
- Tool-free front assembly
- 2-dimensional front adjustment
- With integrated BLUMOTION, can be combined with SERVO-DRIVE or with TIP-ON BLUMOTION

Space requirement

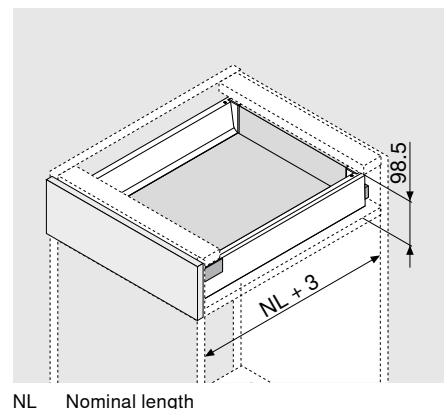

Ordering information

1	Cabinet profiles left/right		
	Dynamic carrying capacity (kg)		
	Nominal length NL (mm)	BLUMOTION*	
		30 kg	65 kg
	270	578.2701M	
	350	578.3501M	
	400	578.4001M	
	450	578.4501M	576.4501M
	500	578.5001M	576.5001M
	550	578.5501M	576.5501M
	600		576.6001M
	650		576.6501M
*Suitable for SERVO-DRIVE and TIP-ON BLUMOTION			

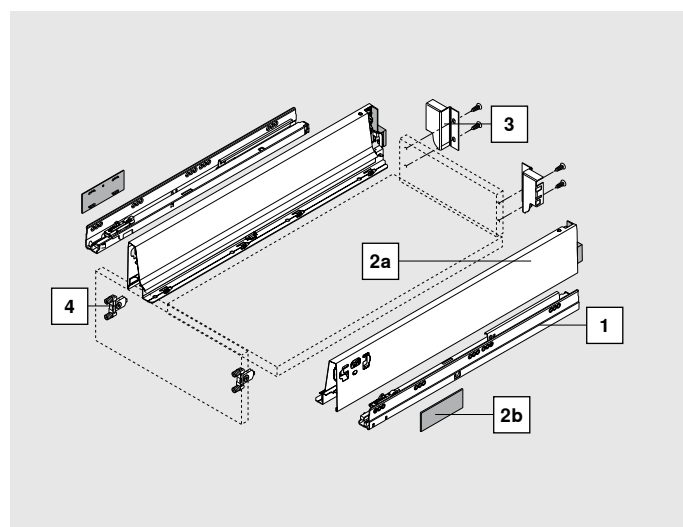

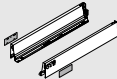
2	Drawer side set		
	Colour options	SW	R9006
	NL (mm)	Steel	
	270	378M2702SA	
	350	378M3502SA	
	400	378M4002SA	
	450	378M4502SA	
	500	378M5002SA	
	550	378M5502SA	
	600	378M6002SA	
	650	378M6502SA	
Consisting of:			
2a	1 x drawer side left/right		
2b	2 x cover cap, stamped with Blum logo, custom printed from 1000 pcs		

Ordering information

<div>3</div>	Back fixing left/right		
	Colour options	SW	R9006
		Steel	
		Z30M000S.04	

<div>4</div>	Front fixing bracket		
	INSERTA version	2x	ZSF.39A2
	Screw-on version	2x	ZSF.35A2

Planning

Space requirements in the cabinet

Front installation dimensions

FA Front overlay

Drilling distances – front – INSERTA

Back installation dimensions

Cutting dimensions for 16 mm chipboard

B

Drawer back

84 mm

LW - 87 mm

A

Base

Chipboard back

NL - 24 mm

Steel back

NL - 22 mm

LW - 75 mm

KB Cabinet width

LW Internal cabinet width

NL Nominal length

Product



Description

- Concealed, guided full extension
- Tool-free front assembly
- With integrated BLUMOTION, can be combined with SERVO-DRIVE or with TIP-ON BLUMOTION
- Inner drawers either with handle or handle and latch

Space requirement

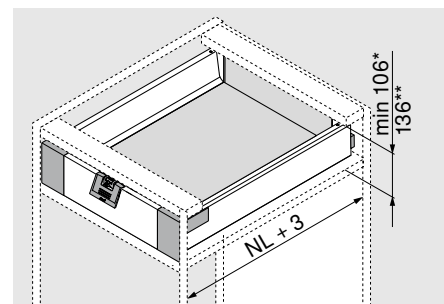

- NL Nominal length
 * Min. space requirement for inner drawers with or without handles
 ** Inner drawers with easy access from above

Ordering information

1	Cabinet profiles left/right		
	Dynamic carrying capacity (kg)		
	Nominal length NL (mm)	BLUMOTION*	
		30 kg	65 kg
	270	578.2701M	
	350	578.3501M	
	400	578.4001M	
	450	578.4501M	576.4501M
	500	578.5001M	576.5001M
	550	578.5501M	576.5501M
	600		576.6001M
	650		576.6501M
*Suitable for SERVO-DRIVE and TIP-ON BLUMOTION			

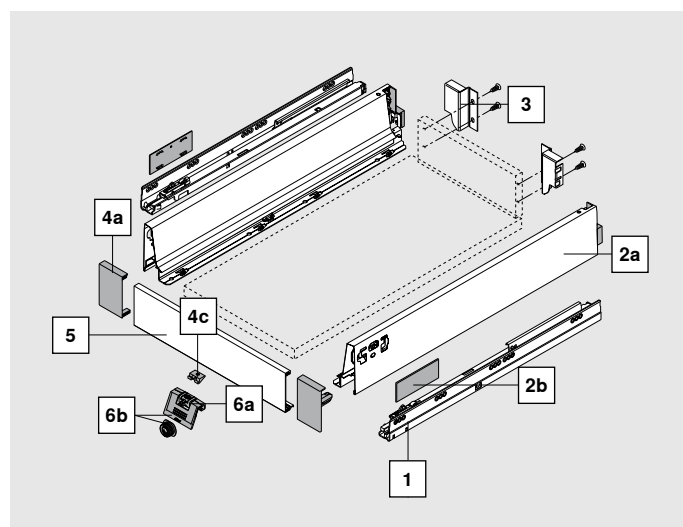

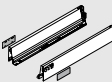
2	Drawer side set		
	Colour options	SW	R9006
	NL (mm)	Steel	
	270	378M2702SA	
	350	378M3502SA	
	400	378M4002SA	
	450	378M4502SA	
	500	378M5002SA	
	550	378M5502SA	
	600	378M6002SA	
	650	378M6502SA	
Consisting of:			
2a	1 x drawer side left/right		
2b	2 x cover cap, stamped with Blum logo, custom printed from 1000 pcs		

Ordering information

3	Back fixing left/right		
	Colour options	SW	R9006
	Steel	Z30M000S.04	

4	Front fixing left/right		
	Colour options	SW	WGR
	Nylon	ZIF.71M0	

Consisting of:

4a	1 x front fixing left/right
4c	1 x locking piece

5	Front piece		
	Colour options	SW	R9006
	Aluminium	Z31L1036A	

6a	Handle		
	Colour options	SW	WGR R7037
	Nylon	ZIF.80M5	

6b	Handle		
	Colour options	SW/R7037	WGR/R7037 R7037
	Nylon	ZIF.80M7	

Planning

Space requirements in the cabinet

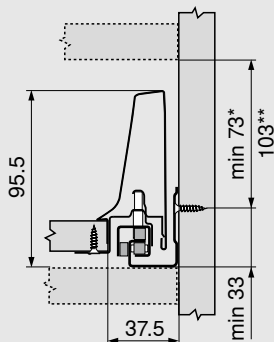

- * Min. space requirement for inner drawers with or without handles
Without a handle, opening is only possible from the bottom
- ** Inner drawers with easy access from above

Front drilling distances for latch

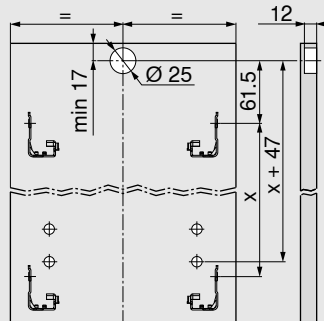

Back installation dimensions

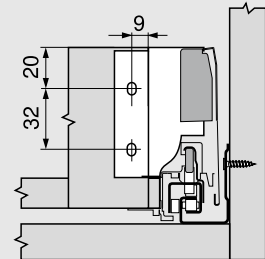

Cutting dimensions for 16 mm chipboard

B	Drawer back
	84 mm
A	Base
	Chipboard back
A	NL - 24 mm
	Steel back
A	NL - 22 mm
	LW - 75 mm

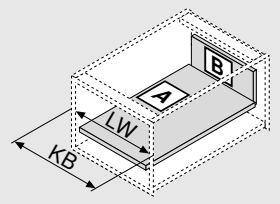

KB	Cabinet width
LW	Internal cabinet width
NL	Nominal length

Front piece for cutting to size

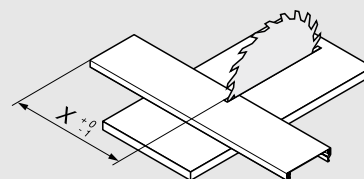

$$x = LW - 132$$

Product



Description

- With single gallery
- Concealed, guided full extension
- Tool-free front assembly
- 3-dimensional front adjustment
- With integrated BLUMOTION, can be combined with SERVO-DRIVE or with TIP-ON BLUMOTION

Space requirement

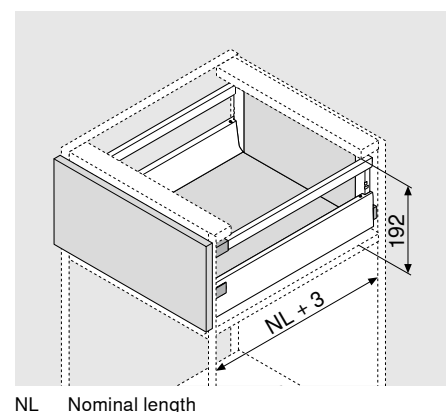

Ordering information

1	Cabinet profiles left/right		
	Dynamic carrying capacity (kg)		
	Nominal length NL (mm)	BLUMOTION*	
		30 kg	65 kg
	270	578.2701M	
	350	578.3501M	
	400	578.4001M	
	450	578.4501M	576.4501M
	500	578.5001M	576.5001M
	550	578.5501M	576.5501M
	600		576.6001M
	650		576.6501M
*Suitable for SERVO-DRIVE and TIP-ON BLUMOTION			

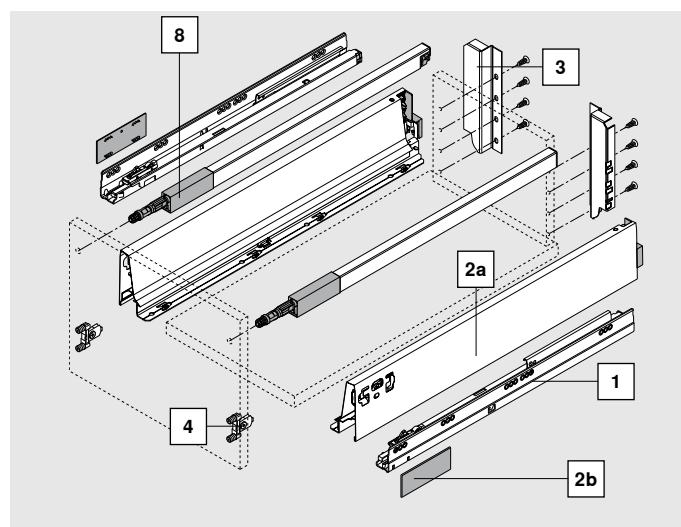

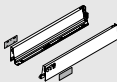
2	Drawer side set		
	Colour options	SW	R9006
	NL (mm)	Steel	
	270	378M2702SA	
	350	378M3502SA	
	400	378M4002SA	
	450	378M4502SA	
	500	378M5002SA	
	550	378M5502SA	
	600	378M6002SA	
	650	378M6502SA	
Consisting of:			
2a	1 x drawer side left/right		
2b	2 x cover cap, stamped with Blum logo, custom printed from 1000 pcs		

Ordering information

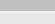
3	Back fixing left/right		
	Colour options	SW	R9006
	Steel	Z30C000S	

4	Front fixing bracket		
	INSERTA version	2x	ZSF.39A2
	Screw-on version	2x	ZSF.35A2

8	Gallery left/right		
	Colour options	SW	R9006
	NL (mm)	Steel	
	270	ZRG.207RSIC	
	350	ZRG.287RSIC	
	400	ZRG.337RSIC	
	450	ZRG.387RSIC	
	500	ZRG.437RSIC	
	550	ZRG.487RSIC	
	600	ZRG.537RSIC	
	650	ZRG.587RSIC	

Planning

Space requirements in the cabinet	Front installation dimensions	Drilling distances – front – INSERTA	Back installation dimensions
	FA Front overlay		

Cutting dimensions for 16 mm chipboard	
	Drawer back 167 mm LW - 87 mm
	Base Chipboard back NL - 24 mm Steel back NL - 22 mm LW - 75 mm
KB Cabinet width LW Internal cabinet width NL Nominal length	

Product



Description

- With single gallery
- Concealed, guided full extension
- Tool-free front assembly
- 3-dimensional front adjustment
- With integrated BLUMOTION, can be combined with SERVO-DRIVE or with TIP-ON BLUMOTION

Space requirement

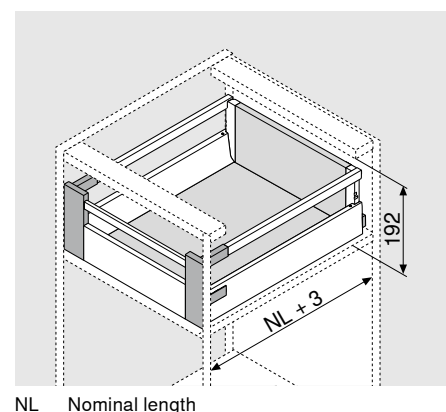

Ordering information

1	Cabinet profiles left/right		
	Dynamic carrying capacity (kg)		
	Nominal length NL (mm)	BLUMOTION*	
		30 kg	65 kg
	270	578.2701M	
	350	578.3501M	
	400	578.4001M	
	450	578.4501M	576.4501M
	500	578.5001M	576.5001M
	550	578.5501M	576.5501M
	600		576.6001M
	650		576.6501M
*Suitable for SERVO-DRIVE and TIP-ON BLUMOTION			

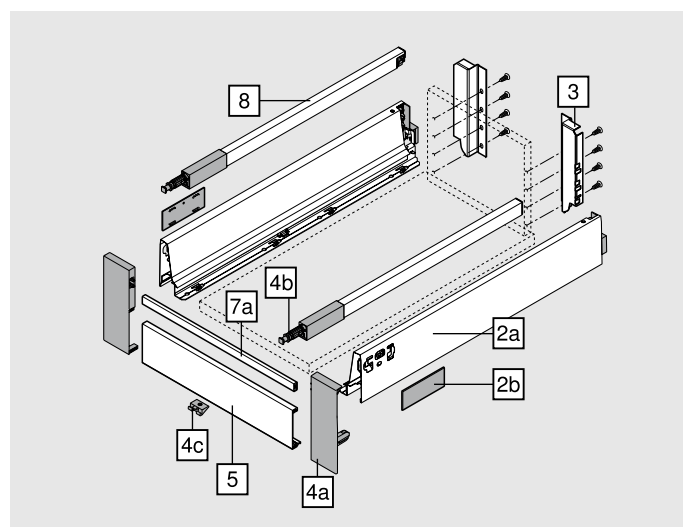

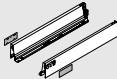
2	Drawer side set		
	Colour options	SW	R9006
	NL (mm)	Steel	
	270	378M2702SA	
	350	378M3502SA	
	400	378M4002SA	
	450	378M4502SA	
	500	378M5002SA	
	550	378M5502SA	
	600	378M6002SA	
	650	378M6502SA	
Consisting of:			
2a	1 x drawer side left/right		
2b	2 x cover cap, stamped with Blum logo, custom printed from 1000 pcs		

Ordering information

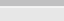
<div>3</div> <div></div>	Back fixing left/right		
	Colour options	SW	R9006
	Steel	Z30.C000S	

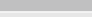
7a	Cross gallery		
	Colour options	SW	R9006
	Aluminium	ZRG.1046Z	
	For cutting to size		

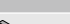
4	Front fixing left/right		
	Colour options	SW	WGR
	Nylon		
			ZIF.74C0

Consisting of:

4a	1 x front fixing left/right
4b	2 x gallery head
4c	1 x locking piece

8	Gallery left/right		
	Colour options	SW	R9006
	NL (mm)	Steel	
	270	ZRG.207RSIC	
	350	ZRG.287RSIC	
	400	ZRG.337RSIC	
	450	ZRG.387RSIC	
	500	ZRG.437RSIC	
	550	ZRG.487RSIC	
	600	ZRG.537RSIC	
	650	ZRG.587RSIC	

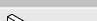
5	Front piece		
	Colour options	SW	R9006
	Aluminium	Z31L1036A	
	For cutting to size		

Planning

Space requirements in the cabinet 		Back installation dimensions 	Cutting dimensions for 16 mm chipboard 	<p>KB Cabinet width LW Internal cabinet width NL Nominal length</p>
--	--	---	---	---

Front piece for cutting to size <p>$x = LW - 132$</p>	Cross gallery for cutting to size <p>$x = LW - 122$</p>
--	--

Product



Description

- With single gallery
- Concealed, guided full extension
- Tool-free front assembly
- 3-dimensional front adjustment
- With integrated BLUMOTION, can be combined with SERVO-DRIVE or with TIP-ON BLUMOTION

Space requirement

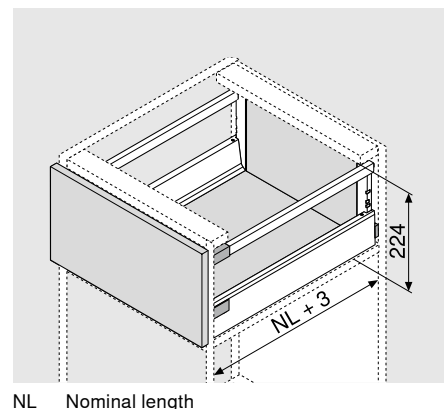

NL Nominal length

Ordering information

1	Cabinet profiles left/right		
	Dynamic carrying capacity (kg)		
	Nominal length NL (mm)	BLUMOTION*	
		30 kg	65 kg
	270	578.2701M	
	350	578.3501M	
	400	578.4001M	
	450	578.4501M	576.4501M
	500	578.5001M	576.5001M
	550	578.5501M	576.5501M
	600		576.6001M
	650		576.6501M
*Suitable for SERVO-DRIVE and TIP-ON BLUMOTION			

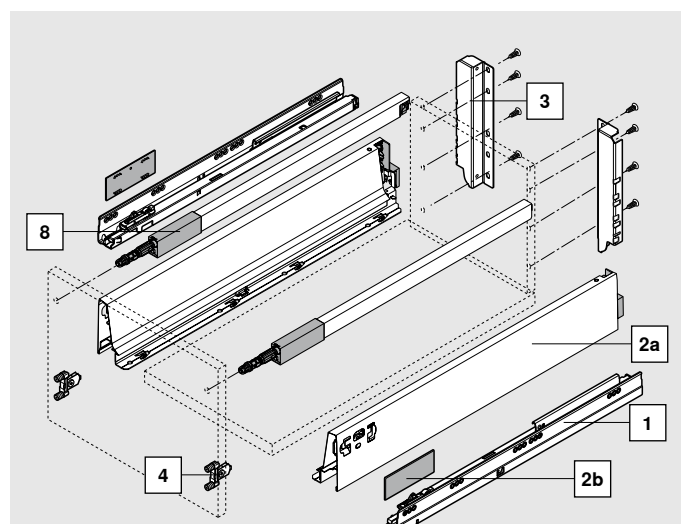

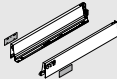
2	Drawer side set		
	Colour options	SW	R9006
	NL (mm)	Steel	
	270	378M2702SA	
	350	378M3502SA	
	400	378M4002SA	
	450	378M4502SA	
	500	378M5002SA	
	550	378M5502SA	
	600	378M6002SA	
	650	378M6502SA	
Consisting of:			
2a	1 x drawer side left/right		
2b	2 x cover cap, stamped with Blum logo, custom printed from 1000 pcs		

Ordering information

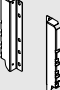
3 	Back fixing left/right		
	Colour options	SW	R9006
	Steel	Z30D000SL	

4 	Front fixing bracket		
	INSERTA version	2x	ZSF.39A2
	Screw-on version	2x	ZSF.35A2

8 	Gallery left/right		
	Colour options	SW	R9006
	NL (mm)	Steel	
	270	ZRG.207RSIC	
	350	ZRG.287RSIC	
	400	ZRG.337RSIC	
	450	ZRG.387RSIC	
	500	ZRG.437RSIC	
	550	ZRG.487RSIC	
	600	ZRG.537RSIC	
	650	ZRG.587RSIC	

Planning

Space requirements in the cabinet	Front installation dimensions	Drilling distances – front – INSERTA	Back installation dimensions
	<p>FA Front overlay</p>		

Cutting dimensions for 16 mm chipboard	
Drawer back 199 mm LW - 87 mm	KB Cabinet width LW Internal cabinet width NL Nominal length
Base Chipboard back NL - 24 mm Steel back NL - 22 mm LW - 75 mm	

Product



Description

- With single gallery
- Concealed, guided full extension
- Tool-free front assembly
- 3-dimensional front adjustment
- With integrated BLUMOTION, can be combined with SERVO-DRIVE or with TIP-ON BLUMOTION

Space requirement

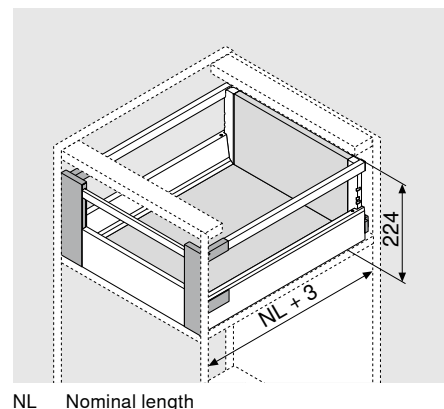

Ordering information

1	Cabinet profiles left/right		
	Dynamic carrying capacity (kg)		
	Nominal length NL (mm)	BLUMOTION*	
		30 kg	65 kg
	270	578.2701M	
	350	578.3501M	
	400	578.4001M	
	450	578.4501M	576.4501M
	500	578.5001M	576.5001M
	550	578.5501M	576.5501M
	600		576.6001M
	650		576.6501M
*Suitable for SERVO-DRIVE and TIP-ON BLUMOTION			

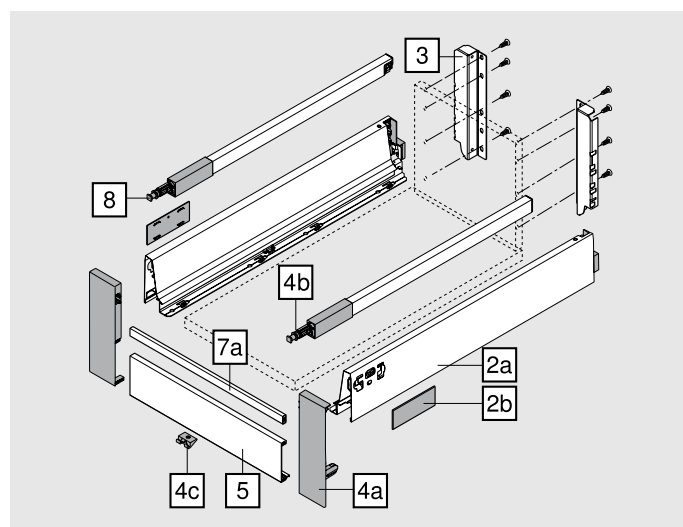

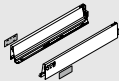
2	Drawer side set		
	Colour options	SW	R9006
	NL (mm)	Steel	
	270	378M2702SA	
	350	378M3502SA	
	400	378M4002SA	
	450	378M4502SA	
	500	378M5002SA	
	550	378M5502SA	
	600	378M6002SA	
	650	378M6502SA	
Consisting of:			
2a	1 x drawer side left/right		
2b	2 x cover cap, stamped with Blum logo, custom printed from 1000 pcs		

Ordering information

	3 Back fixing left/right		
	Colour options	SW	R9006
	Steel	Z30D000SL	

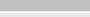
7a	Cross gallery		
	Colour options	SW	R9006
	Aluminium	ZRG.1046Z	
	For cutting to size		

	4 Front fixing left/right		
	Colour options	SW	WGR
	Nylon	ZIF.74D0	

Consisting of:

4a	1 x front fixing left/right
4b	2 x gallery head
4c	1 x locking piece

	8 Gallery left/right		
	Colour options	SW	R9006
	NL (mm)	Steel	
	270	ZRG.207RSIC	
	350	ZRG.287RSIC	
	400	ZRG.337RSIC	
	450	ZRG.387RSIC	
	500	ZRG.437RSIC	
	550	ZRG.487RSIC	
	600	ZRG.537RSIC	
	650	ZRG.587RSIC	

5	Front piece		
	Colour options	SW	R9006
	Aluminium	Z31L1036A	
	For cutting to size		

Planning

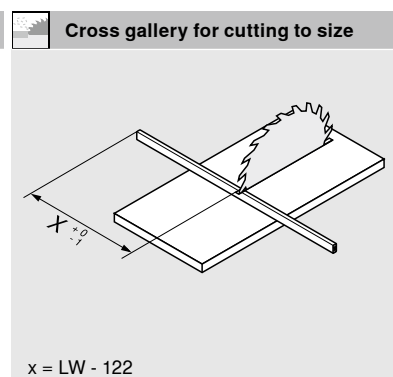
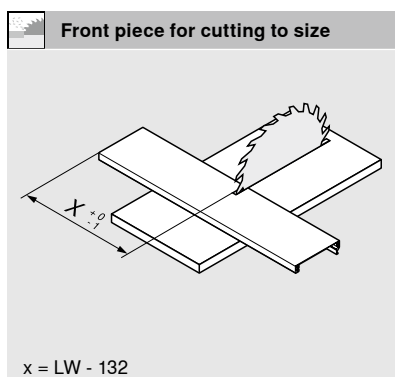
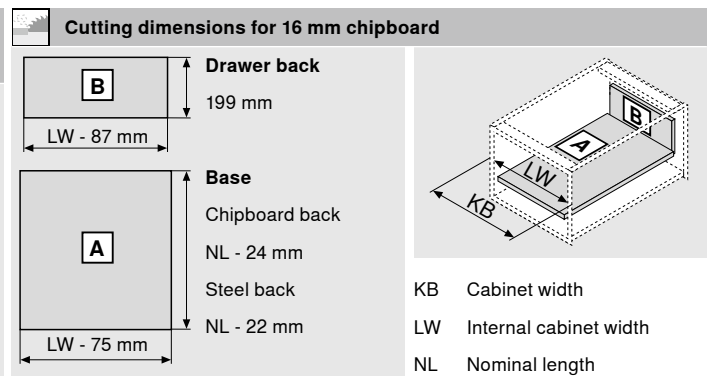
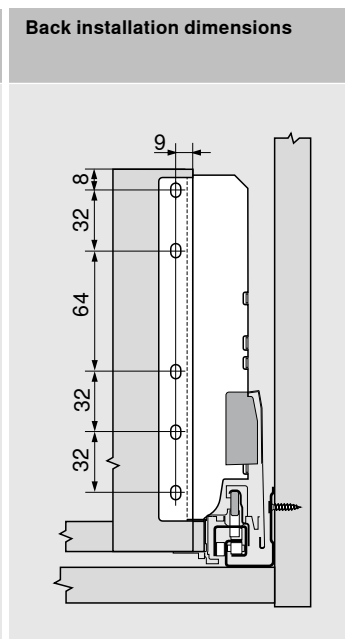
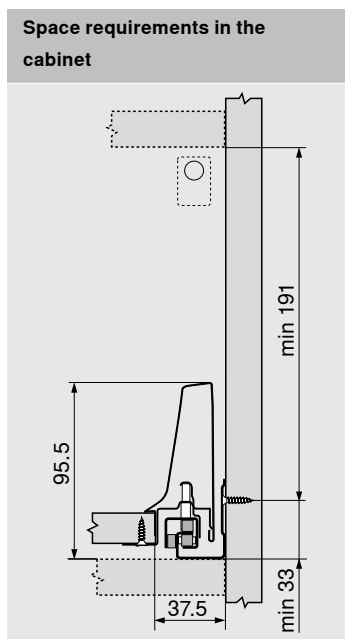

Product



Description

- Can be implemented with standard components
- With single gallery
- Concealed, guided full extension
- Tool-free front assembly
- 3-dimensional front adjustment
- With integrated BLUMOTION, can be combined with SERVO-DRIVE or with TIP-ON BLUMOTION

Space requirement

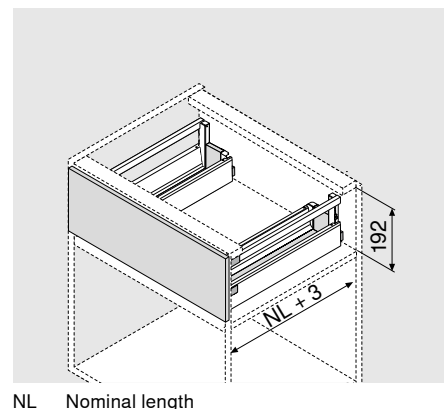

NL Nominal length

Ordering information

1	Cabinet profiles left/right		
	Dynamic carrying capacity (kg)		
	Nominal length NL (mm)	BLUMOTION*	
		30 kg	65 kg
	270	578.2701M	
	350	578.3501M	
	400	578.4001M	
	450	578.4501M	576.4501M
	500	578.5001M	576.5001M
	550	578.5501M	576.5501M
	600		576.6001M
	650		576.6501M
*Suitable for SERVO-DRIVE and TIP-ON BLUMOTION			

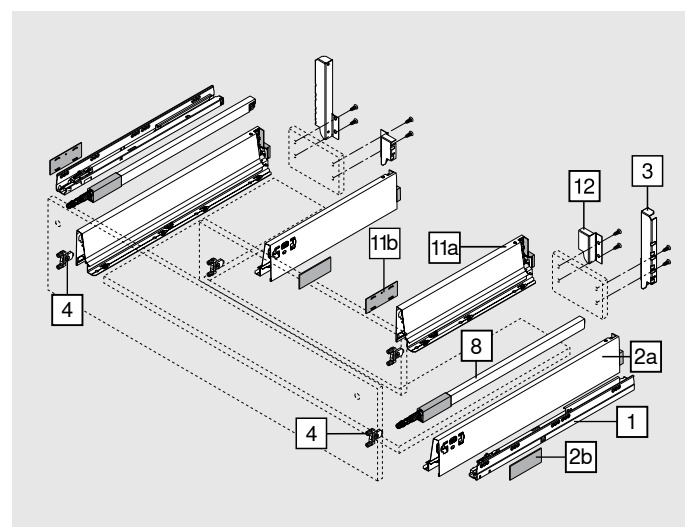

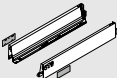
2	Outer drawer side set		
	Colour options	SW	R9006
	NL (mm)	Steel	
	450	378M4502SA	
	500	378M5002SA	
	550	378M5502SA	
	600	378M6002SA	
	650	378M6502SA	
Consisting of:			
2a	1 x drawer side left/right		
2b	2 x cover cap, stamped with Blum logo, custom printed from 1000 pcs		

4	Front fixing bracket		
	INSERTA version	4x	ZSF.39A2
	Screw-on version	4x	ZSF.35A2

12	Back fixing left/right		
	Colour options	SW	R9006
	Steel	Z30M000S.04	

	Front/base stabiliser		
	Stabilises wide and high fronts. Reinforces the connection between the drawer side and the front.		
	Z96.10E1		
	Planning		81

3	Back fixing left/right		
	Colour options	SW	R9006
	Steel	Z30C000S.22	

Ordering information

8	Gallery left/right		
	Colour options	SW	WGR
	NL (mm)	Steel	
	270	ZRG.207RSIC	
	350	ZRG.287RSIC	
	400	ZRG.337RSIC	
	450	ZRG.387RSIC	
	500	ZRG.437RSIC	
	550	ZRG.487RSIC	
	600	ZRG.537RSIC	
	650	ZRG.587RSIC	

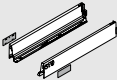
	Inner drawer side set		
	Colour options	SW	R9006
	NL (mm)	Steel	
	270	378M270SA	
	350	378M350SA	
	400	378M400SA	
	450	378M450SA	
	500	378M500SA	
Consisting of:			
2a	1 x drawer side left/right		
2b	2 x cover cap, stamped with Blum logo, custom printed from 1000 pcs		
For effective use of storage space, we recommend: Nominal length NL of outer drawer side (no 2) - nominal length NL of inner drawer side (no 11) = min. 150 mm			

Planning

Space requirements in the cabinet	Front installation dimensions	Drilling distances – front – INSERTA	Back installation dimensions
	<p>FA Front overlay</p>		

Cutting dimensions for 16 mm chipboard

	<p>Drawer back 84 mm</p> <p>Drawer base Chipboard back NL - 24 mm</p> <p>Centre piece 71 mm</p>
<p>Y min. BLUMOTION = 48 mm</p> <p>Y min. TIP-ON BLUMOTION = 75 mm</p> <p>Y max. = 225 mm</p>	

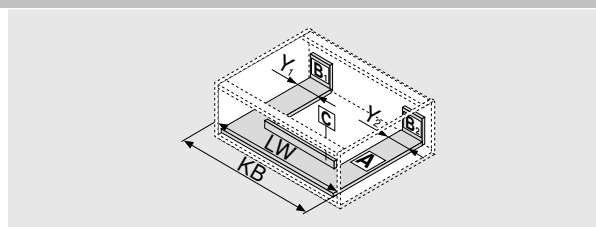

KB Cabinet width
LW Internal cabinet width
NL Nominal length
SPW Internal width between sink drawer sides

$X = NL \text{ outer drawer side} - NL \text{ inner drawer side} - 10 \text{ mm}$

Drilling distances – centre piece

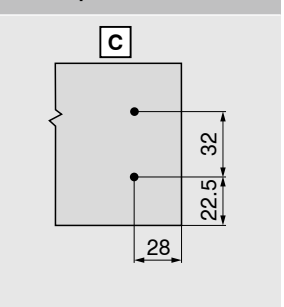

Product



Description

- With single gallery
- Concealed, guided full extension
- Tool-free front assembly
- 3-dimensional front adjustment
- With integrated BLUMOTION, can be combined with SERVO-DRIVE or with TIP-ON BLUMOTION

Space requirement

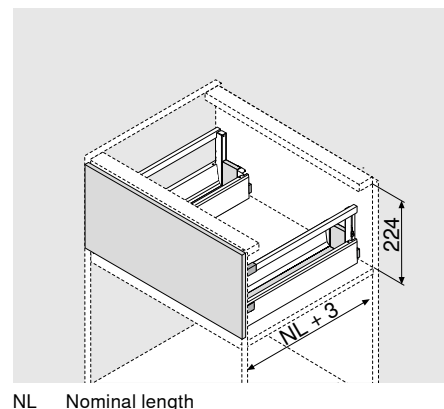

NL Nominal length

Ordering information

1	Cabinet profiles left/right		
	Dynamic carrying capacity (kg)		
	Nominal length NL (mm)	BLUMOTION*	
		30 kg	65 kg
	270	578.2701M	
	350	578.3501M	
	400	578.4001M	
	450	578.4501M	576.4501M
	500	578.5001M	576.5001M
	550	578.5501M	576.5501M
	600		576.6001M
	650		576.6501M
*Suitable for SERVO-DRIVE and TIP-ON BLUMOTION			

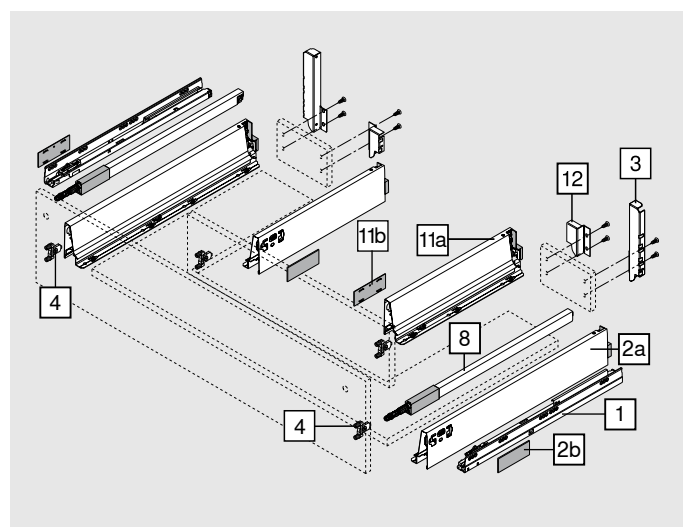

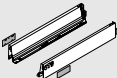
2	Outer drawer side set		
	Colour options	SW	R9006
	NL (mm)	Steel	
	450	378M4502SA	
	500	378M5002SA	
	550	378M5502SA	
	600	378M6002SA	
	650	378M6502SA	
Consisting of:			
2a	1 x drawer side left/right		
2b	2 x cover cap, stamped with Blum logo, custom printed from 1000 pcs		

4	Front fixing bracket		
	INSERTA version	4x	ZSF.39A2
	Screw-on version	4x	ZSF.35A2

12	Back fixing left/right		
	Colour options	SW	R9006
	Steel	Z30M000S.04	

	Front/base stabiliser		
	Stabilises wide and high fronts. Reinforces the connection between the drawer side and the front.	Z96.10E1	
	Planning	81	

3	Back fixing left/right		
	Colour options	SW	R9006
	Steel	Z30D000SL	

Ordering information

8	Gallery left/right		
	Colour options	SW	WGR
	NL (mm)	Steel	
	270	ZRG.207RSIC	
	350	ZRG.287RSIC	
	400	ZRG.337RSIC	
	450	ZRG.387RSIC	
	500	ZRG.437RSIC	
	550	ZRG.487RSIC	
	600	ZRG.537RSIC	
	650	ZRG.587RSIC	

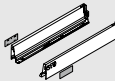
11a	Inner drawer side set		
	Colour options	SW	R9006
	NL (mm)	Steel	
	270	378M270SA	
	350	378M350SA	
	400	378M400SA	
	450	378M450SA	
	500	378M500SA	
Consisting of:			
2a	1 x drawer side left/right		
2b	2 x cover cap, stamped with Blum logo, custom printed from 1000 pcs		
For effective use of storage space, we recommend: Nominal length NL of outer drawer side (no 2) - nominal length NL of inner drawer side (no 11) = min. 150 mm			

Planning

Space requirements in the cabinet	Front installation dimensions	Drilling distances – front – INSERTA	Back installation dimensions
	<p>FA Front overlay</p>		

Cutting dimensions for 16 mm chipboard

	<p>Drawer back</p> <p>84 mm</p> <p>Base</p> <p>NL - 24 mm</p> <p>Centre piece</p> <p>71 mm</p>
<p>Y min. BLUMOTION = 48 mm</p> <p>Y min. TIP-ON BLUMOTION = 75 mm</p> <p>Y max. = 225 mm</p>	

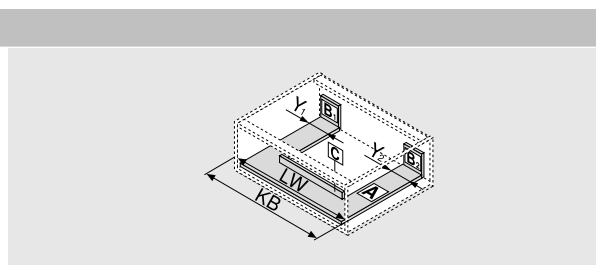

KB Cabinet width
 LW Internal cabinet width
 NL Nominal length
 SPW Internal width between sink drawer sides

$X = NL \text{ outer drawer side} - NL \text{ inner drawer side} - 10 \text{ mm}$

Drilling distances – centre piece

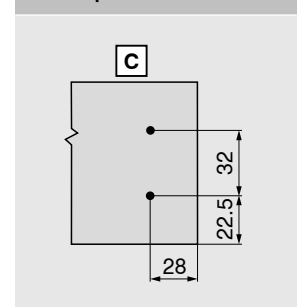

TIP-ON BLUMOTION

TANDEMBOX TIP-ON BLUMOTION cabinet profile



- TIP-ON mechanical opening support system combined with BLUMOTION for soft and effortless closing
- Front gap 2.5 mm
- Four-dimensional front adjustment
- Extensive trigger range
- Synchronized feather-light glide
- Synchronization for internal cabinet widths (LW) of 238 mm or more

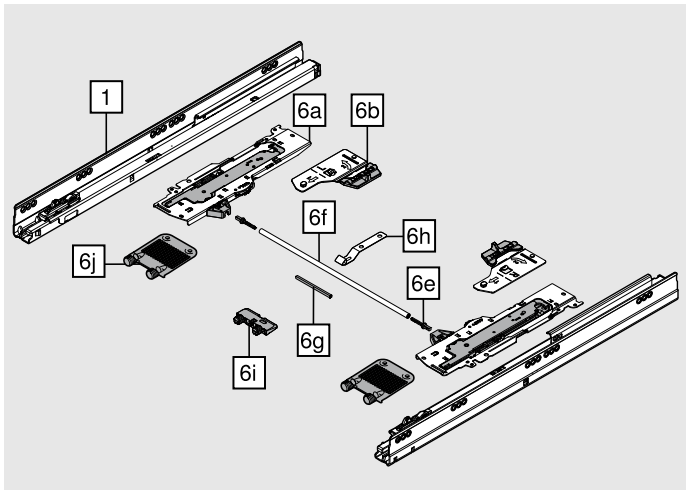

1	Cabinet profiles left/right		
	For TIP-ON BLUMOTION		
	Nominal length (mm)	30 kg	65 kg
	270	578.2701M	
	350	578.3501M	
	400	578.4001M	
	450	578.4501M	576.4501M
	500	578.5001M	576.5001M
	550	578.5501M	576.5501M
	600		576.6001M
	650		576.6501M

TIP-ON BLUMOTION

Ordering information

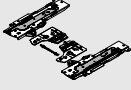
6 TIP-ON BLUMOTION set					
	NL (mm)	Unit	Cabinet profile (kg)	Weight (kg)	
	270	S0	30	≤ 10	T60B3030
	270	S1	30	> 10–20	T60B3130
	350–600	L1	30	≤ 20	T60B3330
	350–600	L3	30	15–40	T60B3530
	450–650	L5	65	35–65	T60B3560
Consisting of:					
6a	1x	TIP-ON BLUMOTION unit left/right			
6b	1x	TIP-ON BLUMOTION latch left/right			
6e	2x	TIP-ON BLUMOTION synchronization adapter			
	¹	Recommended weight ranges (total weight of the pull-out) for an optimum opening and closing function			
	²	Can only be combined with a 30 kg cabinet profile			
	³	Recommendation: Only use in combination with a 65 kg cabinet profile			

Internal cabinet width LW ≥ 287 mm

6f TIP-ON BLUMOTION synchronization linkage			
	Version	Colour	
	Round	Grey	T60.1125W
In combination with 6e 2 x T60.000D			
Suitable up to internal cabinet width LW 1370 mm			
Note			
To optimise the function and trigger range, we generally recommend using synchronization			
Cutting	Internal cabinet width LW - 240 mm		

Internal cabinet width LW 238–286 mm

6g TIP-ON BLUMOTION synchronization			
	Version	Colour	
	Square	R7035	T60.300D
Cutting	Internal cabinet width LW - 214 mm		

Accessories

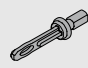
6e TIP-ON BLUMOTION synchronization adapter			
	Version	Colour	
	Symmetrical	R7035	T60.000D
Internal cabinet width LW ≥ 287 mm			

6h TIP-ON BLUMOTION synchronization linkage fixing			
	Cabinet width KB (mm)	Material	
	≥ 750	Steel	T60B000H
For pull-outs over a cabinet base or cross member			
Prevents the TIP-ON BLUMOTION synchronization linkage from sagging			

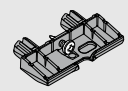
6i Base support bracket			
	Cabinet width KB (mm)	Colour	
	≥ 750	RAL 7037	Z96.2011
For pull-outs over a cabinet base or cross member			
Prevents the TIP-ON BLUMOTION synchronization linkage from sagging			

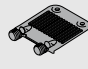
6j Front/base stabilizer			
	Material	Colour	
	Nylon	R7037	2x Z96.10E1

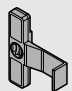
- TIP-ON BLUMOTION checking/setting template			
	Front gap FS (mm)	Colour	
	2.5	Orange	65.5627

TIP-ON BLUMOTION

Space requirements in the cabinet

Drawer | High fronted pull-out

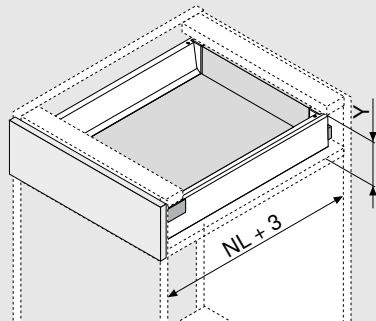

Back height	Y (mm)
N	85.5
M	101.5
B	161
C	195
D	227
NL Nominal length	

Inner drawer | Inner pull-out

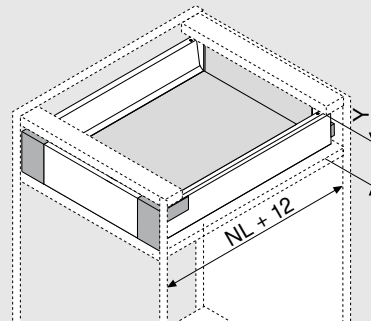

Back height	Y (mm)
M	109
B	161
C	195
D	227
NL Nominal length	

Space requirements in the cabinet

Drawer | High fronted pull-out

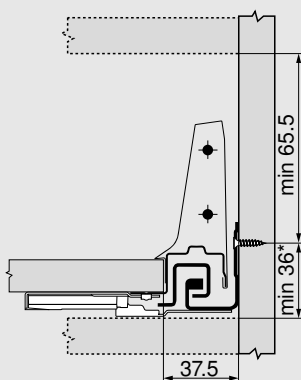

Height M

* For 36-39 mm and a cabinet width KB of ≥ 750 you require a fixing, TIP-ON BLUMOTION synchronization and a base support bracket to prevent the synchronization linkage from colliding with the cabinet base or the cross member

A trial application is recommended

Inner drawer | Inner pull-out

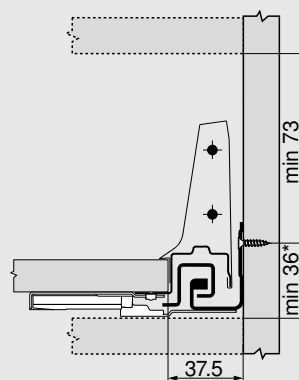

TIP-ON BLUMOTION

Screw position – inner drawer | inner pull-out

Option 1

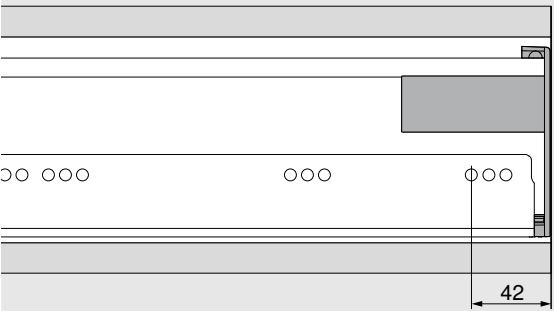

Option 2

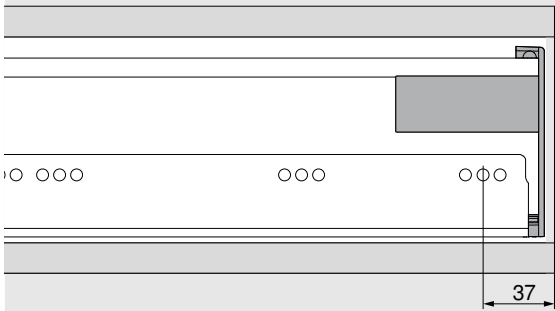

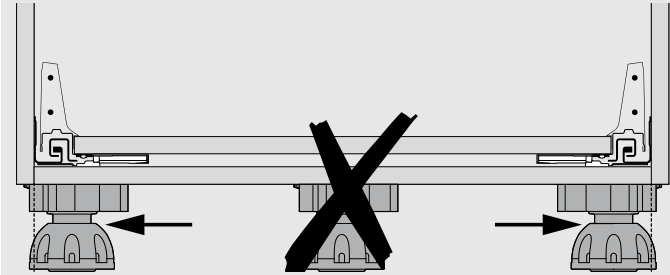

Plinth leg

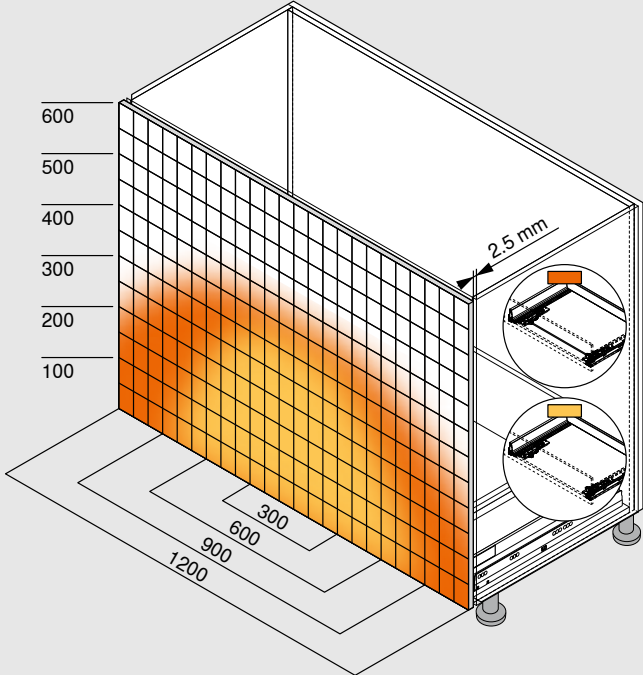

Trigger range



	With synchronization
	Without synchronization

Minimum front gap (mm)	2.5
With front/base stabilizer	
To optimize the function and trigger range, we generally recommend using synchronization	
Example for 578 – 30 kg 576 – 65 kg, height D, nominal length NL 500 mm	

TIP-ON BLUMOTION

TIP-ON BLUMOTION synchronization linkage fixing



- Prevents the TIP-ON BLUMOTION synchronization linkage from sagging
- For pull-outs over a cabinet base or cross member
- Required for cabinet widths KB of ≥ 750 mm
- Material: Steel

Ordering information

TIP-ON BLUMOTION synchronization linkage fixing

T60B000H

Drilling distance – drawer base

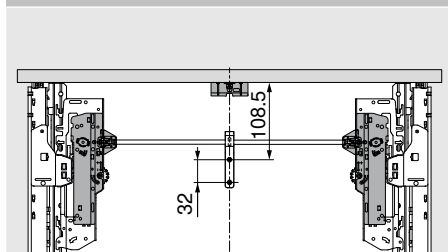

Nominal length (mm)	TIP-ON BLUMOTION unit
270	S0 S1

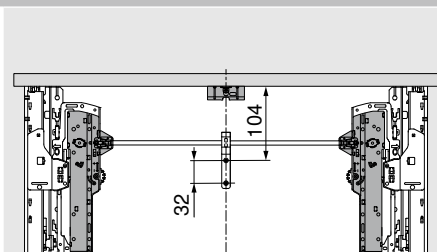

Nominal length (mm)	TIP-ON BLUMOTION unit
350–650	L1 L3 L5

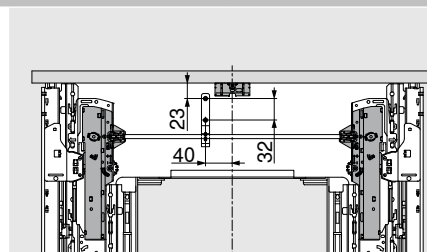

Sink cabinet

Nominal length (mm)	TIP-ON BLUMOTION unit
450–650	L1 L3 L5

Base support bracket

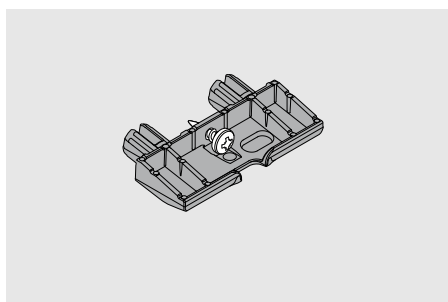

- For supporting the pull-out base
- For pull-outs over a cabinet base or cross member
- Required for cabinet widths KB of ≥ 750 mm
- Material: Nylon

Ordering information

Base support bracket

Cabinet width KB (mm)	Colour
≥ 750	R7037 dust grey
Z96.2011	

Space requirements in the cabinet

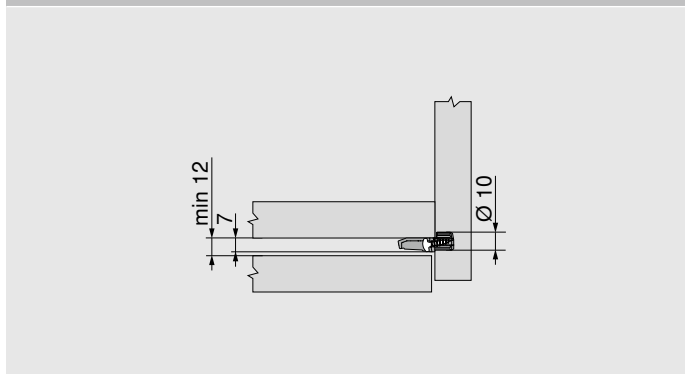

Space requirements in the cabinet

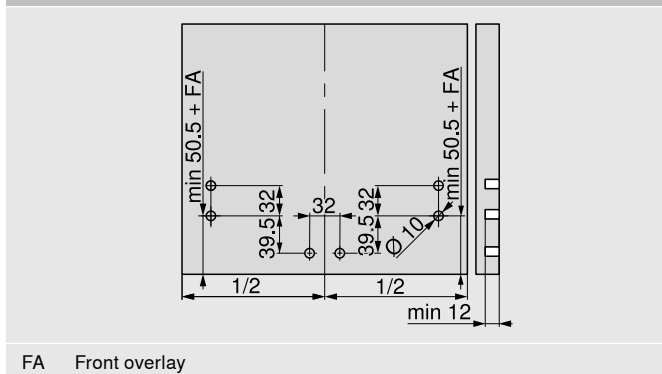

FA Front overlay

TIP-ON BLUMOTION

Front/base stabilizer

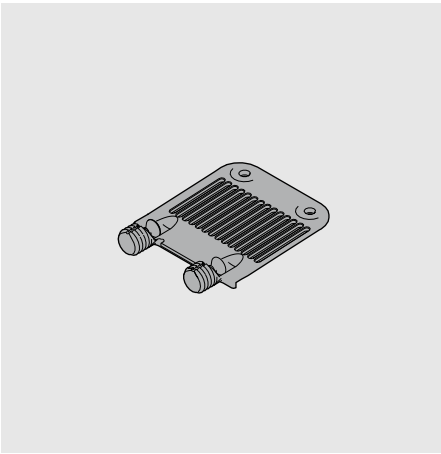

- For stabilizing high fronts
- For supporting wide drawer bases
- Recommendation:
 - Front height FH < 300 mm:
 - Cabinet width KB > 900 mm: 1 pc
 - Front height FH ≥ 300 mm:
 - Cabinet width KB < 450 mm: 1 pc
 - Cabinet width KB ≥ 450 mm: 2 pcs

Ordering information	
Front/base stabilizer	
Fixing method	Colour
EXPANDO	R7037 dust grey
Z96.10E1	

Planning

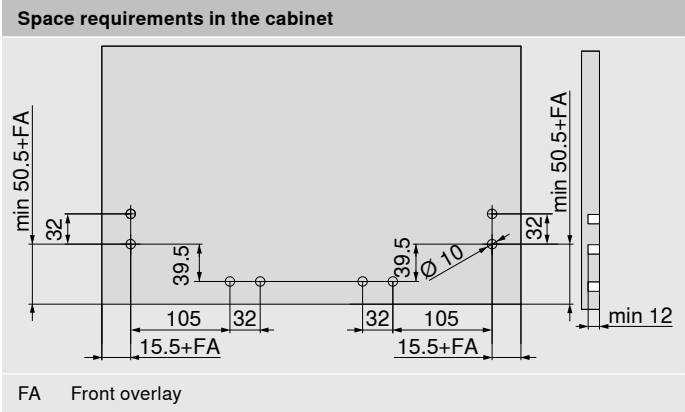
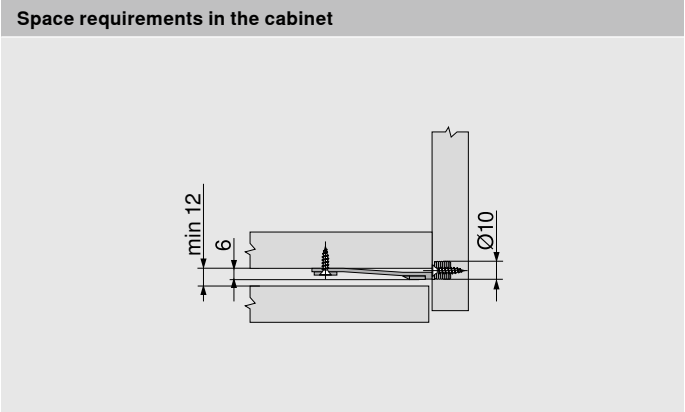

Cabinet profile

Cabinet profile fixing

Cabinet profile 578M – 30 kg

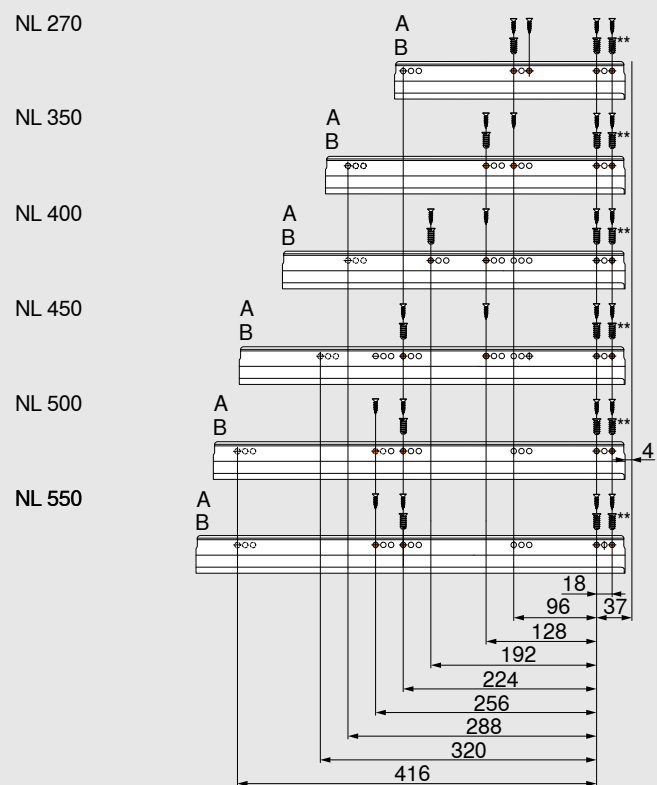

Cabinet profile 576M – 65 kg

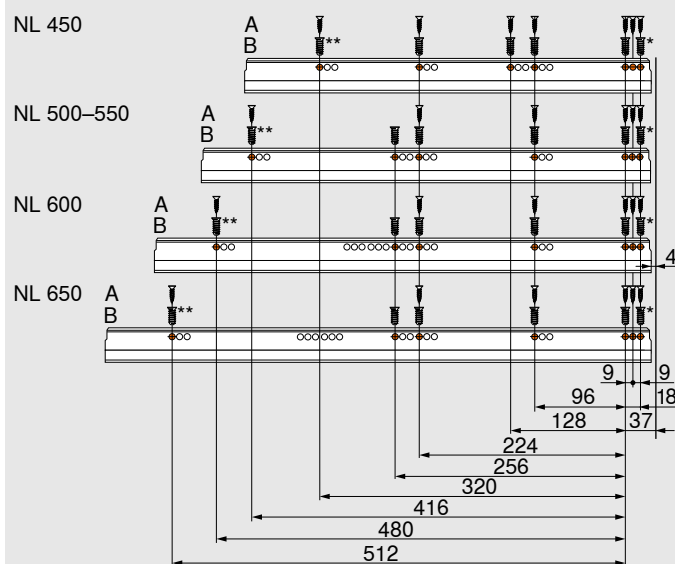

A Chipboard screw
Ø 4 x 15 mm

B System screw
part no. 661.1450.HG

* Can be replaced with A

** Optional for greater stability
Can be replaced with A

Accessories

Ordering information

Back fixing height B			
	Colour options	SW	WGR
		Steel	
		Z30B000S.04	

Planning

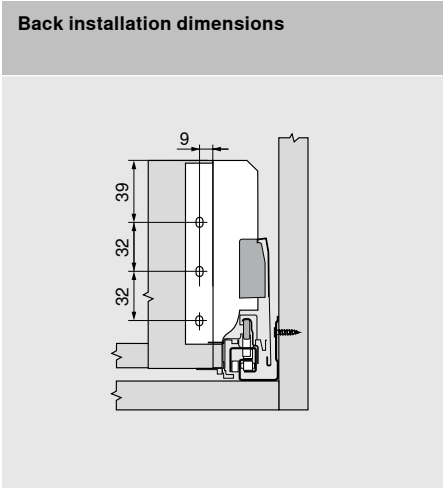
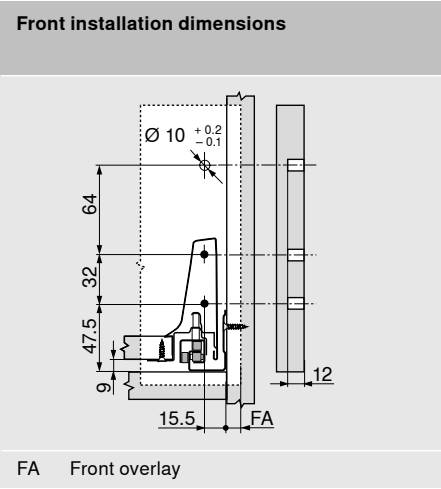
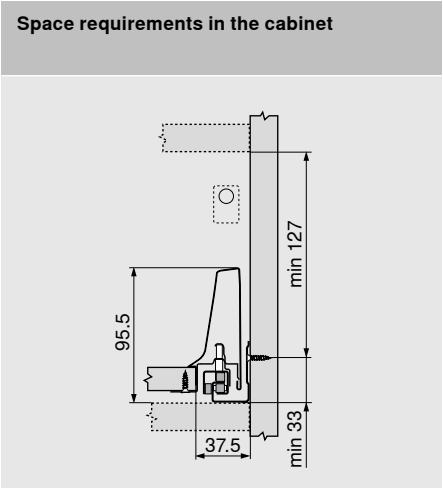

Flexible gallery fixing

Accessories – Flexible gallery fixing

Flexible gallery fixing			
	Colour options	SW	R9006
		Steel	
		ZRR.5200	

Planning

Space requirements in the cabinet	Front installation dimensions	Back installation dimensions
<p>Free placement $Y = X - 4 \text{ mm}$ X Back height</p>	<p>Free placement $Z = X - 71 \text{ mm}$ X Back height FA Front overlay</p>	<p>Free placement $W = X - 103 \text{ mm}$ X Back height</p>

Space requirements in the cabinet	Front installation dimensions	Back installation dimensions
<p>Height D – double gallery (back fixing height B)</p>	<p>Height D – double gallery (back fixing height B) FA Front overlay</p>	<p>Height D – double gallery (back fixing height B)</p>

Front/base stabilizer

Front/base stabilizer

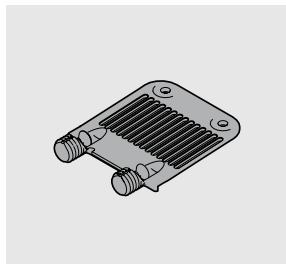

Ordering information	
Front/base stabilizer	
Fixing method	Colour
EXPANDO	R7037 dust grey
	Z96.10E1

- For stabilizing high fronts
- For supporting wide drawer bases
- Recommendation:
 - Front height FH < 300 mm:
 - Cabinet width KB > 900 mm: 1 pc
 - Front height FH ≥ 300 mm:
 - Cabinet width KB < 450 mm: 1 pc
 - Cabinet width KB ≥ 450 mm: 2 pcs
 - Cabinet width KB > 900 mm: 3 pcs

Planning

Space requirements in the cabinet

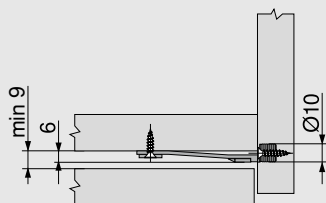

Drilling distances – front

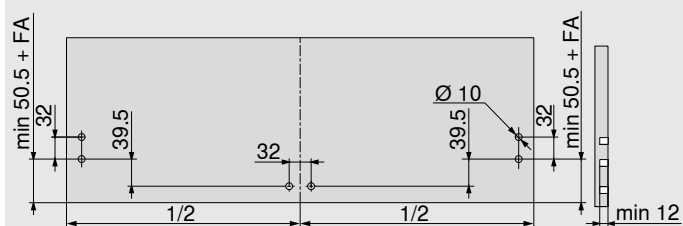



moving ideas

We believe that ideas can move the world. We offer innovative fittings, inspiring furniture concepts and appropriate services so that you can turn your creative ideas into reality. We are driven by your needs, international trends and our shared vision of a better quality of living. Let us work together to create moving ideas.



Quality of living

We would like you to enjoy greater convenience and functionality when using furniture.



Product range

Everything from a single source: our wide range of products allows you to keep up with today's and tomorrow's trends.



Inspiration

We monitor global trends and strive to create the solutions of tomorrow. We like to share our insights with you.



Innovation

We stay in motion. Curiosity and pioneering spirit drive us to develop new products and services for you.



Services

We support your daily operations with customised services tailored to your processes.



Quality

We continuously strive to improve our products, services and ourselves.



Trust

We take responsibility for partnerships, our employees, society and the environment.

Julius Blum started our journey in 1952 with horseshoe studs. Today we supply innovative fittings to customers in over 120 countries.

Blum Canada Ltd.
6775 Maritz Drive
Mississauga, ON, L5W 0H5
Tel.: 905-670-7920
Long Dist.: 1-800-670-9254
E-Mail: info.ca@blum.com

Julius Blum GmbH
Furniture Fittings Mfg.
6973 Höchst, Austria
Tel.: +43 5578 705-0
Fax: +43 5578 705-44
E-mail: info@blum.com
www.blum.com

Our sites in Austria, Poland and China are certified to the international standards mentioned below.
Our site in the USA is certified to ISO 9001.
Our site in Brazil is certified to ISO 9001, ISO 14001 and ISO 45001.



ISO 9001
Certified Quality
System



ISO 14001
Certified Environmental
System



ISO 50001
Certified Energy
System

 **blum**®



Look for our
FSC®-certified
products

All content is copyrighted by Blum.
Subject to technical modifications and changes to the range without notice.
IDNR: 330.586.8 · EP-613/1 EN-CA.03.23