



# TANDEMBOX antaro

Clear-cut and rectangular

# Mutual trust develops and grows

A reliable product, bespoke services, stringent quality standards, award-winning design and consistent development – these are the foundations of a successful partnership.

Proven a million times over, TANDEMBOX antaro fits the bill in every way, and has done so for decades. Our double walled box system is not only an unrivalled technological success; it is also a milestone in our corporate history. The trust you place in our product confirms that we are on the right track. We have further developed TANDEMBOX antaro and streamlined the range. This means you need less warehouse space and can further improve inventory efficiency.

Inspire your customers with our box system and rest assured that we will not stand still. We are always looking to drive innovation and enhance established products.



## Contents

04	Technology
06	Design
08	Colours
10	Range
12	Assembly and manufacturing
14	SERVICES
16	Applications
40	Ordering and planning information
90	moving ideas







# Proven a million times over – TANDEMBOX cabinet profile

All TANDEMBOX antaro applications are based on the tried and tested TANDEMBOX cabinet profile. Its feather-light glide has impressed users for decades. Low-friction cylindrical nylon rollers are designed to withstand loads of 30 and 65 kg and deliver top quality motion for the lifetime of the furniture. This promise is guaranteed by rigorous quality controls that go beyond legal requirements and international standards.

## Opening and closing ease

Motion technologies by Blum ensure top quality motion and ease of use day in, day out. Be it mechanical or electrical – drawers and pull-outs equipped with Blum motion support systems seem to open and close by themselves.



**mechanical**  
soft close



**electrical**  
opening &  
soft close



**mechanical**  
opening &  
soft close





## Timeless – Rectangular design

TANDEMBOX antaro is characterised by its clear-cut design and rectangular gallery. This means you can carry minimalist design through to pull-outs and drawer sides.

An orange line that starts as a horizontal line, then turns 90 degrees downward to point at the bevelled top edge of the drawer side.

The bevelled top edge of the drawer side (A design) continues the linear look of the rectangular gallery.

# Harmonious – Two colours, one style

The minimalist design of TANDEMBOX antaro is based on clean lines and a sleek colour scheme. All nylon components are colour coordinated with the drawer sides. The colour range includes two options in steel: silk white and white aluminium.









**Multifaceted –  
One solution,  
countless options**



TANDEMBOX antaro gives you an entire range of pull-outs and drawers to choose from. Be it in the kitchen, bathroom or living area – TANDEMBOX antaro offers the right solution for any application.



Drawer sides also come in different heights, making it easy to turn customers' wishes into reality.

Nominal lengths 270 – 650 mm

Cabinet widths 275 – 1200 mm

Drawer side heights  
N (68.5 mm)  
M (83.6 mm)  
K (115.6 mm)

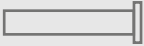
### Basic components

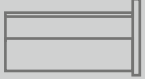
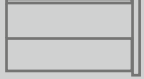
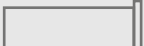
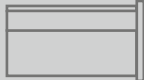
Drawer side height	Back height	
N 		
M 	C 	D 
K 		D 

# Fast and straightforward – Assembly devices

Our goal is to provide you with the best possible service. This includes support with the manufacture of our products.

Practical assembly devices tailored to your production requirements optimise the assembly of Blum box systems. This also applies to smaller production runs.



You will find our assembly devices here:  
[www.blum/jigs](http://www.blum/jigs)

With BOXFIX plus, TANDEMBOX antaro components are pneumatically clamped and then screwed together quickly and efficiently. Easy setup and pre-set stops save time and improve assembly quality.





## Simple and tool free – Assembly



Thanks to tried and tested INSERTA technology, the gallery and front can be assembled without tools.



The gallery rail can be quickly clipped onto the back.



Simple tilt adjustment allows you to align gaps in no time.



Creating TANDEMBOX antaro couldn't be easier!



Watch assembly video:  
[www.blum.com/172HZO](http://www.blum.com/172HZO)

# Useful and available 24/7 – Our services

Good services are there when you need them. As a trusted partner, we not only offer practical assembly devices but also provide services tailored to your production needs. Let us help you transform your ideas into fine furniture.



## Marketing

### Marketing Media Library

Use our high-resolution images, videos and brochures for your promotion campaigns and gain inspiration – completely free of charge and around the clock.

## Concept and planning, quotation

### Product and Cabinet Configurator

Plan, configure and save your projects online with ease – with our free Product and Cabinet Configurator. Create up-to-date parts lists for your offers to customers.

## Design

### CAD/CAM Data Service

Our CAD/CAM Data Service provides comprehensive data for your software. You will find an overview of our interface partners on our homepage.

## Ordering

### Distributor interface

Transfer the parts list produced by our Product and Cabinet Configurator directly to the online shops of selected distributors and simply save your projects under “My projects”.



### Manufacturing

#### **MINIPRESS with EASYSTICK**

Our configurators provide you with production drawings or the BXF format so that you can transfer your planning results to MINIPRESS with EASYSTICK. We also offer templates and assembly devices to support you with manufacturing.

### Delivery and installation

#### **EASY ASSEMBLY app**

Use our EASY ASSEMBLY app to install and adjust our fittings quickly and efficiently. The app contains assembly instructions and videos for all our products.

### After sales service

#### **Personal consultation**

We provide personal after-sale support. Your contact at Blum will be happy to answer any questions you might have about our products and services.





High fronted pull-out  
height C with gallery





Drawer height N



High fronted pull-out height D with gallery



# Organisation and visibility – Inner dividing system

## ORGA-LINE

The high-quality inner dividing system works wonders on the interiors of drawers and high fronted pull-outs. Whether chopping boards, cutlery, bottles or pots and pans, all items are held securely and immediately to hand. Give yourself clear visibility and tailor your storage space to your needs.



Our range at a glance:  
[www.blum.com/orgaline1](http://www.blum.com/orgaline1)











### SPACE TWIN

Top: Drawer height M

Bottom: High fronted pull-out height D with gallery





High fronted pull-out height C with gallery



High fronted pull-out height D with gallery





Sink pull-out height C with gallery



Drawer and inner drawer height M





High fronted pull-out height C with gallery

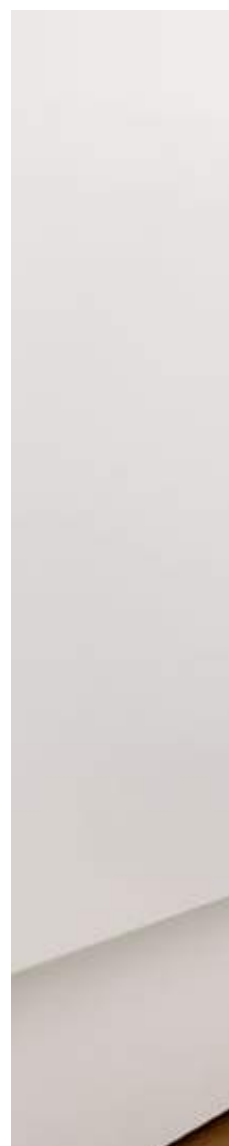





## Extra storage – One system, multiple solutions

TANDEMBOX antaro allows you to implement clever cabinet solutions that provide practical storage space. SPACE STEP, for example, creates additional storage in the cabinet plinth and makes it easier to reach items in wall cabinets. SPACE TWIN and the U-shaped sink pull-out make full use of every inch of space available. And the SPACE TOWER larder unit provides ample space and easy accessibility to all storage items.







## SPACE TOWER – Larder unit

The ultimate solution for larder units: ample storage space, inner pull-outs that can be tailored to your storage space needs and access to items from all three sides. This is the convenient and ergonomic way to store provisions. Thanks to full extension, you have easy access to all contents from the left, right and even from the front.



Inner pull-out height C



Inner pull-out height D



SPACE TOWER comes in all heights, widths and depths. In other words, it can be tailored to your personal storage space requirements.



# SPACE STEP – Plinth solution

## Nice and high

You have to use every inch of space in compact homes. SPACE STEP allows you to use the space right up to the ceiling. The new plinth solution gives users easy access to the top shelves of wall cabinets.





Find out more about SPACE STEP here:  
[www.blum.com/spacestep](http://www.blum.com/spacestep)

### Nice and practical

You need the right furniture for customers who want to store lots of things. SPACE STEP not only allows you to use higher cabinets, but also creates extra storage space in the toe kick of base units. Two solutions rolled into one.







## Sink cabinet – Don't waste an inch of space

### Organise your under-sink space

The U-shaped pull-out puts the space to the left and right of the sink to best possible use. It's ideal for clearing away sponges, washing-up liquid and tabs. This pull-out is recommended for cabinet widths of 900 mm or more.

### Extra storage space

An additional inner pull-out provides plenty of space for cleaning utensils such as sponges, cleaning cloths and bin liners.

### Nice and clean

The full extension makes it easy to throw away waste, empty and clean waste bins. Practical inner dividing systems such as ORGA-LINE ensure that cleaning products are held securely.



## SPACE TWIN – Narrow cabinets

### A practical solution for small storage spaces

Narrow cabinets turn tiny kitchen spaces into valuable storage. Blum's SPACE TWIN with diagonally offset runners creates additional storage space – without compromising stability or quality of motion. This is the ideal place to keep narrow items such as bottles, chopping boards, spices and baking trays.



Find out more about SPACE TWIN here:

[www.blum.com/spacetwin](http://www.blum.com/spacetwin)

# TANDEMBOX also looks good in the bathroom



High fronted pull-out height C with gallery



Drawer height K with  
inner drawer height M





High fronted pull-out height C with gallery



Inner pull-out height C with gallery

# Ordering and planning information



**Drawer**Height N  
82.5 mm**42**Height M  
98.5 mm**44**Height K  
130.5 mm**48****Inner drawer**Height M  
106 mm**46**Height K  
136.5 mm**50****High fronted pull-out**Height C  
192 mm**52**Height D  
224 mm**58**Height D  
with drawer side K  
224 mm**62**Height C  
with aluminium frame  
192 mm**56**Height D  
with aluminium frame  
224 mm**66****Inner pull-out**Height C  
192 mm**54**Height D  
224 mm**60**Height D  
with drawer side K  
224 mm**64****Sink pull-out**Height C  
192 mm**68**Height D  
224 mm**70****TIP-ON BLUMOTION****72**

Cabinet profile fixing

**78**

Steel back

**79**

Flexible gallery fixing

**80**

Front/base stabiliser

**81**

Assembly, adjustment and removal

**83****Colour**

SW	Silk white
R9006	RAL 9006 grey (white aluminium)
WGR	White grey
R7037	RAL 7037 dust grey

## Product



## Description

- Concealed, guided full extension
- Tool-free front assembly
- 2-dimensional front adjustment
- With integrated BLUMOTION, can be combined with SERVO-DRIVE or with TIP-ON BLUMOTION

## Space requirement

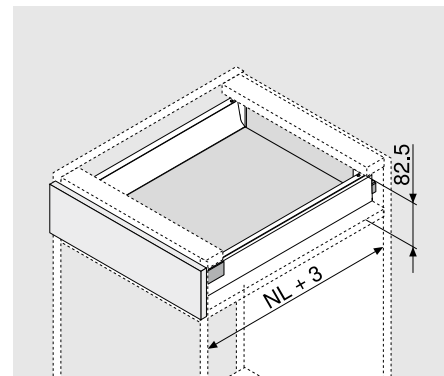

NL Nominal length

## Ordering information

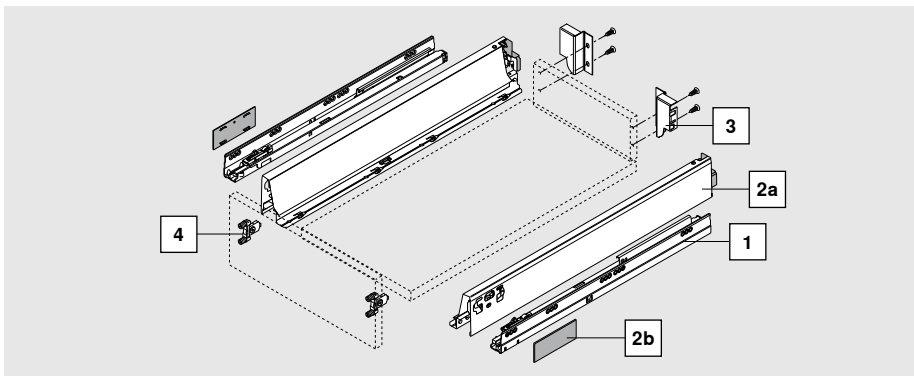

1	Cabinet profiles left/right	
	Dynamic carrying capacity (kg)	BLUMOTION*
	Nominal length (mm)	30 kg
	400	578.4001M
	450	578.4501M
	500	578.5001M
	550	578.5501M

\*Suitable for SERVO-DRIVE and TIP-ON BLUMOTION

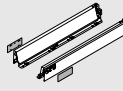
2	Drawer side set	
	Colour options	SW R9006
	NL (mm)	Steel
	400	378N4002SA
	450	378N4502SA
	500	378N5002SA
	550	378N5502SA

### Consisting of:

2a	1 x drawer side left/right
2b	2 x cover cap, stamped with Blum logo, custom printed from 1000 pcs

## Ordering information

<b>3</b> 	<b>Back fixing left/right</b>		
	Colour options	SW	R9006
		Steel	
		Z30N000S.04	
	Steel back		79

<b>4</b> 	<b>Front fixing bracket</b>		
	INSERTA version	2x	ZSF.39A2
	Screw-on version	2x	ZSF.35A2
	Knock-in version	2x	ZSF.36A2

## Planning

Space requirements in the cabinet	Front installation dimensions	Drilling distances – front – INSERTA   knock-in assembly	Back installation dimensions
	<p>FA Front overlay</p>		

Cutting dimensions for 16 mm chipboard	
<p><b>Drawer back</b> 69 mm LW - 87 mm</p>	<p>KB Cabinet width LW Internal cabinet width NL Nominal length</p>
<p><b>Base</b> Chipboard back NL - 24 mm Steel back NL - 22 mm LW - 75 mm</p>	



## Product



## Description

- Concealed, guided full extension
- Tool-free front assembly
- 2-dimensional front adjustment
- With integrated BLUMOTION, can be combined with SERVO-DRIVE or with TIP-ON BLUMOTION

## Space requirement

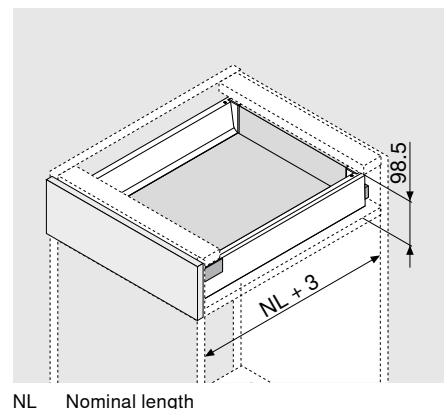

## Ordering information

1	Cabinet profiles left/right		
	Dynamic carrying capacity (kg)		
	Nominal length NL (mm)	BLUMOTION*	
		30 kg	65 kg
	270	578.2701M	
	300	578.3001M	
	350	578.3501M	
	400	578.4001M	
	450	578.4501M	576.4501M
	500	578.5001M	576.5001M
	550	578.5501M	576.5501M
	600	578.6001M	576.6001M
	650		576.6501M
*Suitable for SERVO-DRIVE and TIP-ON BLUMOTION			

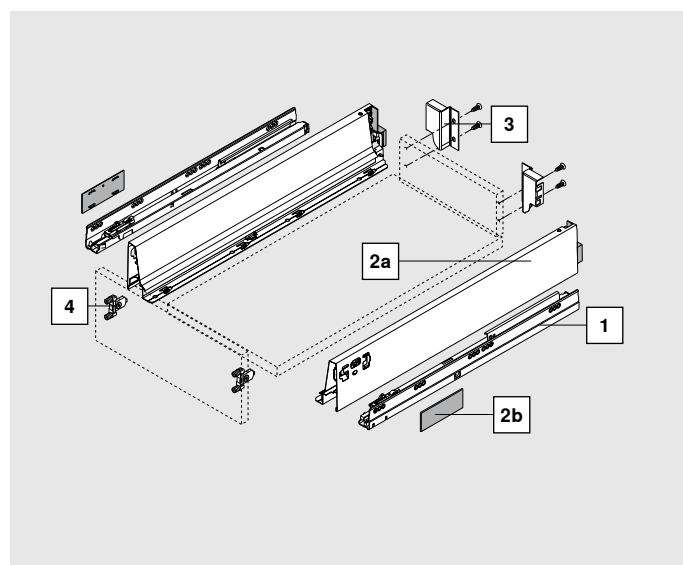

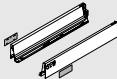
2	Drawer side set		
	Colour options	SW	R9006
	NL (mm)	Steel	
	270	378M2702SA	
	300	378M3002SA	
	350	378M3502SA	
	400	378M4002SA	
	450	378M4502SA	
	500	378M5002SA	
	550	378M5502SA	
	600	378M6002SA	
	650	378M6502SA	
	Consisting of:		
2a	1 x drawer side left/right		
2b	2 x cover cap, stamped with Blum logo, custom printed from 1000 pcs		

Ordering information

<div>3</div>	<b>Back fixing left/right</b>		
	Colour options	SW	R9006
		Steel	
		Z30M000S.04	
	Steel back		79

<div>4</div>	<b>Front fixing bracket</b>		
	INSERTA version	2x	ZSF.39A2
	Screw-on version	2x	ZSF.35A2
	Knock-in version	2x	ZSF.36A2

Planning

Space requirements in the cabinet

Front installation dimensions

FA Front overlay

Drilling distances – front –  
INSERTA | knock-in assembly

Back installation dimensions

Cutting dimensions for 16 mm chipboard

B

Drawer back

84 mm

LW - 87 mm

A

Base

Chipboard back

NL - 24 mm

Steel back

NL - 22 mm

LW - 75 mm

KB Cabinet width

LW Internal cabinet width

NL Nominal length

## Product



## Description

- Concealed, guided full extension
- Tool-free front assembly
- With integrated BLUMOTION, can be combined with SERVO-DRIVE or with TIP-ON BLUMOTION
- Inner drawers either with handle or handle and latch

## Space requirement

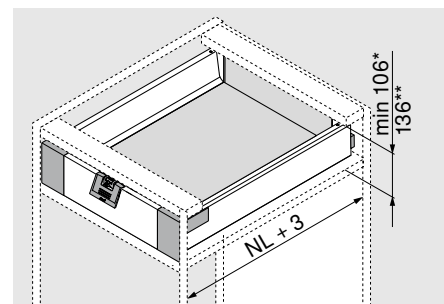

- NL Nominal length  
 \* Min. space requirement for inner drawers with or without handles  
 \*\* Inner drawers with easy access from above

## Ordering information

1	Cabinet profiles left/right		
	Dynamic carrying capacity (kg)		
	Nominal length NL (mm)	BLUMOTION*	
		30 kg	65 kg
	270	578.2701M	
	300	578.3001M	
	350	578.3501M	
	400	578.4001M	
	450	578.4501M	576.4501M
	500	578.5001M	576.5001M
	550	578.5501M	576.5501M
	600	578.6001M	576.6001M
	650		576.6501M
*Suitable for SERVO-DRIVE and TIP-ON BLUMOTION			

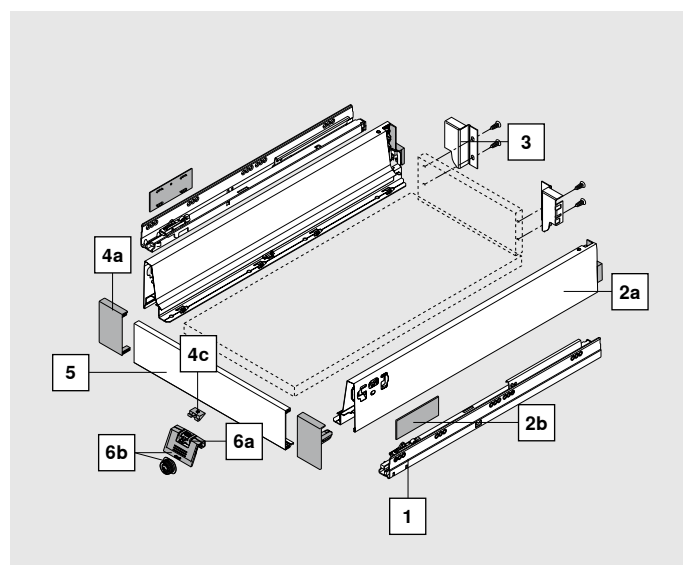

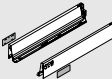
2	Drawer side set		
	Colour options	SW	R9006
	NL (mm)	Steel	
	270	378M2702SA	
	300	378M3002SA	
	350	378M3502SA	
	400	378M4002SA	
	450	378M4502SA	
	500	378M5002SA	
	550	378M5502SA	
	600	378M6002SA	
	650	378M6502SA	
	Consisting of:		
2a	1 x drawer side left/right		
2b	2 x cover cap, stamped with Blum logo, custom printed from 1000 pcs		



## Ordering information

	<b>3 Back fixing left/right</b>		
	Colour options	SW	R9006
	Steel	<b>Z30M000S.04</b>	
	Steel back		<b>79</b>

	<b>5 Front piece</b>		
	Colour options	SW	R9006
	Aluminium	<b>Z31L1036A</b>	
	For cutting to size		

	<b>4 Front fixing left/right</b>		
	Colour options	SW	WGR
	Nylon		
		<b>ZIF.71M0</b>	

	<b>6a Handle</b>		
	Colour options	SW	WGR R7037
	Nylon		
		<b>ZIF.80M5</b>	

<b>Consisting of:</b>	
<b>4a</b>	1 x front fixing left/right
<b>4c</b>	1 x locking piece

	<b>6b Handle</b>		
	Colour options	SW/R7037	WGR/R7037 R7037
	Nylon		
		<b>ZIF.80M7</b>	

## Planning

**Space requirements in the cabinet**

\* Min. space requirement for inner drawers with or without handles  
Without a handle, opening is only possible from the bottom

\*\* Inner drawers with easy access from above

**Front drilling distances for latch**

**Back installation dimensions**

### Cutting dimensions for 16 mm chipboard

	<b>Drawer back</b>
	84 mm
	<b>Base</b>
	Chipboard back
	NL - 24 mm
	Steel back
	NL - 22 mm
	LW - 75 mm

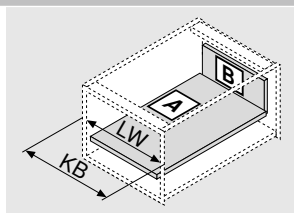

KB Cabinet width  
LW Internal cabinet width  
NL Nominal length

### Front piece for cutting to size

$x = LW - 132$

## Product



## Description

- Concealed, guided full extension
- Tool-free front assembly
- 2-dimensional front adjustment
- With integrated BLUMOTION, can be combined with SERVO-DRIVE or with TIP-ON BLUMOTION

## Space requirement

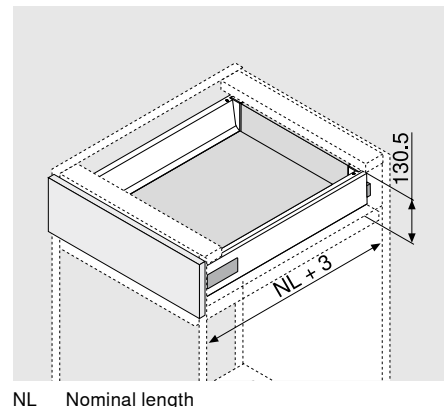

NL Nominal length

## Ordering information

1	Cabinet profiles left/right		
	Dynamic carrying capacity (kg)		
	Nominal length NL (mm)	BLUMOTION*	
		30 kg	65 kg
	270	578.2701M	
	300	578.3001M	
	350	578.3501M	
	400	578.4001M	
	450	578.4501M	576.4501M
	500	578.5001M	576.5001M
	550	578.5501M	576.5501M
	600	578.6001M	576.6001M
	650		576.6501M
*Suitable for SERVO-DRIVE and TIP-ON BLUMOTION			

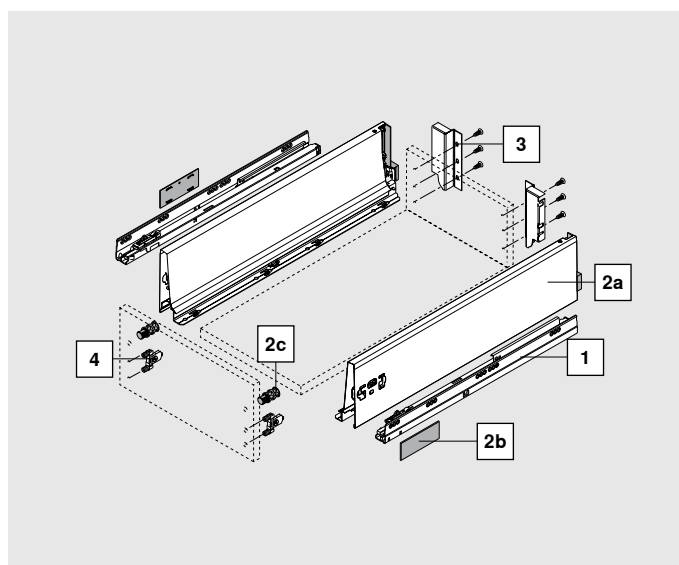

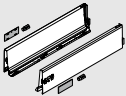
	Drawer side set		
	Colour options	SW	R9006
	NL (mm)	Steel	
	270	378K2702SA	
	300	378K3002SA	
	350	378K3502SA	
	400	378K4002SA	
	450	378K4502SA	
	500	378K5002SA	
	550	378K5502SA	
	600	378K6002SA	
	650	378K6502SA	
Consisting of:			
2a	1 x drawer side left/right		
2b	2 x cover cap, stamped with Blum logo, custom printed from 1000 pcs		
2c	2 x positioning dowel		

## Ordering information

	<b>3 Back fixing left/right</b>		
	Colour options	SW	R9006
		Steel	
		Z30K000S	
	Steel back		79

	<b>4 Front fixing bracket</b>		
	INSERTA version	2x	ZSF.39A2
	Screw-on version	2x	ZSF.35A2
	Knock-in version	2x	ZSF.36A2

## Planning

Space requirements in the cabinet	Front installation dimensions	Drilling distances – front – INSERTA   knock-in assembly	Back installation dimensions
	<p>FA Front overlay</p>		

Cutting dimensions for 16 mm chipboard	
<p><b>Drawer back</b> 116 mm</p> <p><b>Base</b> Chipboard back NL - 24 mm Steel back NL - 22 mm</p>	<p>KB Cabinet width LW Internal cabinet width NL Nominal length</p>



## Product



## Description

- Concealed, guided full extension
- Tool-free front assembly
- With integrated BLUMOTION, can be combined with SERVO-DRIVE or with TIP-ON BLUMOTION
- Inner drawers either with handle or handle and latch

## Space requirement

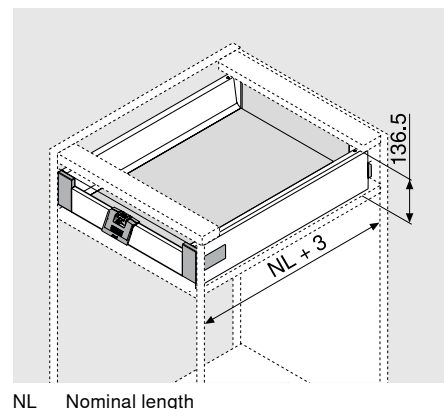

NL Nominal length

## Ordering information

1	Cabinet profiles left/right		
	Dynamic carrying capacity (kg)		
	Nominal length NL (mm)	BLUMOTION*	
		30 kg	65 kg
	270	578.2701M	
	300	578.3001M	
	350	578.3501M	
	400	578.4001M	
	450	578.4501M	576.4501M
	500	578.5001M	576.5001M
	550	578.5501M	576.5501M
	600	578.6001M	576.6001M
	650		576.6501M
*Suitable for SERVO-DRIVE and TIP-ON BLUMOTION			

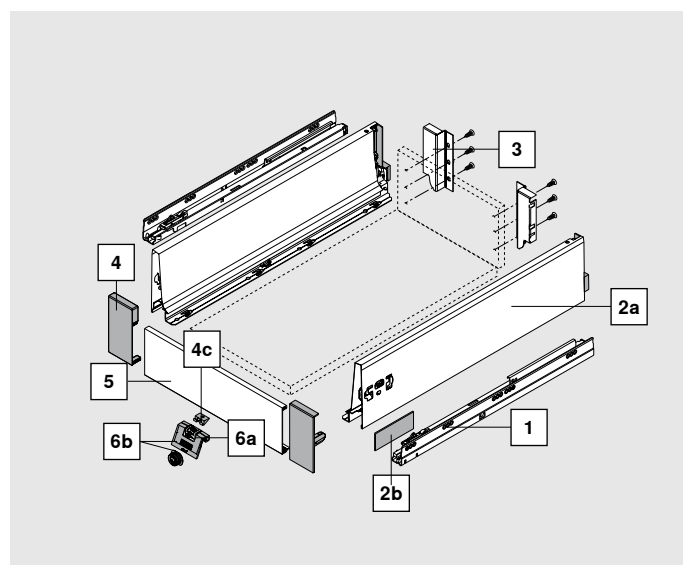

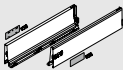
2	Drawer side set		
	Colour options	SW	R9006
	NL (mm)	Steel	
	270	378K2702SA	
	300	378K3002SA	
	350	378K3502SA	
	400	378K4002SA	
	450	378K4502SA	
	500	378K5002SA	
	550	378K5502SA	
	600	378K6002SA	
	650	378K6502SA	
Consisting of:			
2a	1 x drawer side left/right		
2b	2 x cover cap, stamped with Blum logo, custom printed from 1000 pcs		
2c	2 x positioning dowel		

## Ordering information

<b>3</b>	<b>Back fixing left/right</b>		
	Colour options	SW	R9006
	Steel	<b>Z30K000S</b>	
	Steel back		<b>79</b>

<b>4</b>	<b>Front fixing left/right</b>		
	Colour options	SW	WGR
	Nylon		<b>ZIF.71K0</b>

### Consisting of:

<b>4a</b>	1 x front fixing left/right
<b>4c</b>	1 x locking piece

<b>5</b>	<b>Front piece</b>		
	Colour options	SW	R9006
	Aluminium		<b>Z31L1036A</b>
	For cutting to size		

<b>6a</b>	<b>Handle</b>		
	Colour options	SW	WGR R7037
	Nylon		<b>ZIF.80M5</b>

<b>6b</b>	<b>Handle</b>		
	Colour options	SW/R7037	WGR/R7037 R7037
	Nylon		<b>ZIF.80M7</b>

## Planning

Space requirements in the cabinet	Front drilling distances for latch	Back installation dimensions

Cutting dimensions for 16 mm chipboard	Front piece for cutting to size
<p><b>Drawer back</b> 116 mm</p> <p><b>Base</b> Chipboard back NL - 24 mm Steel back NL - 22 mm</p> <p>LW - 87 mm</p> <p>LW - 75 mm</p>	<p><math>x = LW - 132</math></p>
<p>KB Cabinet width</p> <p>LW Internal cabinet width</p> <p>NL Nominal length</p>	

## Product



### Description

- With single gallery
- Concealed, guided full extension
- Tool-free front assembly
- 3-dimensional front adjustment
- With integrated BLUMOTION, can be combined with SERVO-DRIVE or with TIP-ON BLUMOTION

## Space requirement

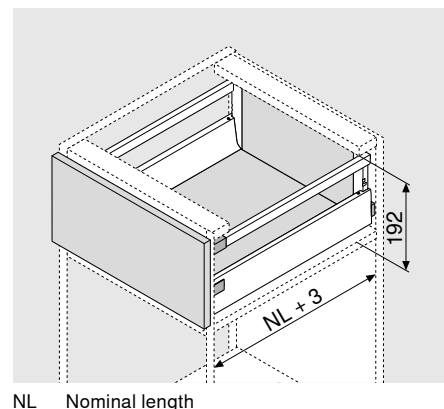

## Ordering information

1	Cabinet profiles left/right		
	Dynamic carrying capacity (kg)		
	Nominal length NL (mm)	BLUMOTION*	
		30 kg	65 kg
	270	578.2701M	
	300	578.3001M	
	350	578.3501M	
	400	578.4001M	
	450	578.4501M	576.4501M
	500	578.5001M	576.5001M
	550	578.5501M	576.5501M
	600	578.6001M	576.6001M
	650		576.6501M
*Suitable for SERVO-DRIVE and TIP-ON BLUMOTION			

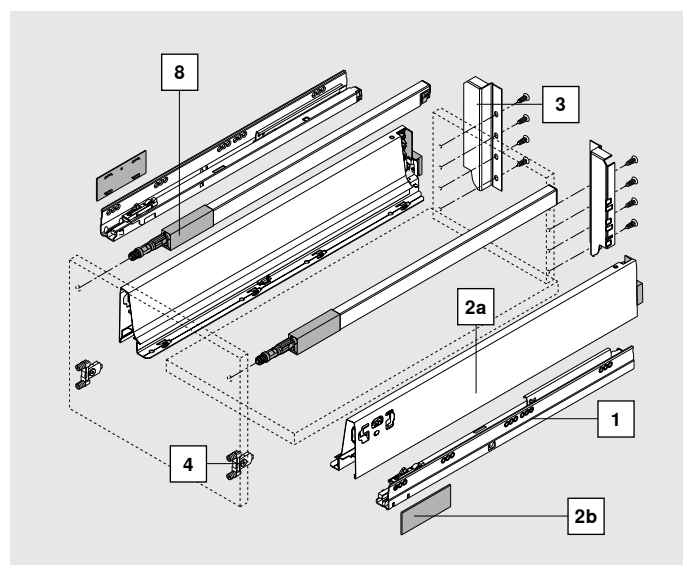

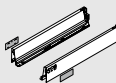
2	Drawer side set		
	Colour options	SW	R9006
	NL (mm)	Steel	
	270	378M2702SA	
	300	378M3002SA	
	350	378M3502SA	
	400	378M4002SA	
	450	378M4502SA	
	500	378M5002SA	
	550	378M5502SA	
	600	378M6002SA	
	650	378M6502SA	
	Consisting of:		
2a	1 x drawer side left/right		
2b	2 x cover cap, stamped with Blum logo, custom printed from 1000 pcs		



## Ordering information

3 Back fixing left/right			
	Colour options	SW	R9006
	Steel	Z30C000S	
	Steel back		79

4 Front fixing bracket			
	INSERTA version	2x	ZSF.39A2
	Screw-on version	2x	ZSF.35A2
	Knock-in version	2x	ZSF.36A2

8 Gallery left/right			
	Colour options	SW	R9006
	NL (mm)	Steel	
	270	ZRG.207RSIC	
	300	ZRG.237RSIC	
	350	ZRG.287RSIC	
	400	ZRG.337RSIC	
	450	ZRG.387RSIC	
	500	ZRG.437RSIC	
	550	ZRG.487RSIC	
	600	ZRG.537RSIC	
	650	ZRG.587RSIC	

## Planning

Space requirements in the cabinet	Front installation dimensions	Drilling distances – front – INSERTA   knock-in assembly	Back installation dimensions
	FA Front overlay		

Cutting dimensions for 16 mm chipboard	
	<b>Drawer back</b> 167 mm
	<b>Base</b> Chipboard back NL - 24 mm Steel back NL - 22 mm
	KB Cabinet width LW Internal cabinet width NL Nominal length

## Product



## Description

- With single gallery
- Concealed, guided full extension
- Tool-free front assembly
- 3-dimensional front adjustment
- With integrated BLUMOTION, can be combined with SERVO-DRIVE or with TIP-ON BLUMOTION

## Space requirement

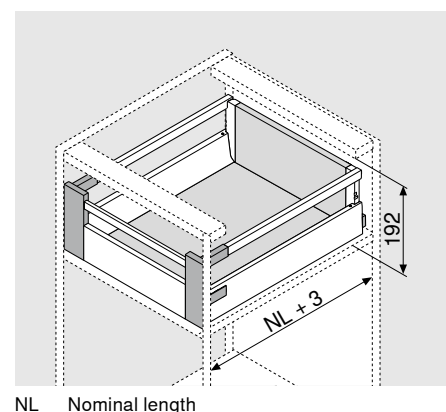

NL Nominal length

## Ordering information

1	Cabinet profiles left/right		
	Dynamic carrying capacity (kg)		
	Nominal length NL (mm)	BLUMOTION*	
		30 kg	65 kg
	270	578.2701M	
	300	578.3001M	
	350	578.3501M	
	400	578.4001M	
	450	578.4501M	576.4501M
	500	578.5001M	576.5001M
	550	578.5501M	576.5501M
	600	578.6001M	576.6001M
	650		576.6501M
*Suitable for SERVO-DRIVE and TIP-ON BLUMOTION			

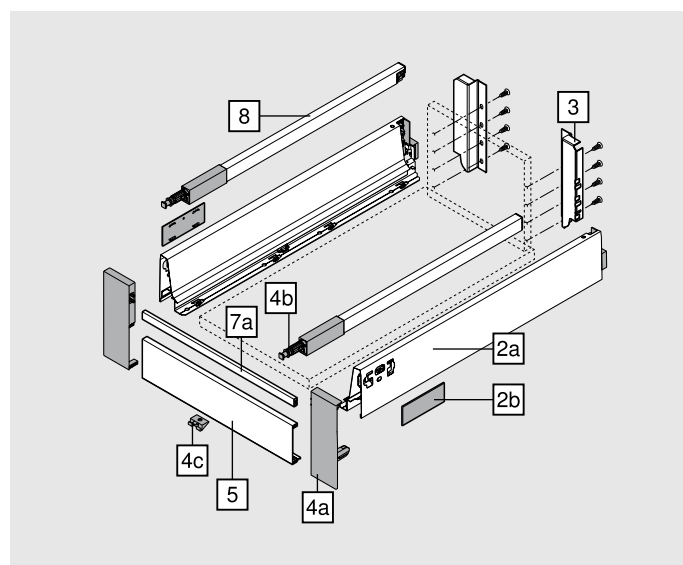

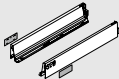
2	Drawer side set		
	Colour options	SW	R9006
	NL (mm)	Steel	
	270	378M2702SA	
	300	378M3002SA	
	350	378M3502SA	
	400	378M4002SA	
	450	378M4502SA	
	500	378M5002SA	
	550	378M5502SA	
	600	378M6002SA	
	650	378M6502SA	
	Consisting of:		
2a	1 x drawer side left/right		
2b	2 x cover cap, stamped with Blum logo, custom printed from 1000 pcs		

## Ordering information

<b>3</b>	<b>Back fixing left/right</b>		
	Colour options	SW	R9006
	Steel	<b>Z30.C000S</b>	
	Steel back		<b>79</b>

<b>7a</b>	<b>Cross gallery</b>		
	Colour options	SW	R9006
	Aluminium	<b>ZRG.1046Z</b>	
	For cutting to size		

<b>4</b>	<b>Front fixing left/right</b>		
	Colour options	SW	WGR
	Nylon	<b>ZIF.74C0</b>	

### Consisting of:

<b>4a</b>	1 x front fixing left/right
<b>4b</b>	2 x gallery head
<b>4c</b>	1 x locking piece

<b>5</b>	<b>Front piece</b>		
	Colour options	SW	R9006
	Aluminium	<b>Z31L1036A</b>	
	For cutting to size		

<b>8</b>	<b>Gallery left/right</b>		
	Colour options	SW	R9006
	NL (mm)	Steel	
	270	<b>ZRG.207RSIC</b>	
	300	<b>ZRG.237RSIC</b>	
	350	<b>ZRG.287RSIC</b>	
	400	<b>ZRG.337RSIC</b>	
	450	<b>ZRG.387RSIC</b>	
	500	<b>ZRG.437RSIC</b>	
	550	<b>ZRG.487RSIC</b>	
	600	<b>ZRG.537RSIC</b>	
	650	<b>ZRG.587RSIC</b>	

## Planning

<b>Space requirements in the cabinet</b> 	<b>Back installation dimensions</b> 	<b>Cutting dimensions for 16 mm chipboard</b> <div style="display: flex; align-items: flex-start;"> <div style="flex: 1;"> <p><b>Drawer back</b> 167 mm LW - 87 mm</p> <p><b>Base</b> Chipboard back NL - 24 mm Steel back NL - 22 mm LW - 75 mm</p> </div> <div style="flex: 1; text-align: center;"> </div> <div style="flex: 1; margin-left: 10px;"> <p>KB Cabinet width LW Internal cabinet width NL Nominal length</p> </div> </div>
--	---	--

<b>Front piece for cutting to size</b> <p><math>x = LW - 132</math></p>	<b>Cross gallery for cutting to size</b> <p><math>x = LW - 122</math></p>
--	--



## High fronted pull-out with aluminium frame

### Product



### Description

- With single gallery
- Concealed, guided full extension
- Tool-free front assembly
- 3-dimensional front adjustment
- With integrated BLUMOTION, can be combined with SERVO-DRIVE or with TIP-ON BLUMOTION

### Space requirement

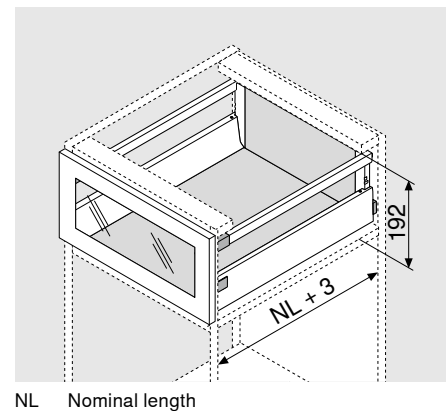

### Ordering information

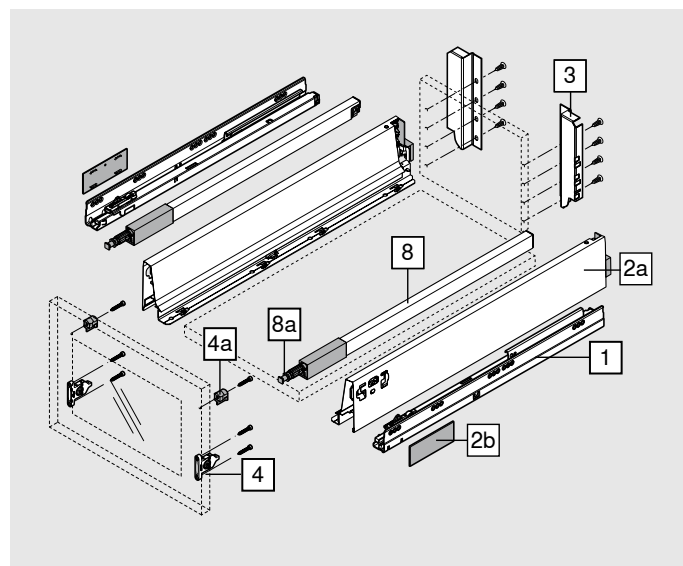

1	Cabinet profiles left/right		
	Dynamic carrying capacity (kg)		
	Nominal length NL (mm)	BLUMOTION*	
		30 kg	65 kg
	270	578.2701M	
	300	578.3001M	
	350	578.3501M	
	400	578.4001M	
	450	578.4501M	576.4501M
	500	578.5001M	576.5001M
	550	578.5501M	576.5501M
	600	578.6001M	576.6001M
	650		576.6501M
*Suitable for SERVO-DRIVE and TIP-ON BLUMOTION			

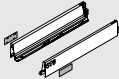

2	Drawer side set		
	Colour options	SW	R9006
	NL (mm)	Steel	
	270	378M2702SA	
	300	378M3002SA	
	350	378M3502SA	
	400	378M4002SA	
	450	378M4502SA	
	500	378M5002SA	
	550	378M5502SA	
	600	378M6002SA	
	650	378M6502SA	
	Consisting of:		
2a	1 x drawer side left/right		
2b	2 x cover cap, stamped with Blum logo, custom printed from 1000 pcs		

## High fronted pull-out with aluminium frame

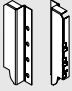
### Ordering information

	<b>3 Back fixing left/right</b>		
	Colour options	SW	R9006
	Steel	<b>Z30.C000S</b>	
	Steel back		<b>79</b>
	<b>4 Front fixing bracket</b>		
	Screw-on version		2x
	<b>ZSF.35A2</b>		
	<b>4a Adapter for aluminium frame, symmetrical</b>		
	Colour options	Natural/white	
	Nylon		2x
	<b>ZRF.2200.01</b>		

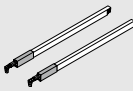
	<b>8 Gallery left/right</b>		
	Colour options	SW	R9006
	NL (mm)	Steel	
	270	<b>ZRG.207RSIC</b>	
	300	<b>ZRG.237RSIC</b>	
	350	<b>ZRG.287RSIC</b>	
	400	<b>ZRG.337RSIC</b>	
	450	<b>ZRG.387RSIC</b>	
	500	<b>ZRG.437RSIC</b>	
	550	<b>ZRG.487RSIC</b>	
	600	<b>ZRG.537RSIC</b>	
	650	<b>ZRG.587RSIC</b>	

	<b>8a Gallery head</b>	
	Colour options	Natural
	2 x nylon	
	<b>ZRG.000R5F</b>	

### Planning

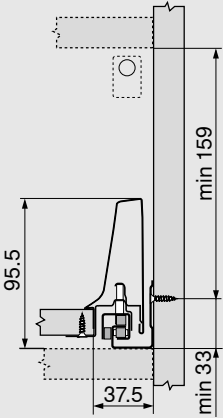
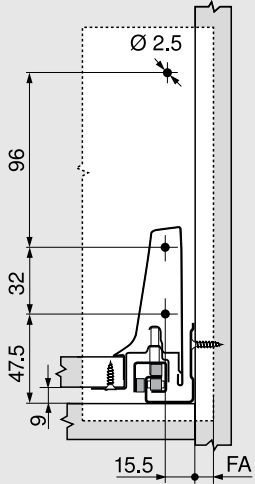
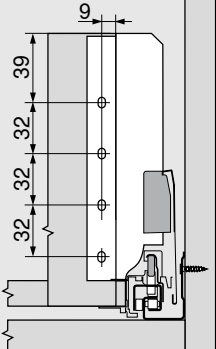
Space requirements in the cabinet	Front installation dimensions	Back installation dimensions
		

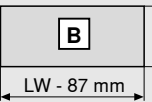
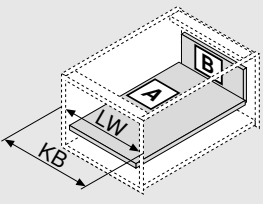
Cutting dimensions for 16 mm chipboard	
	
<b>Drawer back</b> 167 mm	
<b>Base</b> Chipboard back NL - 24 mm Steel back NL - 22 mm	
<b>KB</b> Cabinet width <b>LW</b> Internal cabinet width <b>NL</b> Nominal length	

## Product



## Description

- With single gallery
- Concealed, guided full extension
- Tool-free front assembly
- 3-dimensional front adjustment
- With integrated BLUMOTION, can be combined with SERVO-DRIVE or with TIP-ON BLUMOTION

## Space requirement

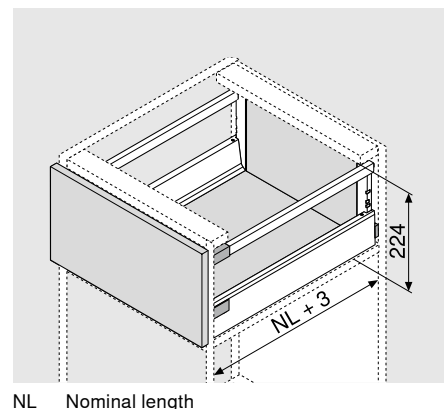

NL Nominal length

## Ordering information

1	Cabinet profiles left/right		
	Dynamic carrying capacity (kg)		
	Nominal length NL (mm)	BLUMOTION*	
		30 kg	65 kg
	270	578.2701M	
	300	578.3001M	
	350	578.3501M	
	400	578.4001M	
	450	578.4501M	576.4501M
	500	578.5001M	576.5001M
	550	578.5501M	576.5501M
	600	578.6001M	576.6001M
	650		576.6501M
*Suitable for SERVO-DRIVE and TIP-ON BLUMOTION			

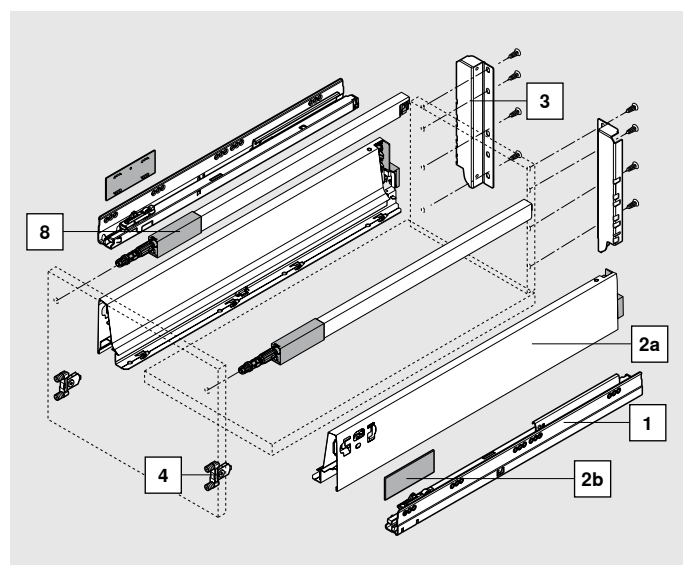

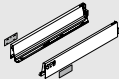
2	Drawer side set		
	Colour options	SW	R9006
	NL (mm)	Steel	
	270	378M2702SA	
	300	378M3002SA	
	350	378M3502SA	
	400	378M4002SA	
	450	378M4502SA	
	500	378M5002SA	
	550	378M5502SA	
	600	378M6002SA	
	650	378M6502SA	
	Consisting of:		
2a	1 x drawer side left/right		
2b	2 x cover cap, stamped with Blum logo, custom printed from 1000 pcs		



## Ordering information

3 Back fixing left/right			
	Colour options	SW	R9006
	Steel	Z30D000SL	
	Steel back		79

4 Front fixing bracket			
	INSERTA version	2x	ZSF.39A2
	Screw-on version	2x	ZSF.35A2
	Knock-in version	2x	ZSF.36A2

8 Gallery left/right			
	Colour options	SW	R9006
	NL (mm)	Steel	
	270	ZRG.207RSIC	
	300	ZRG.237RSIC	
	350	ZRG.287RSIC	
	400	ZRG.337RSIC	
	450	ZRG.387RSIC	
	500	ZRG.437RSIC	
	550	ZRG.487RSIC	
	600	ZRG.537RSIC	
	650	ZRG.587RSIC	

## Planning

Space requirements in the cabinet	Front installation dimensions	Drilling distances – front – INSERTA   knock-in assembly	Back installation dimensions
<p>Diagram showing space requirements in the cabinet with dimensions: 95.5, 37.5, min 33, min 191.</p>	<p>Diagram showing front installation dimensions with dimensions: 128, 32, 47.5, 9, 15.5, 12, Ø 10 <math>\begin{smallmatrix} +0.2 \\ -0.1 \end{smallmatrix}</math>, FA. FA: Front overlay</p>	<p>Diagram showing drilling distances for front installation with dimensions: 128, 32, min 47.5, 32, Ø 10 <math>\begin{smallmatrix} +0.2 \\ -0.1 \end{smallmatrix}</math>, 12.</p>	<p>Diagram showing back installation dimensions with dimensions: 9, 8, 32, 64, 32, 32.</p>

Cutting dimensions for 16 mm chipboard	
<p>Diagram showing cutting dimensions for 16 mm chipboard with dimensions: B, LW - 87 mm, 199 mm.</p>	<p>3D diagram showing cabinet assembly with dimensions: A, B, LW, KB.</p>
<p><b>Base</b></p> <p>Chipboard back</p> <p>NL - 24 mm</p> <p>Steel back</p> <p>NL - 22 mm</p> <p>LW - 75 mm</p>	<p>KB Cabinet width</p> <p>LW Internal cabinet width</p> <p>NL Nominal length</p>

## Product



## Description

- With single gallery
- Concealed, guided full extension
- Tool-free front assembly
- 3-dimensional front adjustment
- With integrated BLUMOTION, can be combined with SERVO-DRIVE or with TIP-ON BLUMOTION

## Space requirement

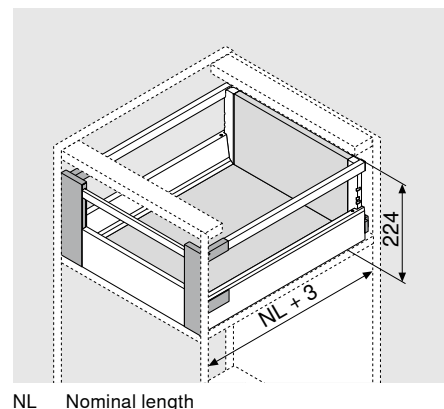

## Ordering information

1	Cabinet profiles left/right		
	Dynamic carrying capacity (kg)		
	Nominal length NL (mm)	BLUMOTION*	
		30 kg	65 kg
	270	578.2701M	
	300	578.3001M	
	350	578.3501M	
	400	578.4001M	
	450	578.4501M	576.4501M
	500	578.5001M	576.5001M
	550	578.5501M	576.5501M
	600	578.6001M	576.6001M
	650		576.6501M
*Suitable for SERVO-DRIVE and TIP-ON BLUMOTION			

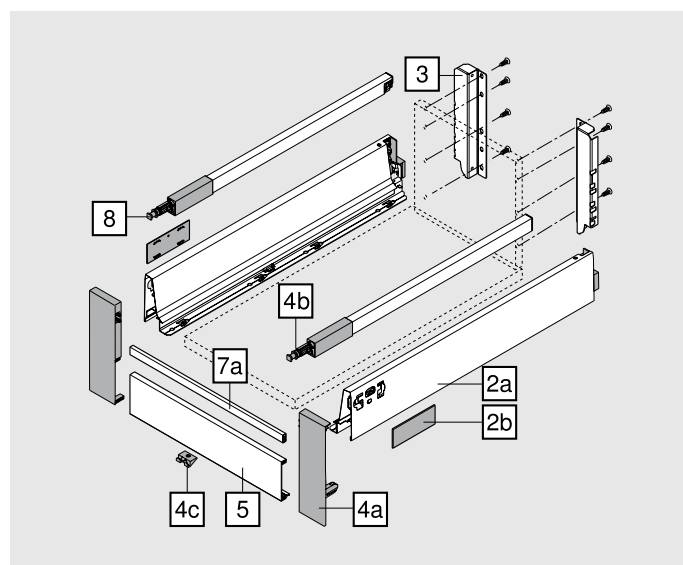

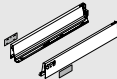
2	Drawer side set		
	Colour options	SW	R9006
	NL (mm)	Steel	
	270	378M2702SA	
	300	378M3002SA	
	350	378M3502SA	
	400	378M4002SA	
	450	378M4502SA	
	500	378M5002SA	
	550	378M5502SA	
	600	378M6002SA	
	650	378M6502SA	
	Consisting of:		
2a	1 x drawer side left/right		
2b	2 x cover cap, stamped with Blum logo, custom printed from 1000 pcs		

## Ordering information

3	Back fixing left/right		
	Colour options	SW	R9006
	Steel	Z30D000SL	
	Steel back	79	

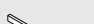
7a	Cross gallery		
	Colour options	SW	R9006
	Aluminium	ZRG.1046Z	
	For cutting to size		

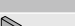
4	Front fixing left/right		
	Colour options	SW	WGR
	Nylon		
			ZIF.74D0

### Consisting of:

4a	1 x front fixing left/right
4b	2 x gallery head
4c	1 x locking piece

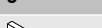
5	Front piece		
	Colour options	SW	R9006
	Aluminium	Z31L1036A	
	For cutting to size		

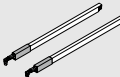
8	Gallery left/right		
	Colour options	SW	R9006
	NL (mm)	Steel	
	270	ZRG.207RSIC	
	300	ZRG.237RSIC	
	350	ZRG.287RSIC	
	400	ZRG.337RSIC	
	450	ZRG.387RSIC	
	500	ZRG.437RSIC	
	550	ZRG.487RSIC	
	600	ZRG.537RSIC	
	650	ZRG.587RSIC	

## Planning

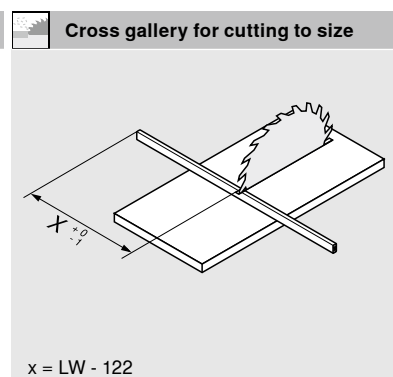
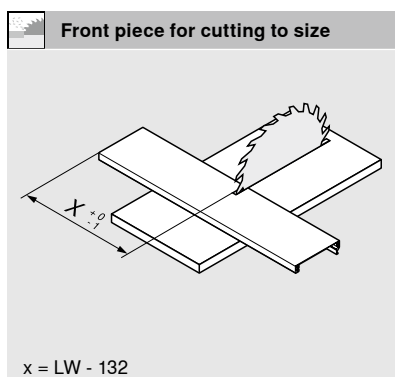
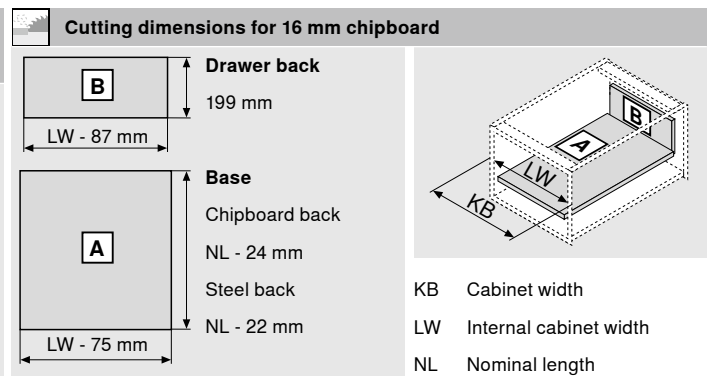
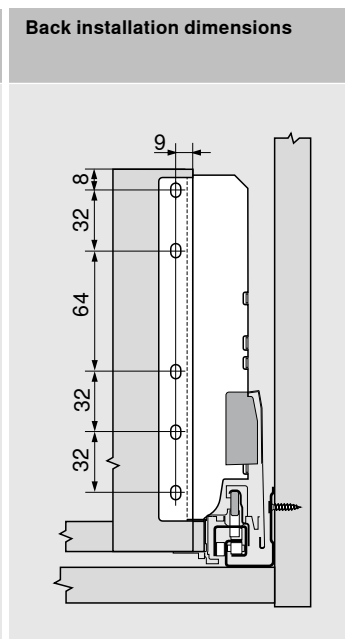
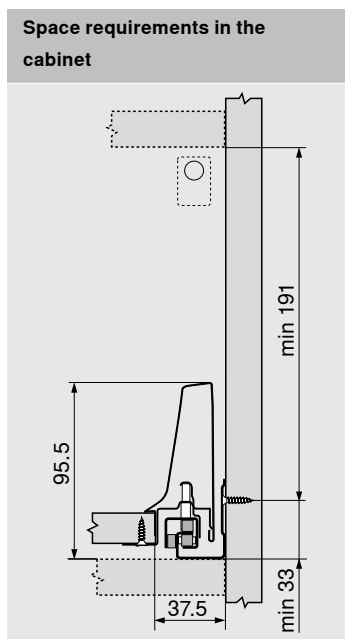



## Product



## Description

- With single gallery
- Concealed, guided full extension
- Tool-free front assembly
- 3-dimensional front adjustment
- With integrated BLUMOTION, can be combined with SERVO-DRIVE or with TIP-ON BLUMOTION

## Space requirement

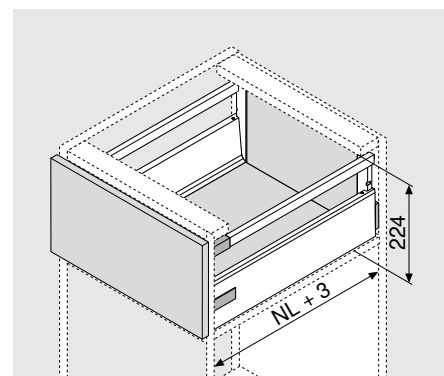

NL Nominal length

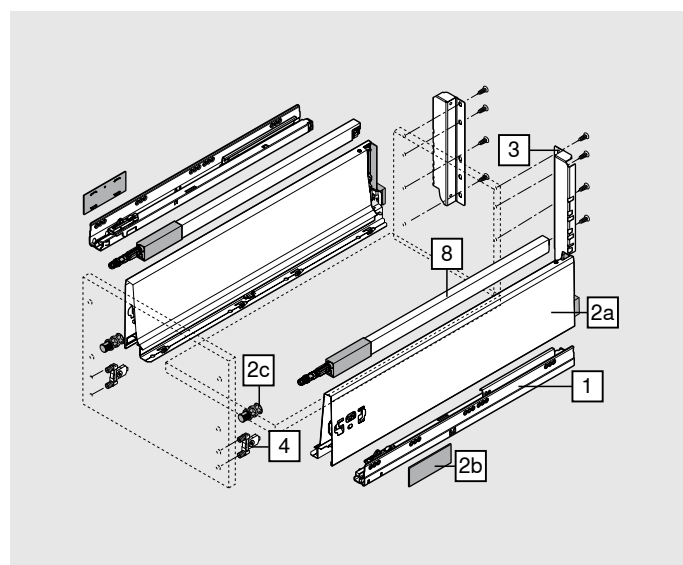

## Ordering information

1	Cabinet profiles left/right		
	Nominal length NL (mm)	BLUMOTION*	
		30 kg	65 kg
	270	578.2701M	
	300	578.3001M	
	350	578.3501M	
	400	578.4001M	
	450	578.4501M	576.4501M
	500	578.5001M	576.5001M
	550	578.5501M	576.5501M
	600	578.6001M	576.6001M
	650		576.6501M
*Suitable for SERVO-DRIVE and TIP-ON BLUMOTION			

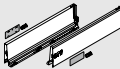

2	Drawer side set		
	Colour options	SW	WGR
	NL (mm)	Steel	
	270	378K2702SA	
	300	378K300SA	
	350	378K350SA	
	400	378K400SA	
	450	378K450SA	
	500	378K500SA	
	550	378K550SA	
	600	378K600SA	
	650	378K650SA	
Consisting of:			
2a	1 x drawer side left/right		
2b	2 x cover cap, stamped with Blum logo, custom printed from 1000 pcs		
2c	2 x positioning dowel		

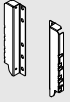
## Ordering information

3 Back fixing left/right			
	Colour options	SW	WGR
	Steel	Z30D000SL	
	Steel back		79
4 Front fixing bracket			
	INSERTA version	2x	ZSF.39A2
	Screw-on version	2x	ZSF.35A2
	Knock-in version	2x	ZSF.36A2
Front/base stabiliser			
	Stabilises wide and high fronts. Reinforces the connection between the drawer side and the front.		
	Z96.10E1		
	Planning		81

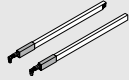
8 Gallery left/right			
	Colour options	SW	WGR
	NL (mm)	Steel	
	270	ZRG.207RSIC	
	300	ZRG.237RSIC	
	350	ZRG.287RSIC	
	400	ZRG.337RSIC	
	450	ZRG.387RSIC	
	500	ZRG.437RSIC	
	550	ZRG.487RSIC	
	600	ZRG.537RSIC	
	650	ZRG.587RSIC	

## Planning

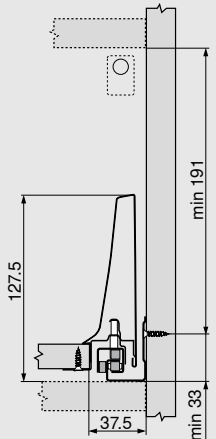
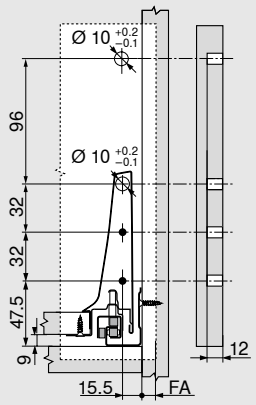
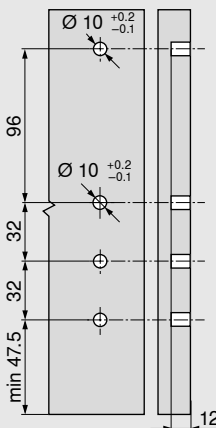
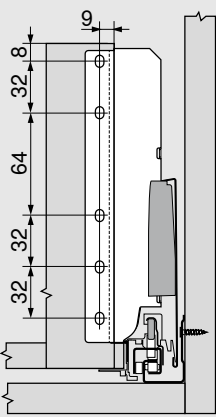
Space requirements in the cabinet	Front installation dimensions	Drilling distances – front – INSERTA   knock-in assembly	Back installation dimensions
	 FA Front overlay		

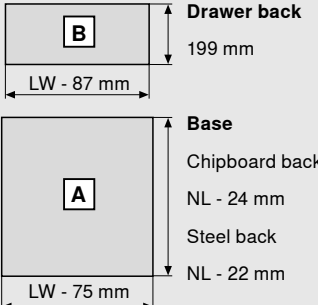
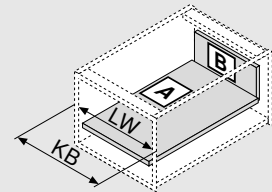
Cutting dimensions for 16 mm chipboard	
	
<b>Drawer back</b> 199 mm LW - 87 mm	KB Cabinet width
<b>Base</b> Chipboard back NL - 24 mm Steel back NL - 22 mm LW - 75 mm	LW Internal cabinet width
	NL Nominal length

## Product



## Description

- With single gallery
- Concealed, guided full extension
- Tool-free front assembly
- 3-dimensional front adjustment
- With integrated BLUMOTION, can be combined with SERVO-DRIVE or with TIP-ON BLUMOTION

## Space requirement

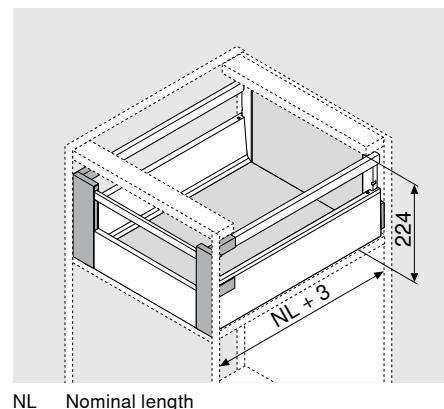

## Ordering information

1	Cabinet profiles left/right		
	Nominal length NL (mm)	BLUMOTION*	
		30 kg	65 kg
	270	578.2701M	
	300	578.3001M	
	350	578.3501M	
	400	578.4001M	
	450	578.4501M	576.4501M
	500	578.5001M	576.5001M
	550	578.5501M	576.5501M
	600	578.6001M	576.6001M
	650		576.6501M

\*Suitable for SERVO-DRIVE and TIP-ON BLUMOTION

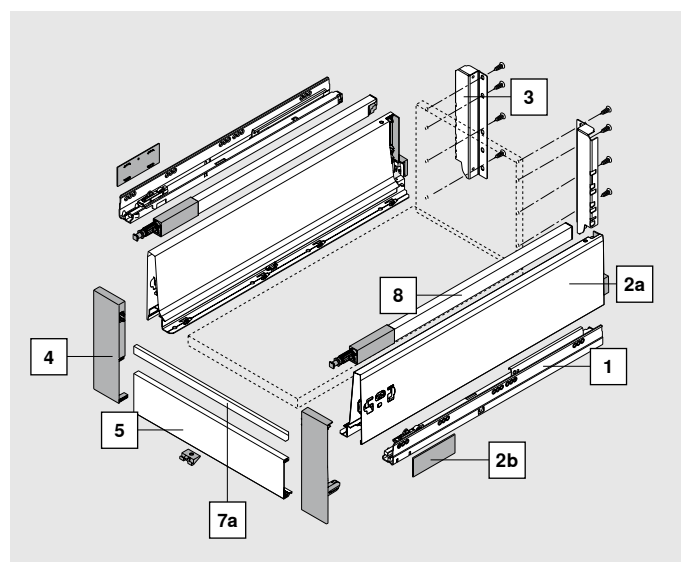

2	Drawer side set	
	Colour options	SW WGR
	NL (mm)	Steel
	270	378K2702SA
	300	378K3002SA
	350	378K3502SA
	400	378K4002SA
	450	378K4502SA
	500	378K5002SA
	550	378K5502SA
	600	378K6002SA
	650	378K6502SA

Consisting of:

2a	1 x drawer side left/right
2b	2 x cover cap, stamped with Blum logo, custom printed from 1000 pcs
2c	2 x positioning dowel

## Ordering information

3	Back fixing left/right		
	Colour options	SW	R9006
	Steel	Z30D000SL	
	Steel back		79

7a	Cross gallery		
	Colour options	SW	R9006
	Aluminium	ZRG.1046Z	
	For cutting to size		

4	Front fixing left/right		
	Colour options	SW	WGR
	Nylon	ZIF.74D0	

### Consisting of:

4a	1 x front fixing left/right
4b	2 x gallery head
4c	1 x locking piece

5	Front piece		
	Colour options	SW	R9006
	Aluminium	Z31L1036A	
	For cutting to size		

8	Gallery left/right		
	Colour options	SW	WGR
	NL (mm)	Steel	
	270	ZRG.207RSIC	
	300	ZRG.237RSIC	
	350	ZRG.287RSIC	
	400	ZRG.337RSIC	
	450	ZRG.387RSIC	
	500	ZRG.437RSIC	
	550	ZRG.487RSIC	
	600	ZRG.537RSIC	
	650	ZRG.587RSIC	

## Planning

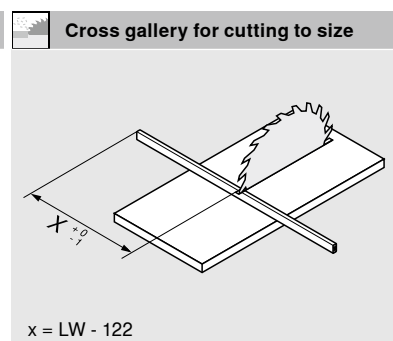
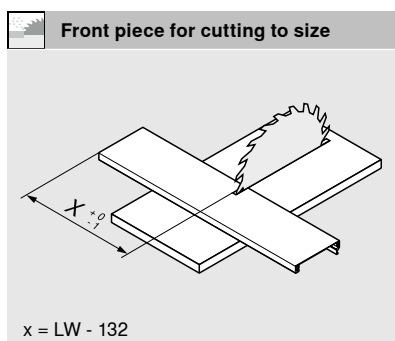
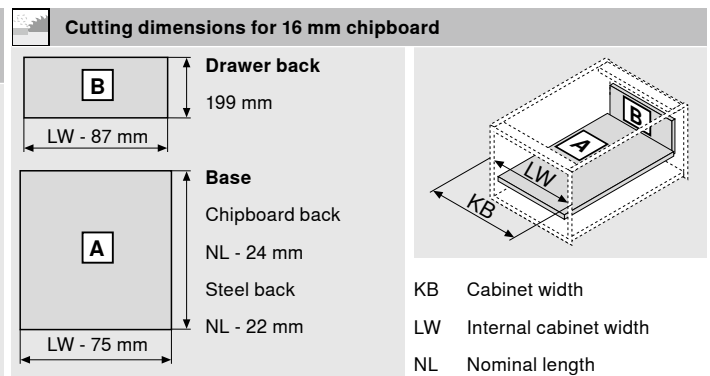
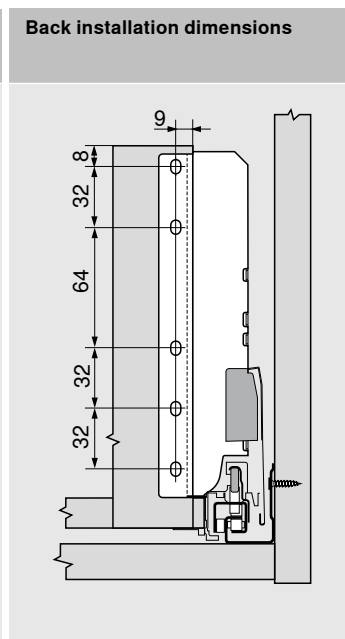
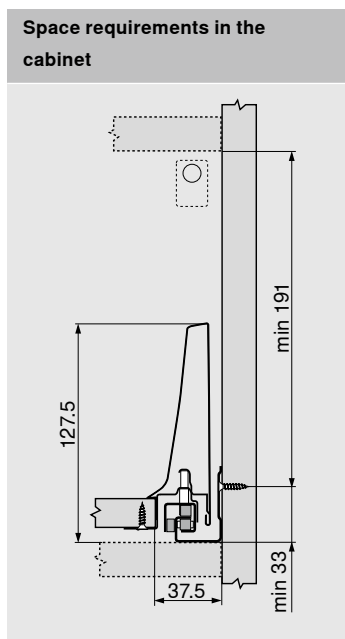



## High fronted pull-out with aluminium frame

### Product



### Description

- With single gallery
- Concealed, guided full extension
- Tool-free front assembly
- 3-dimensional front adjustment
- With integrated BLUMOTION, can be combined with SERVO-DRIVE or with TIP-ON BLUMOTION

### Space requirement

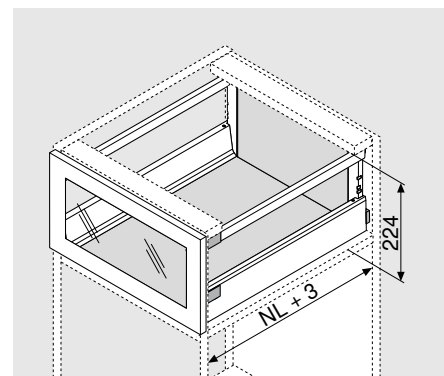

NL Nominal length

### Ordering information

1	Cabinet profiles left/right		
	Dynamic carrying capacity (kg)		
	Nominal length NL (mm)	BLUMOTION*	
		30 kg	65 kg
	270	578.2701M	
	300	578.3001M	
	350	578.3501M	
	400	578.4001M	
	450	578.4501M	576.4501M
	500	578.5001M	576.5001M
	550	578.5501M	576.5501M
	600	578.6001M	576.6001M
	650		576.6501M
*Suitable for SERVO-DRIVE and TIP-ON BLUMOTION			

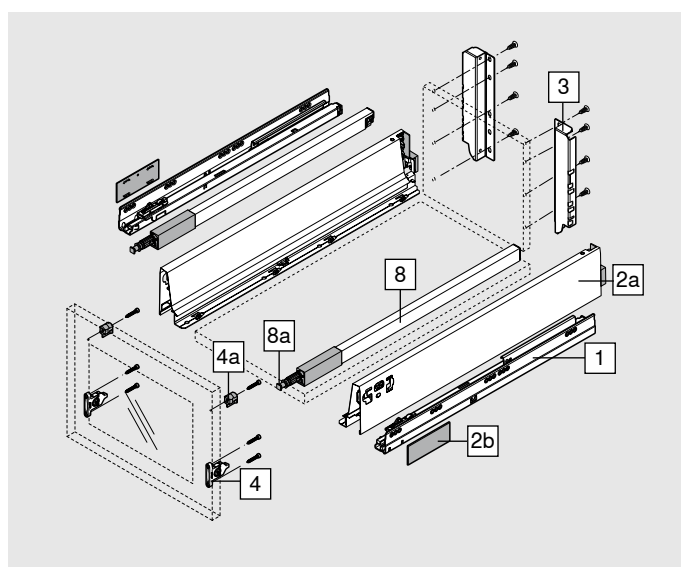

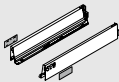
2	Drawer side set		
	Colour options	SW	R9006
	NL (mm)	Steel	
	270	378M2702SA	
	300	378M3002SA	
	350	378M3502SA	
	400	378M4002SA	
	450	378M4502SA	
	500	378M5002SA	
	550	378M5502SA	
	600	378M6002SA	
	650	378M6502SA	
	Consisting of:		
2a	1 x drawer side left/right		
2b	2 x cover cap, stamped with Blum logo, custom printed from 1000 pcs		

## High fronted pull-out with aluminium frame

### Ordering information

3	Back fixing left/right			
	Colour options	SW	R9006	
	Steel	Z30D000S		
	Steel back			79

4	Front fixing bracket		
	Screw-on version		2x
	ZSF.35A2		

4d	Adapter for aluminium frame, symmetrical		
	Colour options		Natural/white
	2x	Nylon	
	ZRF.2200.01		

8	Gallery left/right		
	Colour options	SW	R9006
	NL (mm)	Steel	
	270	ZRG.207RSIC	
	300	ZRG.237RSIC	
	350	ZRG.287RSIC	
	400	ZRG.337RSIC	
	450	ZRG.387RSIC	
	500	ZRG.437RSIC	
	550	ZRG.487RSIC	
	600	ZRG.537RSIC	
	650	ZRG.587RSIC	

8a	Gallery head	
	Colour options	Natural
	2 x nylon	
	ZRG.000R5F	

### Planning

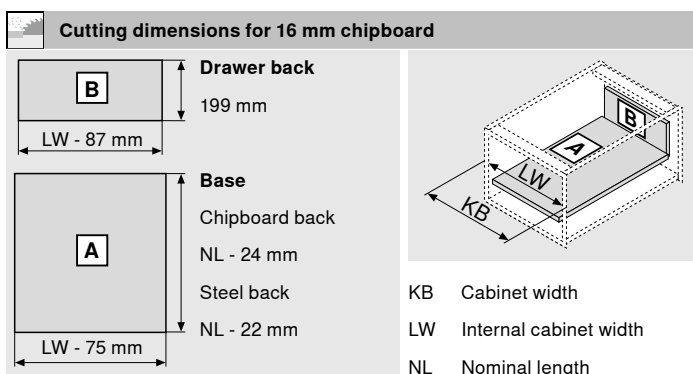
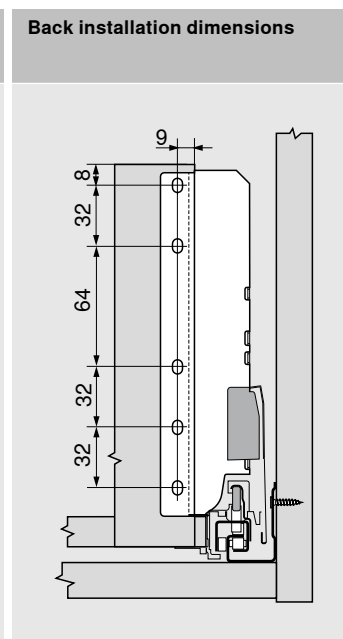
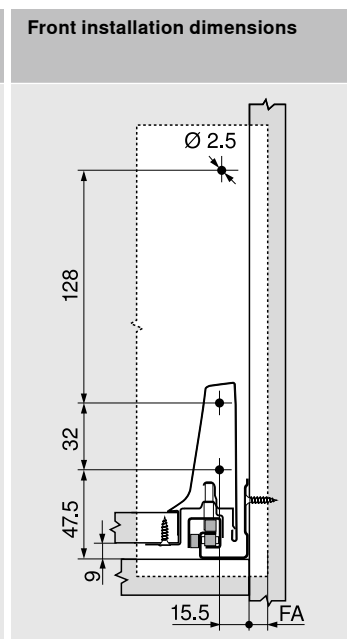
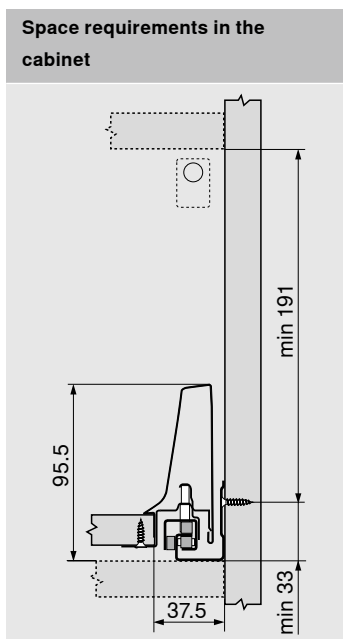

## Product



## Description

- Can be implemented with standard components
- With single gallery
- Concealed, guided full extension
- Tool-free front assembly
- 3-dimensional front adjustment
- With integrated BLUMOTION, can be combined with SERVO-DRIVE or with TIP-ON BLUMOTION

## Space requirement

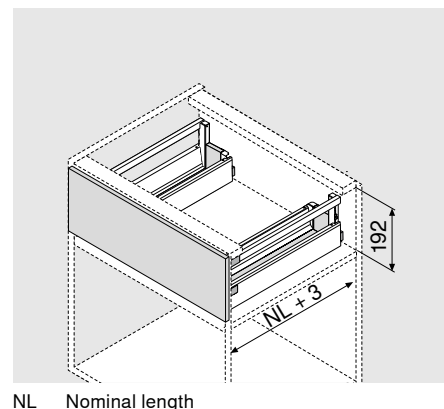

NL Nominal length

## Ordering information

1	Cabinet profiles left/right		
	Dynamic carrying capacity (kg)		
	Nominal length NL (mm)	BLUMOTION*	
		30 kg	65 kg
	270	578.2701M	
	300	578.3001M	
	350	578.3501M	
	400	578.4001M	
	450	578.4501M	576.4501M
	500	578.5001M	576.5001M
	550	578.5501M	576.5501M
	600	578.6001M	576.6001M
	650		576.6501M
*Suitable for SERVO-DRIVE and TIP-ON BLUMOTION			

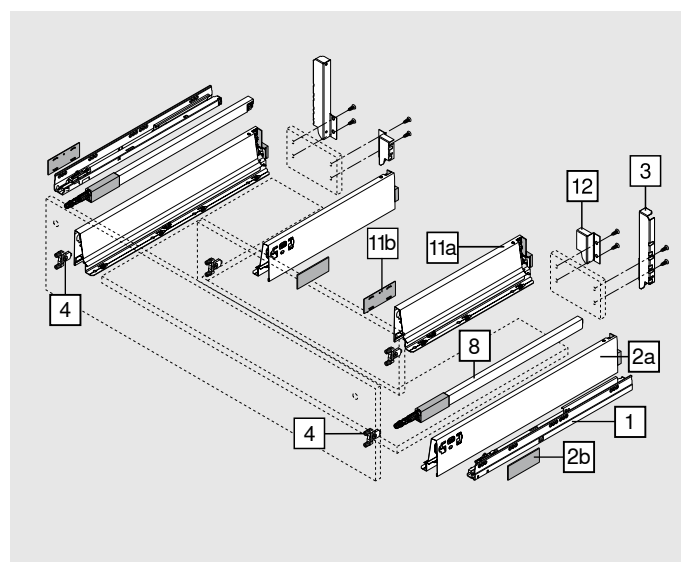

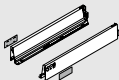
	Outer drawer side set		
	Colour options	SW	R9006
	NL (mm)	Steel	
	450	378M4502SA	
	500	378M5002SA	
	550	378M5502SA	
	600	378M6002SA	
	650	378M6502SA	
Consisting of:			
2a	1 x drawer side left/right		
2b	2 x cover cap, stamped with Blum logo, custom printed from 1000 pcs		

4	Front fixing bracket		
	INSERTA version	4x	ZSF.39A2
	Screw-on version	4x	ZSF.35A2
	Knock-in version	4x	ZSF.36A2

12	Back fixing left/right		
	Colour options	SW	R9006
	Steel	Z30M000S.04	
	Steel back	79	

	Front/base stabiliser		
	Stabilises wide and high fronts. Reinforces the connection between the drawer side and the front.		
	Z96.10E1		
	Planning	81	

3	Back fixing left/right		
	Colour options	SW	R9006
	Steel	Z30C000S.22	
	Steel back	79	

## Ordering information

8	Gallery left/right		
	Colour options	SW	WGR
	NL (mm)	Steel	
	270	ZRG.207RSIC	
	300	ZRG.237RSIC	
	350	ZRG.287RSIC	
	400	ZRG.337RSIC	
	450	ZRG.387RSIC	
	500	ZRG.437RSIC	
	550	ZRG.487RSIC	
	600	ZRG.537RSIC	
	650	ZRG.587RSIC	

11a	Inner drawer side set		
	Colour options	SW	R9006
	NL (mm)	Steel	
	270	378M270SA	
	300	378M300SA	
	350	378M350SA	
	400	378M400SA	
	450	378M450SA	
	500	378M500SA	

### Consisting of:

- 2a** 1 x drawer side left/right
- 2b** 2 x cover cap, stamped with Blum logo, custom printed from 1000 pcs

**For effective use of storage space, we recommend:** Nominal length NL of outer drawer side (no 2) - nominal length NL of inner drawer side (no 11) = min. 150 mm

## Planning

### Space requirements in the cabinet

### Front installation dimensions

FA Front overlay

### Drilling distances – front – INSERTA | knock-in assembly

### Back installation dimensions

### Cutting dimensions for 16 mm chipboard

**Drawer back**  
84 mm

**Drawer base**  
Chipboard back  
NL - 24 mm

**Centre piece**  
71 mm

Y min. BLUMOTION = 48 mm  
Y min. TIP-ON BLUMOTION = 75 mm  
Y max. = 225 mm

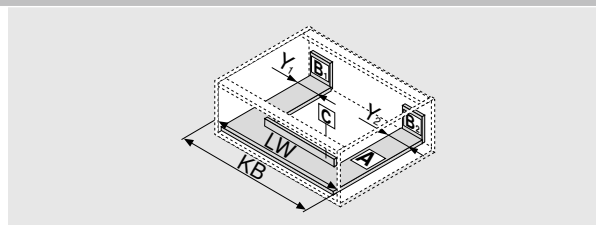

- KB Cabinet width
- LW Internal cabinet width
- NL Nominal length
- SPW Internal width between sink drawer sides

$$X = NL \text{ outer drawer side} - NL \text{ inner drawer side} - 10 \text{ mm}$$

### Drilling distances – centre piece

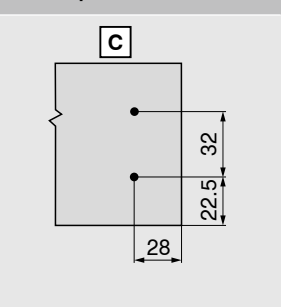



## Product



## Description

- With single gallery
- Concealed, guided full extension
- Tool-free front assembly
- 3-dimensional front adjustment
- With integrated BLUMOTION, can be combined with SERVO-DRIVE or with TIP-ON BLUMOTION

## Space requirement

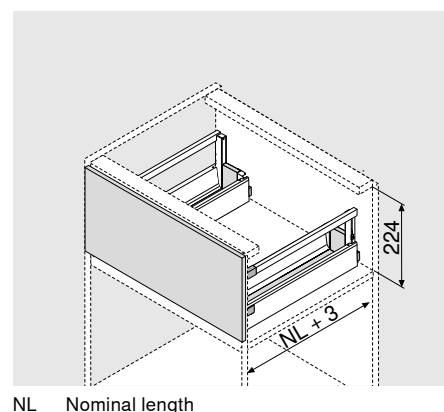

NL Nominal length

## Ordering information

1	Cabinet profiles left/right		
	Dynamic carrying capacity (kg)		
	Nominal length NL (mm)	BLUMOTION*	
		30 kg	65 kg
	270	578.2701M	
	300	578.3001M	
	350	578.3501M	
	400	578.4001M	
	450	578.4501M	576.4501M
	500	578.5001M	576.5001M
	550	578.5501M	576.5501M
	600	578.6001M	576.6001M
	650		576.6501M
*Suitable for SERVO-DRIVE and TIP-ON BLUMOTION			

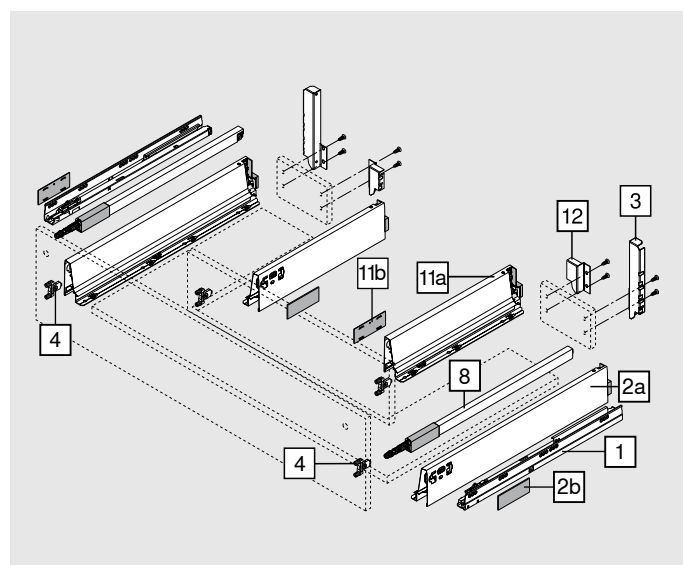

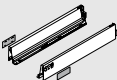
2	Outer drawer side set		
	Colour options	SW	R9006
	NL (mm)	Steel	
	450	378M4502SA	
	500	378M5002SA	
	550	378M5502SA	
	600	378M6002SA	
	650	378M6502SA	
Consisting of:			
2a	1 x drawer side left/right		
2b	2 x cover cap, stamped with Blum logo, custom printed from 1000 pcs		

4	Front fixing bracket		
	INSERTA version	4x	ZSF.39A2
	Screw-on version	4x	ZSF.35A2
	Knock-in version	4x	ZSF.36A2

12	Back fixing left/right		
	Colour options	SW	R9006
	Steel	Z30M000S.04	
	Steel back	79	

	Front/base stabiliser		
	Stabilises wide and high fronts. Reinforces the connection between the drawer side and the front.		
	Z96.10E1		
	Planning	81	

3	Back fixing left/right		
	Colour options	SW	R9006
	Steel	Z30D000SL	
	Steel back	79	

## Ordering information

8	Gallery left/right		
	Colour options	SW	WGR
	NL (mm)	Steel	
	270	ZRG.207RSIC	
	300	ZRG.237RSIC	
	350	ZRG.287RSIC	
	400	ZRG.337RSIC	
	450	ZRG.387RSIC	
	500	ZRG.437RSIC	
	550	ZRG.487RSIC	
	600	ZRG.537RSIC	
	650	ZRG.587RSIC	

11a	Inner drawer side set		
	Colour options	SW	R9006
	NL (mm)	Steel	
	270	378M270SA	
	300	378M300SA	
	350	378M350SA	
	400	378M400SA	
	450	378M450SA	
	500	378M500SA	

### Consisting of:

2a 1 x drawer side left/right

2b 2 x cover cap, stamped with Blum logo, custom printed from 1000 pcs

**For effective use of storage space, we recommend:** Nominal length NL of outer drawer side (no 2) - nominal length NL of inner drawer side (no 11) = min. 150 mm

## Planning

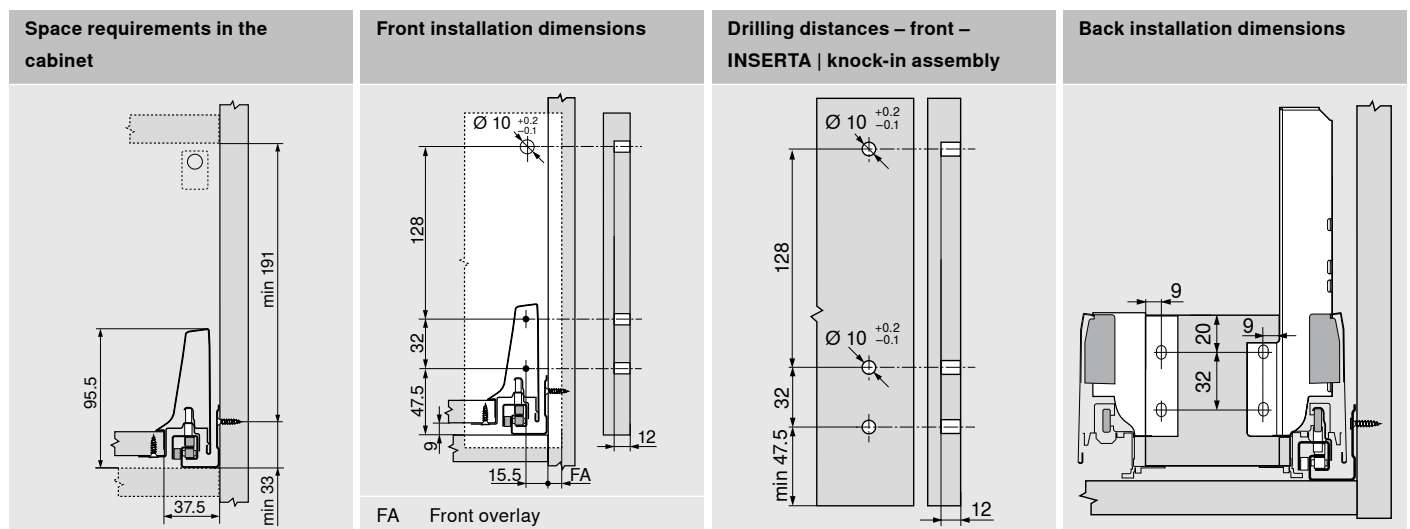

### Cutting dimensions for 16 mm chipboard

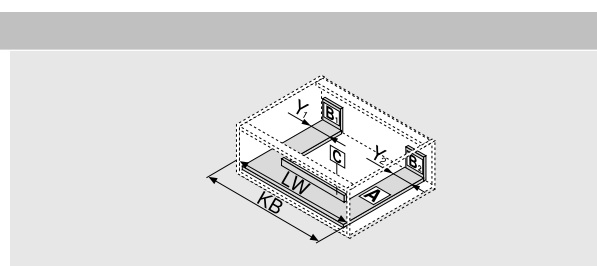
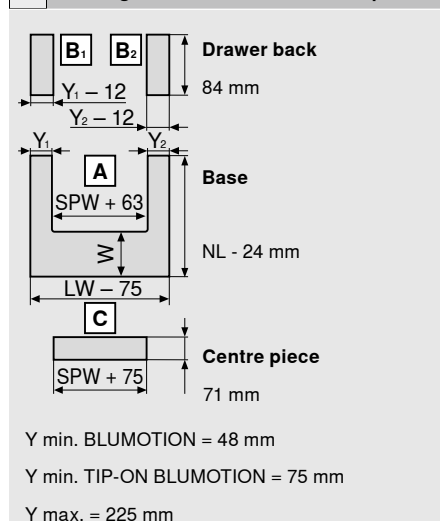

KB Cabinet width  
LW Internal cabinet width  
NL Nominal length  
SPW Internal width between sink drawer sides

$X = NL \text{ outer drawer side} - NL \text{ inner drawer side} - 10 \text{ mm}$

### Drilling distances – centre piece

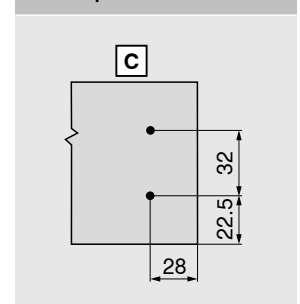

# TIP-ON BLUMOTION

## TANDEMBOX TIP-ON BLUMOTION cabinet profile



- TIP-ON mechanical opening support system combined with BLUMOTION for soft and effortless closing
- Front gap 2.5 mm
- Four-dimensional front adjustment
- Extensive trigger range
- Synchronised feather-light glide
- Synchronisation for internal cabinet widths (LW) of 238 mm or more

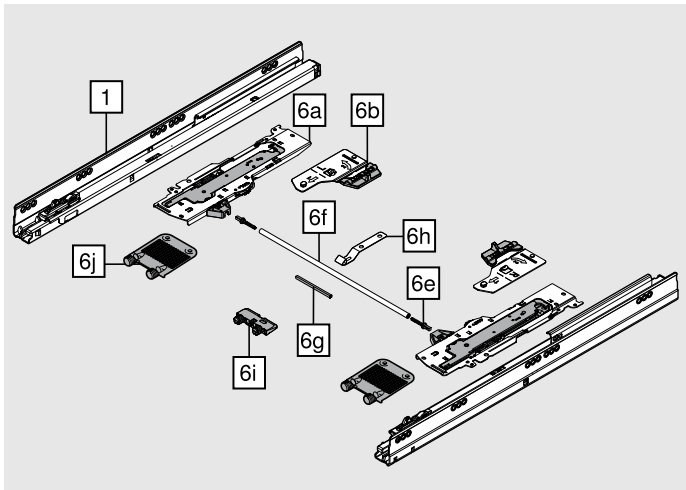

1	Cabinet profiles left/right		
	For TIP-ON BLUMOTION		
	Nominal length (mm)	30 kg	65 kg
	270	578.2701M	
	300	578.3001M	
	350	578.3501M	
	400	578.4001M	
	450	578.4501M	576.4501M
	500	578.5001M	576.5001M
	550	578.5501M	576.5501M
	600	578.6001M	576.6001M
	650		576.6501M

## TIP-ON BLUMOTION

### Ordering information

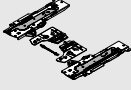
6 TIP-ON BLUMOTION set					
	NL (mm)	Unit	Cabinet profile (kg)	Weight (kg)	
	270–300	S0	30	≤ 10	<b>T60B3030</b>
	270–300	S1	30	> 10–20	<b>T60B3130</b>
	350–600	L1	30	≤ 20	<b>T60B3330</b>
	350–600	L3	30	15–40	<b>T60B3530</b>
	450–650	L5	65	35–65	<b>T60B3560</b>
Consisting of:					
<b>6a</b>	1x	TIP-ON BLUMOTION unit left/right			
<b>6b</b>	1x	TIP-ON BLUMOTION latch left/right			
<b>6e</b>	2x	TIP-ON BLUMOTION synchronisation adapter			
	<sup>1</sup>	Recommended weight ranges (total weight of the pull-out) for an optimum opening and closing function			
	<sup>2</sup>	Can only be combined with a 30 kg cabinet profile			
	<sup>3</sup>	Recommendation: Only use in combination with a 65 kg cabinet profile			

#### Internal cabinet width LW ≥ 287 mm

6f TIP-ON BLUMOTION synchronisation linkage			
	Version	Colour	
	Round	Grey	<b>T60.1125W</b>
In combination with 6e 2 x T60.000D			
Suitable up to internal cabinet width LW 1370 mm			
Note			
To optimise the function and trigger range, we generally recommend using synchronisation			
Cutting	Internal cabinet width LW - 240 mm		

#### Internal cabinet width LW 238–286 mm

6g TIP-ON BLUMOTION synchronisation			
	Version	Colour	
	Square	R7035	<b>T60.300D</b>
Cutting	Internal cabinet width LW - 214 mm		

### Accessories

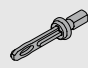
6e TIP-ON BLUMOTION synchronisation adapter			
	Version	Colour	
	Symmetrical	R7035	<b>T60.000D</b>
Internal cabinet width LW ≥ 287 mm			

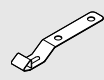
6h TIP-ON BLUMOTION synchronisation linkage fixing			
	Cabinet width KB (mm)	Material	
	≥ 750	Steel	<b>T60B000H</b>
For pull-outs over a cabinet base or cross member			
Prevents the TIP-ON BLUMOTION synchronisation linkage from sagging			

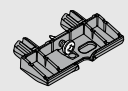
6i Base support bracket			
	Cabinet width KB (mm)	Colour	
	≥ 750	RAL 7037	<b>Z96.2011</b>
For pull-outs over a cabinet base or cross member			
Prevents the TIP-ON BLUMOTION synchronisation linkage from sagging			

6j Front/base stabiliser			
	Material	Colour	
	Nylon	R7037	2x <b>Z96.10E1</b>

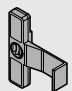
- TIP-ON BLUMOTION checking/setting template			
	Front gap FS (mm)	Colour	
	2.5	Orange	<b>65.5627</b>



## TIP-ON BLUMOTION

### Space requirements in the cabinet

#### Drawer | High fronted pull-out

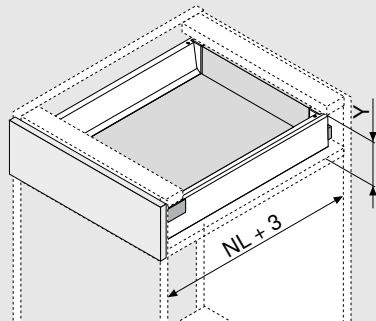

Back height	Y (mm)
N	85.5
M	101.5
K	133.5
B	161
C	195
D	227
NL Nominal length	

#### Inner drawer | Inner pull-out

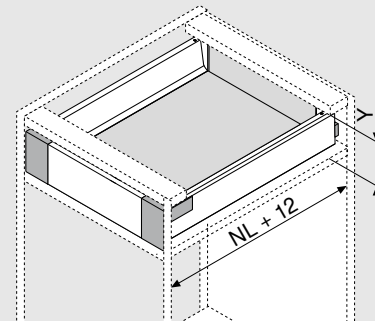

Back height	Y (mm)
M	109
K	139.5
B	161
C	195
D	227
NL Nominal length	

### Space requirements in the cabinet

#### Drawer | High fronted pull-out

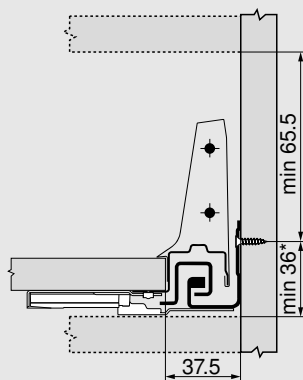

Height M

#### Inner drawer | Inner pull-out

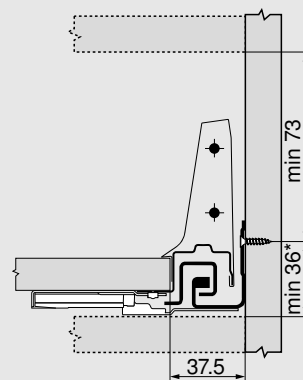

\* For 36-39 mm and a cabinet width KB of  $\geq 750$  you require a fixing, TIP-ON BLUMOTION synchronisation and a base support bracket to prevent the synchronisation linkage from colliding with the cabinet base or the cross member

A trial application is recommended

TIP-ON BLUMOTION

Screw position – inner drawer | inner pull-out

Option 1

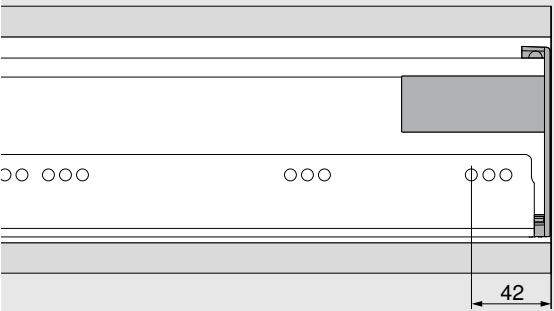

Option 2

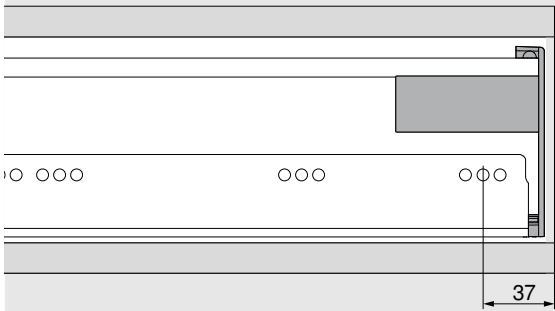

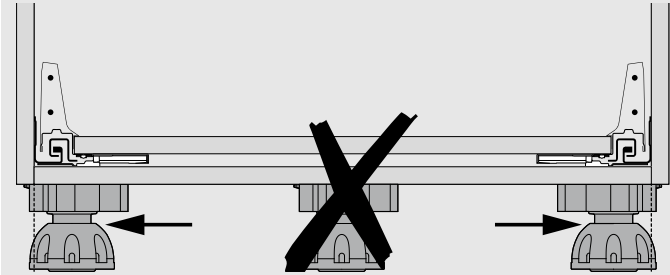

Plinth leg

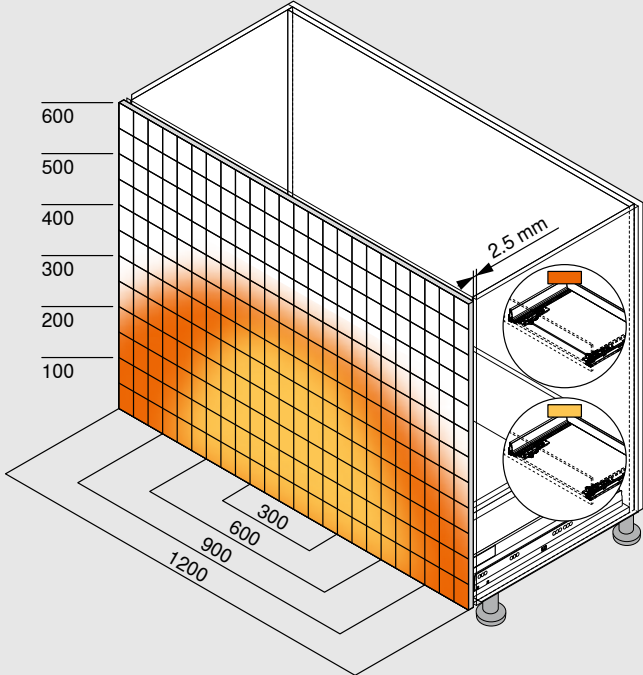

Trigger range



	With synchronisation
	Without synchronisation

Minimum front gap (mm)	2.5
With front/base stabiliser	
To optimise the function and trigger range, we generally recommend using synchronisation	
Example for 578 – 30 kg   576 – 65 kg, height D, nominal length NL 500 mm	

## TIP-ON BLUMOTION

### TIP-ON BLUMOTION synchronisation linkage fixing

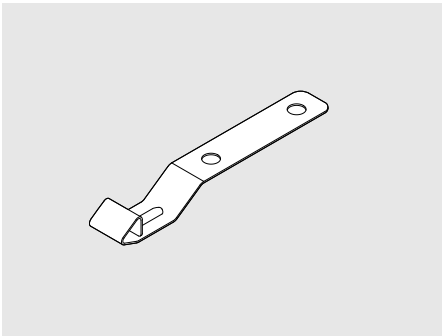

- Prevents the TIP-ON BLUMOTION synchronisation linkage from sagging
- For pull-outs over a cabinet base or cross member
- Required for cabinet widths KB of  $\geq 750$  mm
- Material: Steel

#### Ordering information

**TIP-ON BLUMOTION synchronisation linkage fixing**

**T60B000H**

#### Drilling distance – drawer base

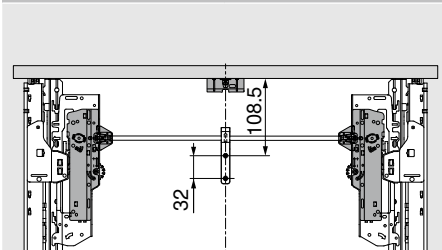

Nominal length (mm)	TIP-ON BLUMOTION unit
270–300	S0   S1

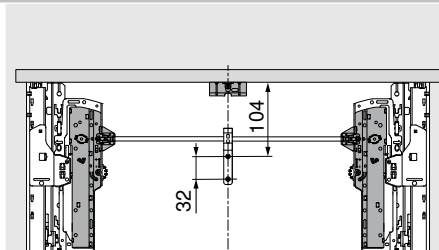

Nominal length (mm)	TIP-ON BLUMOTION unit
350–650	L1   L3   L5

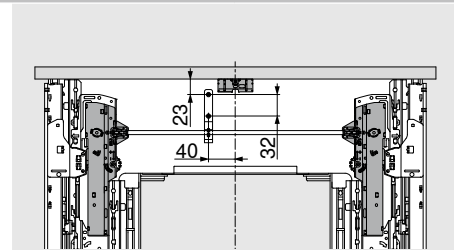

#### Sink cabinet

Nominal length (mm)	TIP-ON BLUMOTION unit
450–650	L1   L3   L5

### Base support bracket

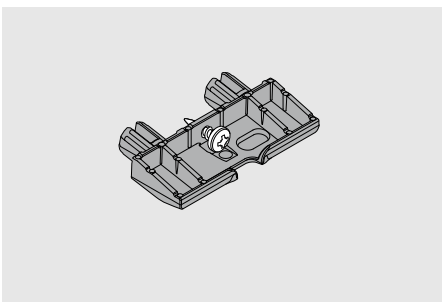

- For supporting the pull-out base
- For pull-outs over a cabinet base or cross member
- Required for cabinet widths KB of  $\geq 750$  mm
- Material: Nylon

#### Ordering information

##### Base support bracket

Cabinet width KB (mm)	Colour
$\geq 750$	R7037 dust grey
<b>Z96.2011</b>	

#### Space requirements in the cabinet

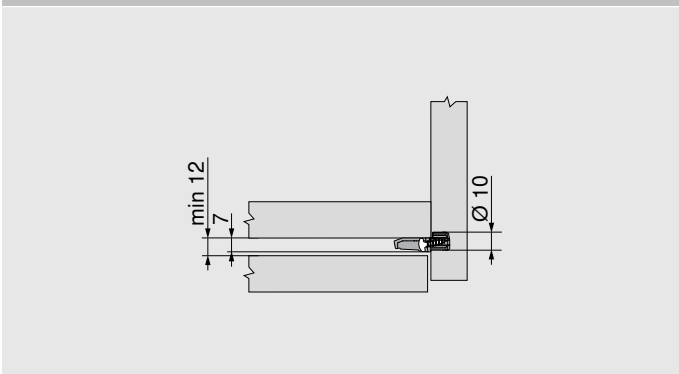

#### Space requirements in the cabinet

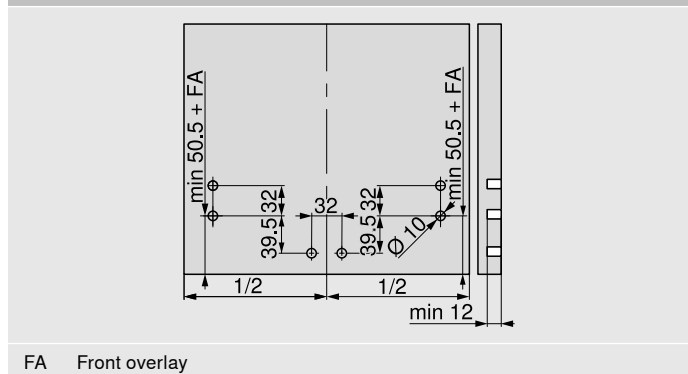

## TIP-ON BLUMOTION

## Front/base stabiliser

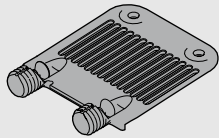

- For stabilising high fronts
- For supporting wide drawer bases
- Recommendation:
  - Front height FH < 300 mm:
    - Cabinet width KB > 900 mm: 1 pc
  - Front height FH ≥ 300 mm:
    - Cabinet width KB < 450 mm: 1 pc
    - Cabinet width KB ≥ 450 mm: 2 pcs

<b>Ordering information</b>	
<b>Front/base stabiliser</b>	
<b>Fixing method</b>	<b>Colour</b>
EXPANDO	R7037 dust grey
	<b>Z96.10E1</b>

## Planning

### Space requirements in the cabinet

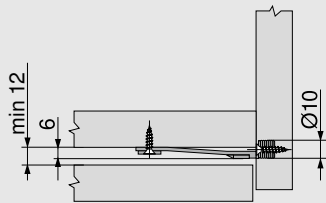

### Space requirements in the cabinet

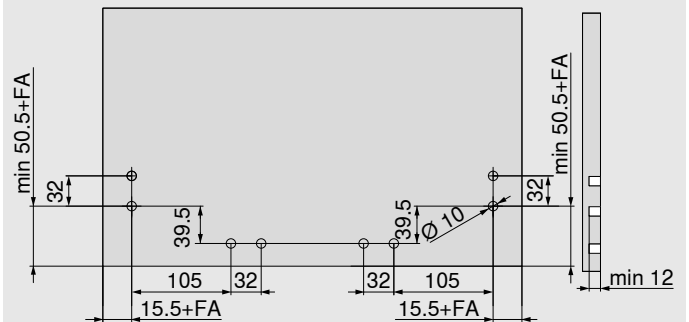

FA Front overlay



## Cabinet profile

### Cabinet profile fixing

#### Cabinet profile 578M – 30 kg

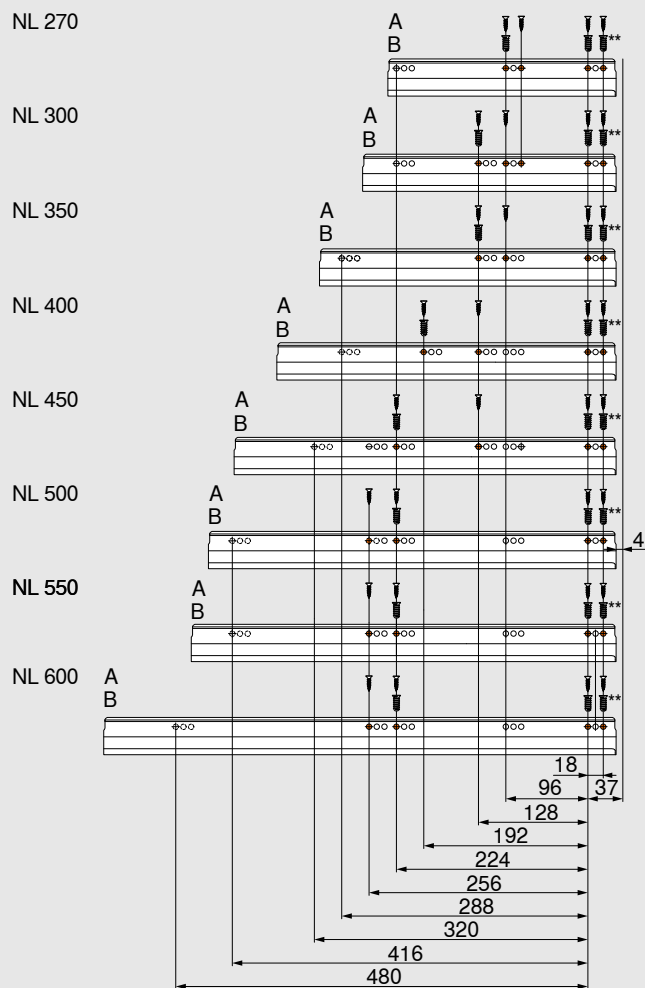

#### Cabinet profile 576M – 65 kg

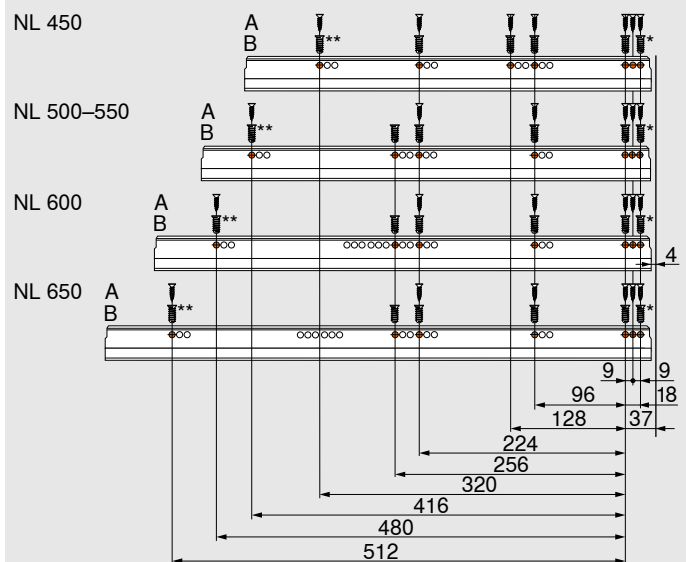

A Chipboard screw  
Ø 4 x 15 mm

B System screw  
part no. 661.1450.HG

\* Can be replaced with A

\*\* Optional for greater stability  
Can be replaced with A

## Steel back

Ordering information			
	Colour options	SW	R9006
		Steel	
	N drawer back	☎ Z30NxxxS.6	
	M drawer back	☎ Z30MxxxS.6	
	K drawer back	☎ Z30KxxxS.6	
	C drawer back	☎ Z30CxxxS.6	
	D drawer back	☎ Z30DxxxS.6	

## Calculation of width

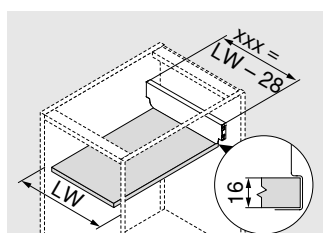

xxx Width  
LW Internal cabinet width

Example:

Internal cabinet width 567 mm - 28 mm = back width 539 mm

Order: **Z30M539S** in white

Cutting dimensions for 16 mm chipboard	
	<p><b>Base</b> NL - 22 mm</p> <p>LW Internal cabinet width NL Nominal length</p>

## Ordering information

Back fixing height B			
	Colour options	SW	WGR
		Steel	
		Z30B000S.04	

## Planning

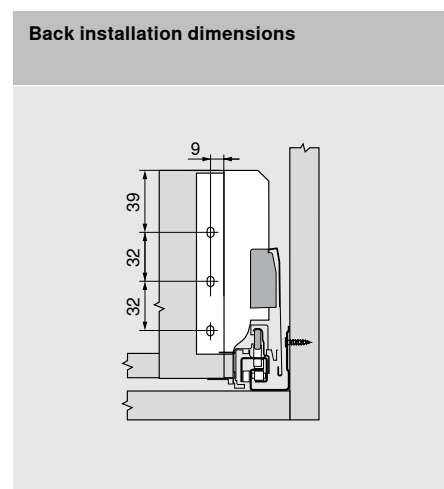
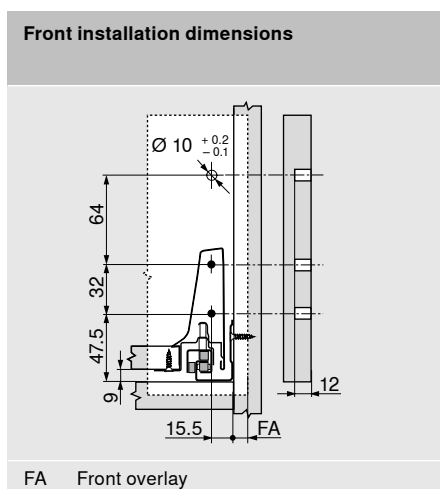
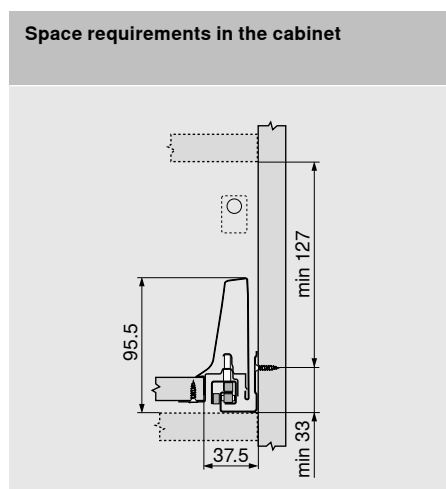

## Flexible gallery fixing

### Accessories – Flexible gallery fixing

Flexible gallery fixing			
	Colour options	SW	R9006
		Steel	
		ZRR.5200	

### Planning

Space requirements in the cabinet	Front installation dimensions	Back installation dimensions
<p>Free placement  <math>Y = X - 4 \text{ mm}</math>  X Back height</p>	<p>Free placement  <math>Z = X - 71 \text{ mm}</math>  X Back height  FA Front overlay</p>	<p>Free placement  <math>W = X - 103 \text{ mm}</math>  X Back height</p>

Space requirements in the cabinet	Front installation dimensions	Back installation dimensions
<p>Height D – double gallery  (back fixing height B)</p>	<p>Height D – double gallery  (back fixing height B)  FA Front overlay</p>	<p>Height D – double gallery  (back fixing height B)</p>

## Front/base stabiliser

### Front/base stabiliser

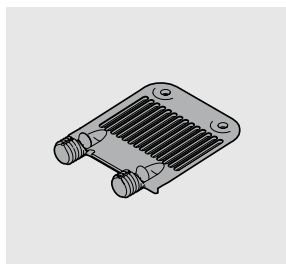

Ordering information	
Front/base stabiliser	
Fixing method	Colour
EXPANDO	R7037 dust grey
	<b>Z96.10E1</b>

- For stabilising high fronts
- For supporting wide drawer bases
- Recommendation:
  - Front height FH < 300 mm:
  - Cabinet width KB > 900 mm: 1 pc
  - Front height FH ≥ 300 mm:
  - Cabinet width KB < 450 mm: 1 pc
  - Cabinet width KB ≥ 450 mm: 2 pcs
  - Cabinet width KB > 900 mm: 3 pcs

## Planning

### Space requirements in the cabinet

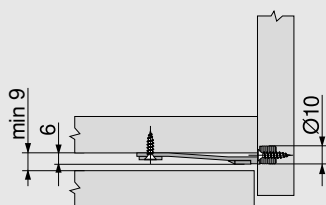

### Drilling distances – front

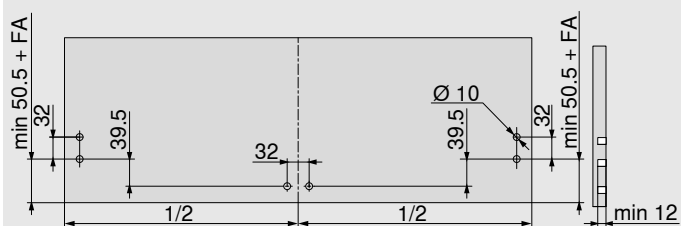

## Support bracket

### Support bracket



Steel

28 mm

**Z30A0008**

Used in combination with chipboard back. Same base cutting dimensions for chipboard and steel back.

### Cutting dimensions for 16 mm chipboard with support bracket

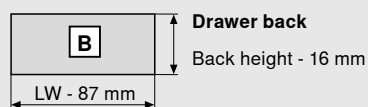
**Drawer back**

Back height - 16 mm

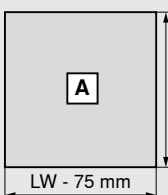
**Base**

Wood/steel back

NL - 22 mm

LW Internal cabinet width

NL Nominal length

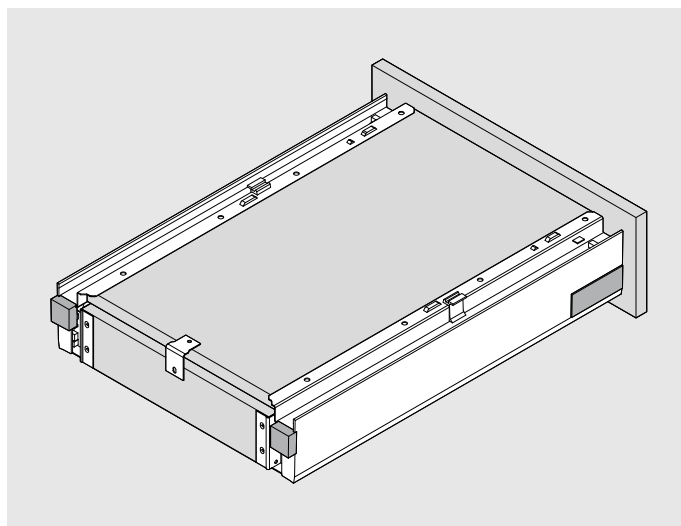



A full-page photograph of a modern, bright kitchen. In the foreground, a young girl with blonde hair sits on a black stool, looking towards the kitchen island. The island is a long, light-colored wooden counter with a man in a striped shirt and dark pants standing behind it, smiling and cooking. The kitchen has large windows, pendant lights, and a dining table with chairs in the background. The floor is made of light-colored wood in a herringbone pattern. The overall atmosphere is warm and inviting.

# moving ideas

We believe that ideas can move the world. We offer innovative fittings, inspiring furniture concepts and appropriate services so that you can turn your creative ideas into reality. We are driven by your needs, international trends and our shared vision of a better quality of living. Let us work together to create moving ideas.



## Quality of living

We would like you to enjoy greater convenience and functionality when using furniture.



## Product range

Everything from a single source: our wide range of products allows you to keep up with today's and tomorrow's trends.



## Inspiration

We monitor global trends and strive to create the solutions of tomorrow. We like to share our insights with you.



## Innovation

We stay in motion. Curiosity and pioneering spirit drive us to develop new products and services for you.



## Services

We support your daily operations with customised services tailored to your processes.



## Quality

We continuously strive to improve our products, services and ourselves.



## Trust

We take responsibility for partnerships, our employees, society and the environment.

Julius Blum started our journey in 1952 with horseshoe studs. Today we supply innovative fittings to customers in over 120 countries.

Julius Blum GmbH  
Furniture Fittings Mfg.  
6973 Höchst, Austria  
Tel.: +43 5578 705-0  
Fax: +43 5578 705-44  
E-mail: [info@blum.com](mailto:info@blum.com)  
[www.blum.com](http://www.blum.com)

Our sites in Austria, Poland and China are certified to the international standards mentioned below.  
Our site in the USA is certified to ISO 9001.  
Our site in Brazil is certified to ISO 9001, ISO 14001 and ISO 45001.



**ISO 9001**  
Certified Quality  
System



**ISO 14001**  
Certified Environmental  
System



**ISO 50001**  
Certified Energy  
System

 **blum**®



Look for our  
FSC®-certified  
products

All content is copyrighted by Blum.  
Subject to technical modifications and changes to the range without notice.  
IDNR: 583.799.2 · EP-568/1 EN-AL/07.22