

# COMPACT CLIP 31C and 30C series hinges

## Hinge removal

**STEP 1:** Locate CLIP release lever on back of hinge(A) and press down to release(B).

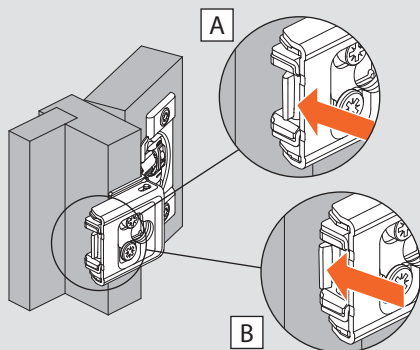

**STEP 2:** While the CLIP lever is released, pull forward on hinge to remove from cabinet.

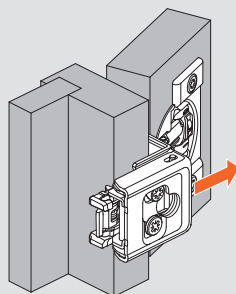

## Hinge attachment

**STEP 1:** Slide hinge onto CLIP plate until hinge clips in place.

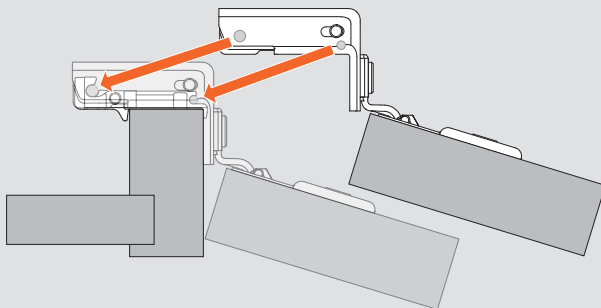

# COMPACT CLIP 31C and 30C series hinges

## Cam Side Adjustment

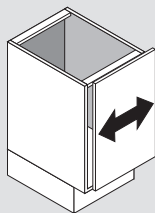

Rotate front cam screw to increase or decrease door overlay.

Range =  $\pm 1.5$  (1/16")

Full overlay

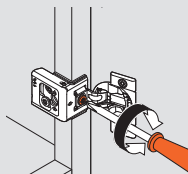

Partial overlay

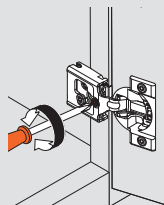

## Cam Height Adjustment

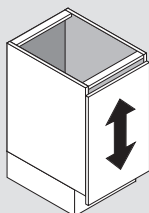

Rotate cam screw to increase or decrease door height.

Range =  $\pm 2$  (5/64")

Full overlay

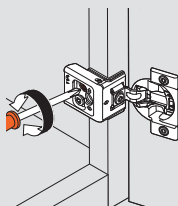

Partial overlay

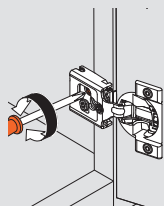

## Cam Depth Adjustment

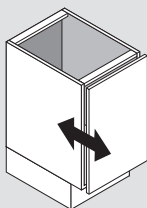

Rotate cam screw to adjust door gap.

Range =  
+ 2.5 (3/32")  
- 1 (1/32")

Full overlay

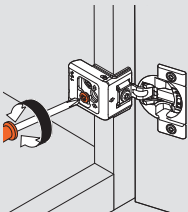

Partial overlay

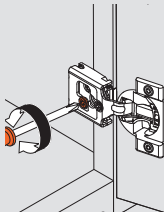

## COMPACT BLUMOTION deactivation switch on the hinge cup

For small or light doors, the BLUMOTION can be deactivated on one of the hinges. Door must be closed once for deactivation to be complete. To reactivate, move the switch back to original position.

